



****AVAILABLE AUGUST 2024**** ****£130pppw**** ****FURNISHED**** An exceptional, purpose built end-terrace ground floor flat, located on Glenthorn Road, West Jesmond. This superb lower Tyneside flat offers modern fixtures, fittings & furniture throughout and is in a great location, within striking distance of West Jesmond Metro station and a choice of shops, bars and restaurants!



The accommodation briefly comprises an entrance hall with storage cupboard; three double bedrooms, all a fair size, different to the usual Tyneside flat layout; open plan reception including a lounge and modern fitted kitchen with appliances; to the rear there is a plush shower room WC. Externally there is a private turfed rear yard. Fully furnished with gas central heating and double glazed windows throughout, this is an ideal property for either student or professional sharers.

Available 19th August 2024 | £130pppw/
 £1,690pcm | Purpose Built Ground Floor
 Tyneside Flat | End Terrace | 880 Sq. ft
 (81.8 m2) | Furnished | Three Double
 Bedrooms | Open Plan Reception | Lounge
 | Modern Kitchen | Plush Bathroom WC |
 Great Location | Close Proximity To West
 Jesmond Metro Station | Permit Parking |
 GCH & DG | Council Tax Band: B | EPC
 Rating: D

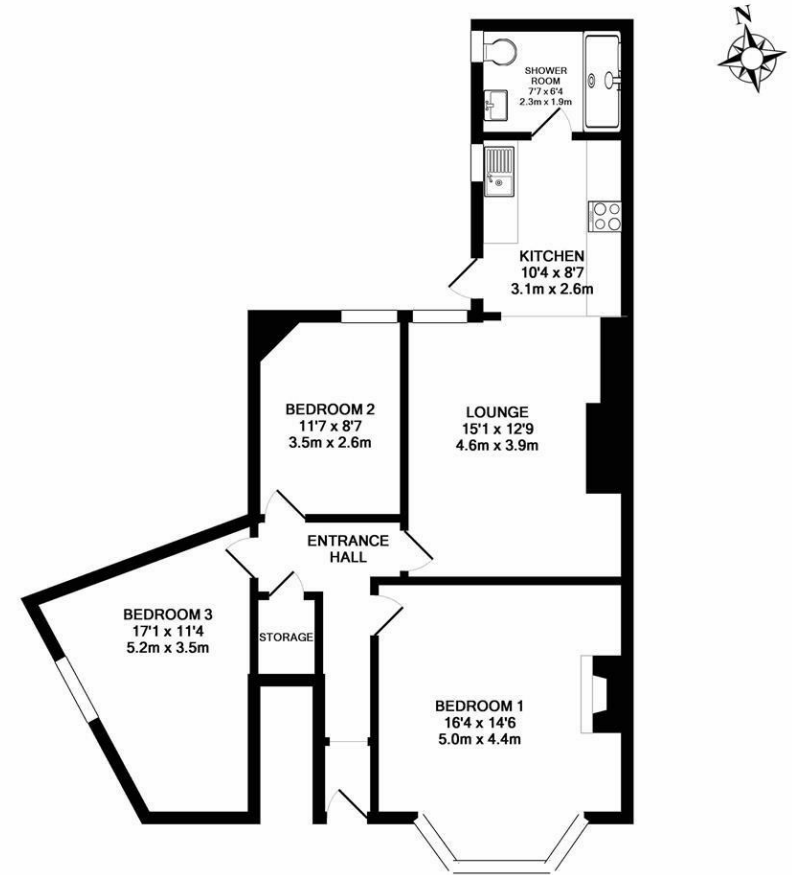

TOTAL APPROX. FLOOR AREA 880 SQ.FT. (81.8 SQ.M.)

Whilst every attempt has been made to ensure the accuracy of the floor plan contained here, measurements of doors, windows, rooms and any other items are approximate and no responsibility is taken for any error, omission, or mis-statement. This plan is for illustrative purposes only and should be used as such by any prospective purchaser. The services, systems and appliances shown have not been tested and no guarantee as to their operability or efficiency can be given
 Made with Metropix ©2018

£1,690 PCM

Misrepresentation Act 1967. These particulars and the descriptions and measurements herein do not constitute representation and whilst every effort has been made to ensure accuracy, this cannot be guaranteed.

