

**\*\*AVAILABLE MAY 2024\*\***

**\*\*PANORAMIC VIEWS\*\* \*\*GARAGE\*\***

**\*\*FURNISHED\*\*** A wonderful purpose built property, found in prestigious Jesmond Park East. Dene Court, a stylish top floor apartment boasts two double bedrooms, an open plan lounge/ kitchen diner with stunning treetop views, lift access to all floors and even the use of a separate garage!



Accessed via a secure telephone entry system and lift access to the top floor, the accommodation boasts an entrance hallway leading to; open plan lounge/ kitchen diner with panoramic views of Jesmond Park East and Newcastle city; a stylish re-fitted bathroom, fully tiled with three piece suite; two double bedrooms both similar in size. Fully furnished to a very good standard. Externally there are communal gardens and off street parking as well as the use of a garage in a separate block. Perfect for either a couple of professional sharers alike, an internal inspection is absolutely vital to appreciate everything that's on offer in this fantastic 1960's apartment!

Available 13th May 2024 | £1,100pcm | Stylish Top Floor Apartment | Panoramic Views | Two Double Bedrooms | 735 Sq. Ft. (68.3m<sup>2</sup>) | Lift Access | Open Plan Lounge/ Kitchen Diner | Fully Furnished | Sought After Location | Off Street Parking | Garage | GCH & DG | Professional Let | Council Tax Band: C | EPC Rating: E

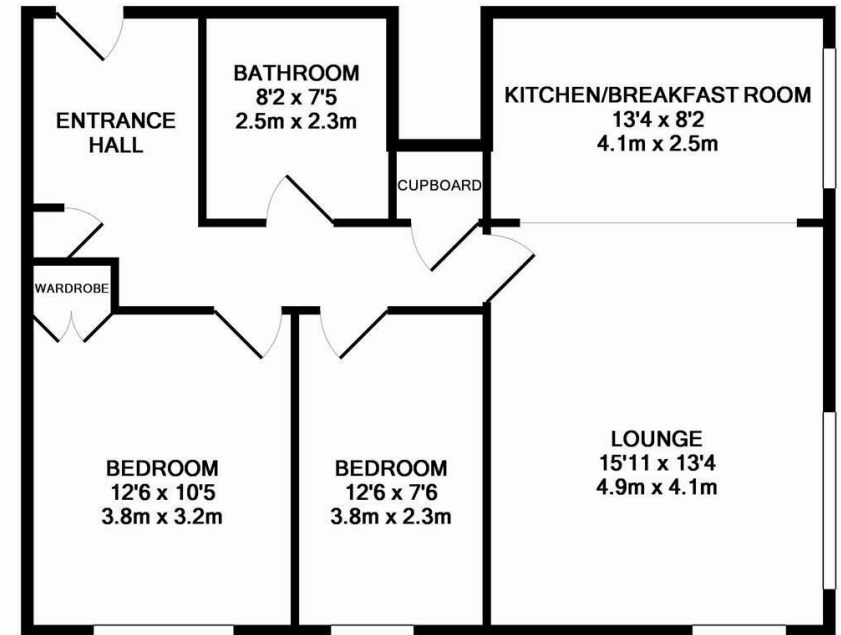

TOTAL APPROX. FLOOR AREA 735 SQ.FT. (68.3 SQ.M.)

Whilst every attempt has been made to ensure the accuracy of the floor plan contained here, measurements of doors, windows, rooms and any other items are approximate and no responsibility is taken for any error, omission, or mis-statement. This plan is for illustrative purposes only and should be used as such by any prospective purchaser. The services, systems and appliances shown have not been tested and no guarantee as to their operability or efficiency can be given  
Made with Metropix ©2014

**£1,100 PCM**

Misrepresentation Act 1967. These particulars and the descriptions and measurements herein do not constitute representation and whilst every effort has been made to ensure accuracy, this cannot be guaranteed.

