



Priced to reflect updating and offered to the market with no onward chain! This lower 'Tyneside' flat is ideally located on Whitefield Terrace, Heaton. Close to the cafes, shops and restaurants of Chillingham Road, parks at both Iris Brickfield and Heaton Park. Whitefield Terrace also provides good transport links to the City Centre and beyond.

The accommodation briefly comprises: entrance lobby through to hallway; lounge diner with part fitted alcove storage; kitchen with fitted units, work surfaces and side door access to the yard; bathroom with three piece suite and separate storage; two double bedrooms, bedroom one with walk in bay and bedroom two with dual windows and fitted storage cupboard. Externally, a rear yard with wall boundaries. Offered to the market with no onward chain, early viewings are advised.

** This property could be sold individually, or as a pair alongside the upper floor flat **

Ground Floor 'Tyneside' Flat | Priced to Reflect Updating | 853 Sq ft (79.2m²) | Two Bedrooms | Lounge Diner | Kitchen | Bathroom | Rear Yard | No Onward Chain | Freehold (title to be split by the current owner) | Council Tax Band A | EPC: D

Offers Over £130,000

Misrepresentation Act 1967. These particulars and the descriptions and measurements herein do not constitute representation and whilst every effort has been made to ensure accuracy, this cannot be guaranteed.

GROUND FLOOR
853 sq.ft. (79.2 sq.m.) approx.

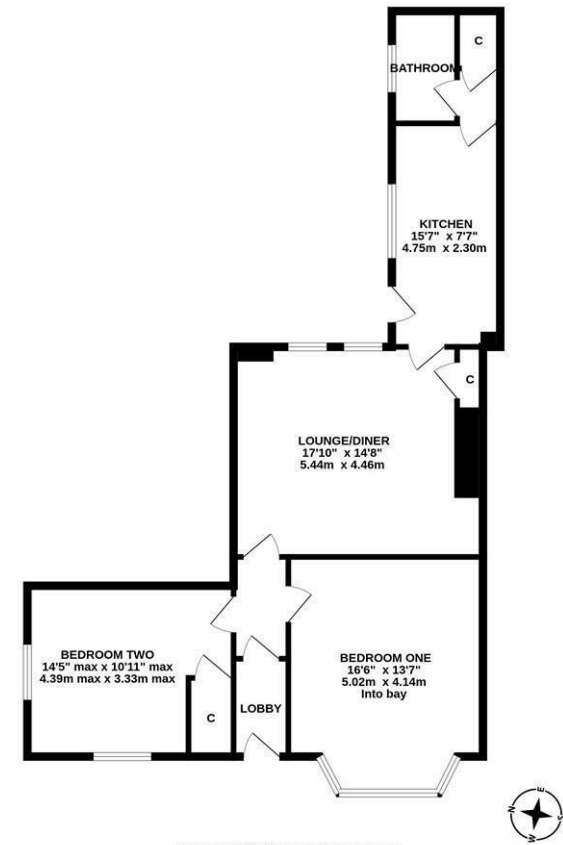

TOTAL FLOOR AREA : 853 sq.ft. (79.2 sq.m.) approx.
Whilst every attempt has been made to ensure the accuracy of the floorplan contained here, measurements of doors, windows, rooms and any other items are approximate and no responsibility is taken for any error, omission or mis-statement. This plan is for illustrative purposes only and should be used as such by any prospective purchaser. The services, systems and appliances shown have not been tested and no guarantee as to their operability or efficiency can be given.
Made with Metropix ©2024

