

This two bedroom, second floor apartment ideally located at Monkridge Court, South Gosforth. Within striking distance of South Gosforth 1st School, Monkridge Court is perfectly placed within walking distance to South Gosforth, the local shops of South Gosforth, transport links including South Gosforth Metro as well as the restaurants, cafés and shops of Gosforth High Street.



The accommodation briefly comprises: communal entrance with secure key pad entry system, through to communal entrance hall with stairs to all floors; private entrance hall with fitted storage cupboard; lounge diner measuring close to 16ft; kitchen with fitted units and hardwood work surfaces; shower room complete with three piece suite; two bedrooms, both measuring 12ft with fitted wardrobe storage. Externally, a single garage providing storage/off-street parking, positioned in a popular location, early viewings are advised.

2nd Floor Apartment | Two Bedrooms | 677 Sq ft (62.9m2) | Lounge Diner | Kitchen | Shower Room | Garage | Popular Location | Close to Transport Links | Leasehold with 148 Years Remaining | Service Charge £1,095.20 | Council Tax Band A | EPC: D

GROUND FLOOR
131 sq.ft. (12.1 sq.m.) approx.

SECOND FLOOR
547 sq.ft. (50.8 sq.m.) approx.

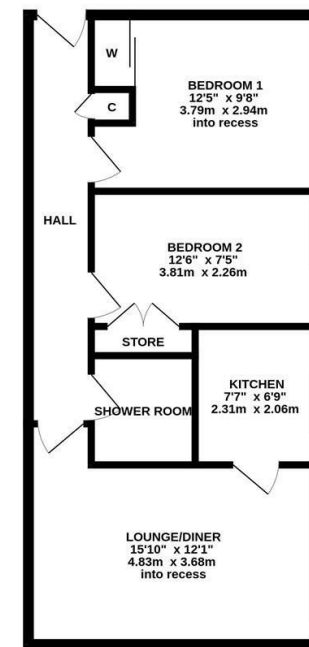
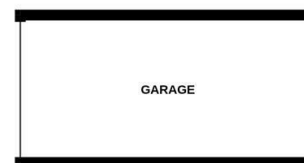

TOTAL FLOOR AREA: 677 sq.ft. (62.9 sq.m.) approx.

Whilst every attempt has been made to ensure the accuracy of the floorplan contained here, measurements of doors, windows, rooms and any other items are approximate and no responsibility is taken for any error, omission or mis-statement. This plan is for illustrative purposes only and should be used as such by any prospective purchaser. The services, systems and appliances shown have not been tested and no guarantee as to their operability or efficiency can be given.
Made with Metropix ©2014

Offers Over £100,000

Misrepresentation Act 1967. These particulars and the descriptions and measurements herein do not constitute representation and whilst every effort has been made to ensure accuracy, this cannot be guaranteed.

