



81 Black Prince Road, Vauxhall
London SE1

GARTON JONES.COM



81 Black Prince Road, Vauxhall
London, SE1

GARTON JONES.COM

9 Albert
Embankment
London
SE1 7SP

Sales +44 (0) 20 7735 1888
nineelms@gartonjones.com
www.gartonjones.com

£730,000 Leasehold

A 2 bedroom dual aspect apartment of 595sq.ft (55.3sq.m) in Telford Homes Parliament House development. Completed in March 2015, this 10th floor (with lift) luxury property offers stunning views of the city skyline plus you can also see the river and Houses of Parliament. There is a guest bathroom, an en-suite shower to the master bedroom, an open plan reception room, smart integrated kitchen, balcony and storage. Residents also enjoy a concierge service, exclusive resident's gymnasium and designer interiors. Parliament House is a 23 storey tower within easy reach of the excellent transport services of Vauxhall and London's trendy South Bank.

Lease: 999 Years
Estimated Service Charge: £3.20psf - year 1
Ground Rent: £450pa

- 595sq.ft (55.3sq.m)
- 10th Floor (with lift)
- 2 Bedrooms
- Luxury Bathroom
- En-Suite Shower
- Open Plan Reception Room & Smart Integrated Kitchen
- Balcony
- Westminster & River Thames Views
- Storage
- Close to Local Shopping Facilities



EPC certificate available on request.

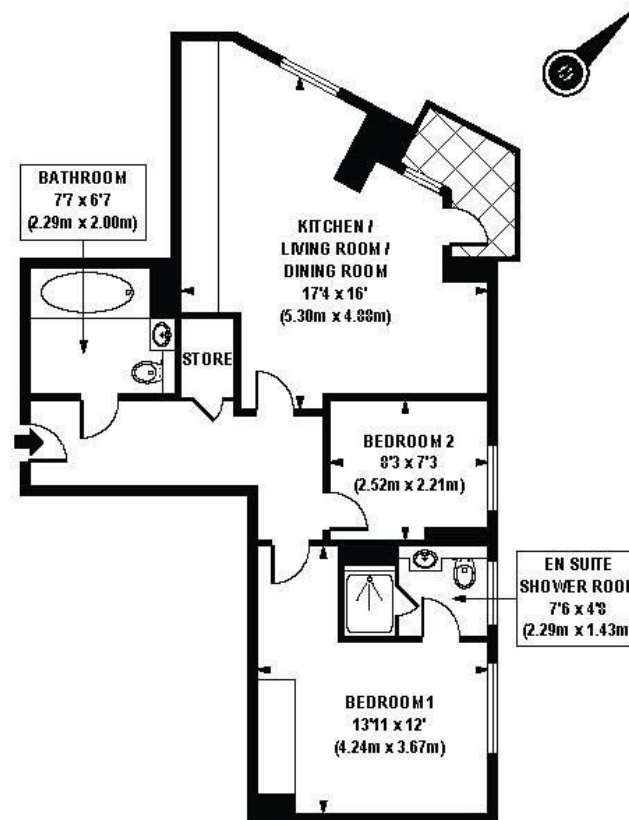

TENTH FLOOR

APPROX. GROSS INTERNAL FLOOR AREA 595 sq. ft / 55.30 sq. m

