



2 Riverlight Quay, London
SW11

GARTONJONES.COM



2 Riverlight Quay, London , SW11

GARTON JONES.COM

9 Albert
Embankment
London
SE1 7SP

Sales +44 (0) 20 7735 1888
nineelms@gartonjones.com
www.gartonjones.com

£655 Per Week

A 1-bedroom apartment of 543sq.ft (50.4sq.m) available to rent in 2 Riverlight Quay, a popular riverside development in the heart of Nine Elms and on the banks of the River Thames. This fantastic 1-bed apartment comprises a spacious bedroom with built-in wardrobes, a luxury bathroom suite, an open plan, dual aspect reception room with full height floor to ceiling windows, balcony, a smart integrated kitchen, good storage throughout and benefits from comfort cooling.

Residents of Riverlight Quay benefit from exclusive facilities to include a fantastic Heated Swimming Pool, Jacuzzi, Sauna and Steam Room as well as a well-equipped mezzanine "river view" Gymnasium. There is also a reception lounge and library, 24-hour concierge and a private cinema screening room and virtual golf room. The on-site amenities include the Black Cab Coffee Co, Nine Elms Tavern and Waitrose supermarket and there are plenty of nearby new restaurants and bars adding to the increasing vibrancy of Nine Elms. Nine Elms Tube Station and Battersea Power Station Northern Line tube stops are both a short walk away from Riverlight Quay.

Please note furniture may differ to that shown in the current photos.

- Electricity Supply — Mains | Water Supply — Mains | Sewerage — Mains | Heating — Comfort Cooling
- Broadband & Mobile Signal : Check Coverage via Ofcom
- No Parking
- Lift Access
- Building Safety: EWS1 Available on Request
- Council Tax Band E (London Borough of Wandsworth)
- 5 Week Security Deposit
- Holding deposit equivalent to 1 week of rent
- Rent to be payable monthly in advance
- EPC Rating C (80)

EPC certificate available on request.

- 1 Bedroom
- 543sq.ft (50.4sq.m)
- Bathroom
- Open Plan Reception Room
- Balcony
- South West Aspect
- 24 Hour Concierge
- Residents Gym
- Swimming Pool, Spa & Sauna Facilities
- 0.3 Miles from Battersea Power Station Tube



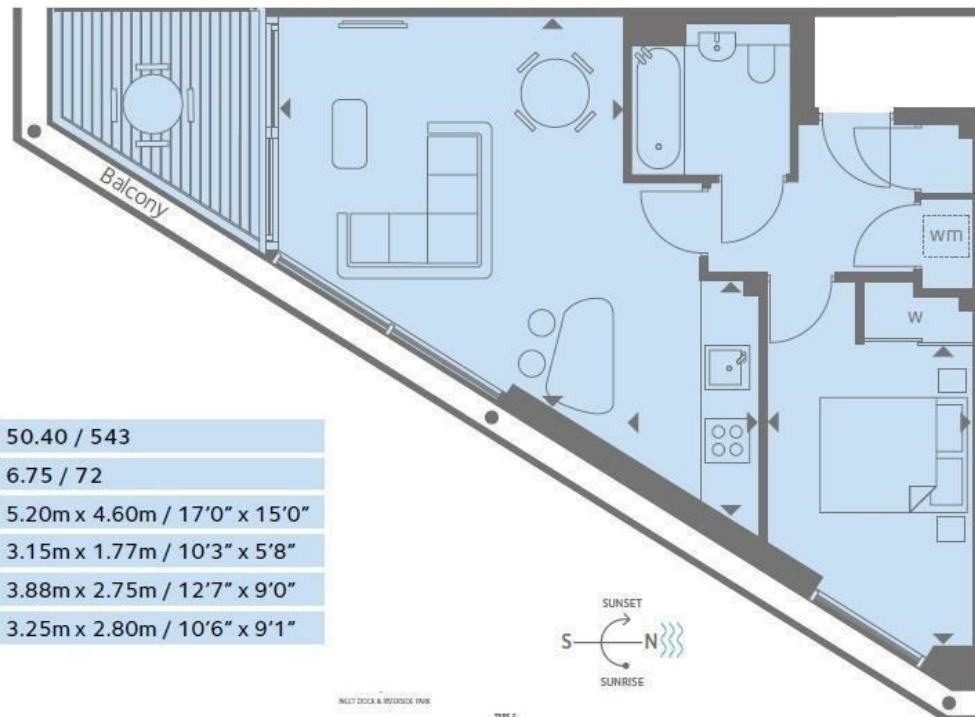

INTERNAL AREA M ² / SQ FT	50.40 / 543
EXTERNAL AREA M ² / SQ FT	6.75 / 72
Living / Dining	5.20m x 4.60m / 17'0" x 15'0"
Kitchen	3.15m x 1.77m / 10'3" x 5'8"
Bedroom	3.88m x 2.75m / 12'7" x 9'0"
Balcony	3.25m x 2.80m / 10'6" x 9'1"

