



9 Albert Embankment, London
SE1

GARTON JONES.COM



9 Albert Embankment, London , SE1

GARTON JONES.COM

9 Albert
Embankment
London
SE1 7SP

Sales +44 (0) 20 7735 1888
nineelms@gartonjones.com
www.gartonjones.com

£525 Per Week

A fantastic 1-bedroom apartment of 565 sq. ft / 52.50 sq. m) available to rent on the 10th floor of 9 Albert Embankment, SE1, a popular riverside residential development by Berkeley Homes. This charming property boasts a cosy open plan reception room that features a glass partition to enable you to separate the room from a modern integrated kitchen, a well-proportioned bedroom with built-in storage, access to a balcony from both the bedroom & reception, a modern bathroom suite and additional storage room.

Residents of 9 Albert Embankment have the added benefit of a 24-hour concierge and an on-site convenience store, and situated in a prime location, this property provides easy access to all the amenities and attractions that London has to offer. Transport links are very good with Vauxhall, Waterloo and Westminster Rail and Tube services all within a reasonable walking distance.

Please note furniture may differ to that shown in the current photos.

- 1 Bedroom
- 565 sq. ft / 52.50 sq. m
- Bathroom
- Balcony
- Parking Available via Separate Agreement
- Modern Kitchen
- Good Storage
- 24 Hour Concierge
- On-Site Convenience Store
- 0.5 Miles to Vauxhall Station



EPC certificate available on request.

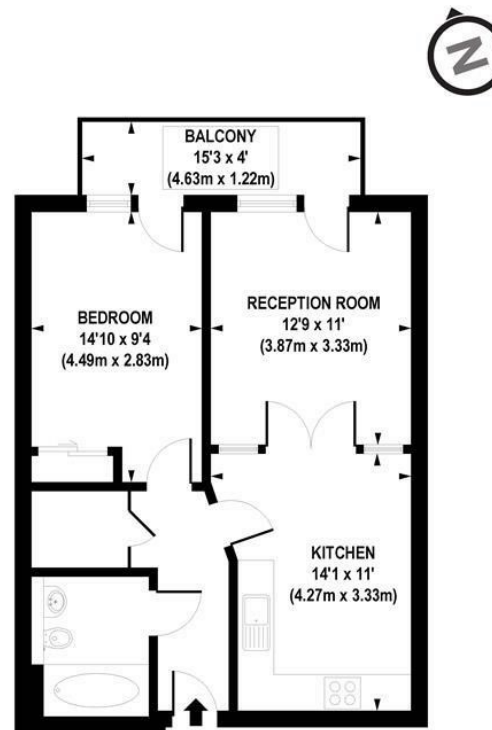

APPROX. GROSS INTERNAL FLOOR AREA 565 sq. ft / 52.50 sq. m

Floorplan is for illustrative purposes only and is not to scale.
Every attempt has been made to ensure the accuracy of the floorplan shown, however all measurements, fixtures, fittings and data shown are an approximate interpretation for illustrative purposes only.
Liability for errors, omissions or mis-statement through negligence or otherwise is hereby excluded.

CP CREATIVE
PROPERTY MARKETING

