



3 Riverlight Quay, London
SW11

GARTON JONES.COM



3 Riverlight Quay, London , SW11

GARTON JONES.COM

9 Albert
Embankment
London
SE1 7SP

Sales +44 (0) 20 7735 1888
nineelms@gartonjones.com
www.gartonjones.com

£650,000 Leasehold

A stunning 10th floor 1-bedroom apartment of 535sq.ft (49.7sq.m.) in Riverlight Quay, a popular residential development set in the heart of Nine Elms on the banks of the River Thames. The property benefits from a spacious open plan reception room with a smart integrated kitchen, floor to ceiling windows throughout offering plenty of natural light, a luxury bathroom suite and a large balcony overlooking communal gardens. Close to Battersea Power Station, Riverlight offers residents the exclusive use of a health spa with a well-equipped “river view” gymnasium as well as a swimming pool, Jacuzzi, sauna, steam room and treatment room as well as a library / lounge, virtual golf & a cinema screening room.

The onsite amenities include the Black Cab Coffee & the Nine Elms Tavern as well as being moments away from the vibrant restaurants and bars nearby at Embassy Gardens & Battersea Power Station. Riverlight is conveniently located a short walk from both Nine Elms Tube Station & Battersea Power Station Northern Line Extensions.

Please note furniture may differ to that shown in the current photos.

EPC certificate available on request.

- 1 Bedroom
- 535sq.ft (49.71sq.m)
- 10th Floor
- Luxury Bathroom Suite
- 24 Hour Concierge
- Swimming Pool & Spa Facilities
- Balcony
- Residents Gym
- Virtual Golf & Cinema Screening Room
- 0.2 Miles to Battersea Power Station Tube

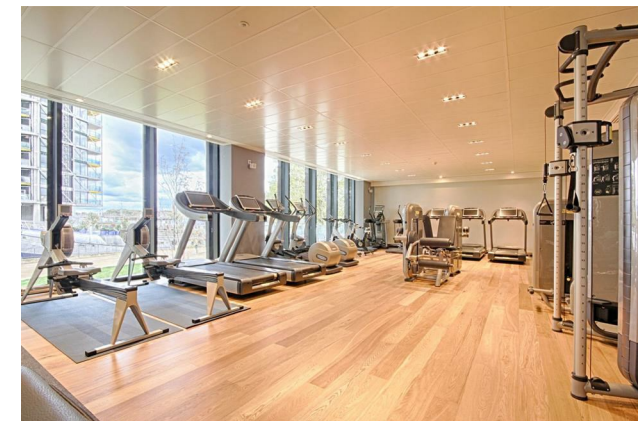

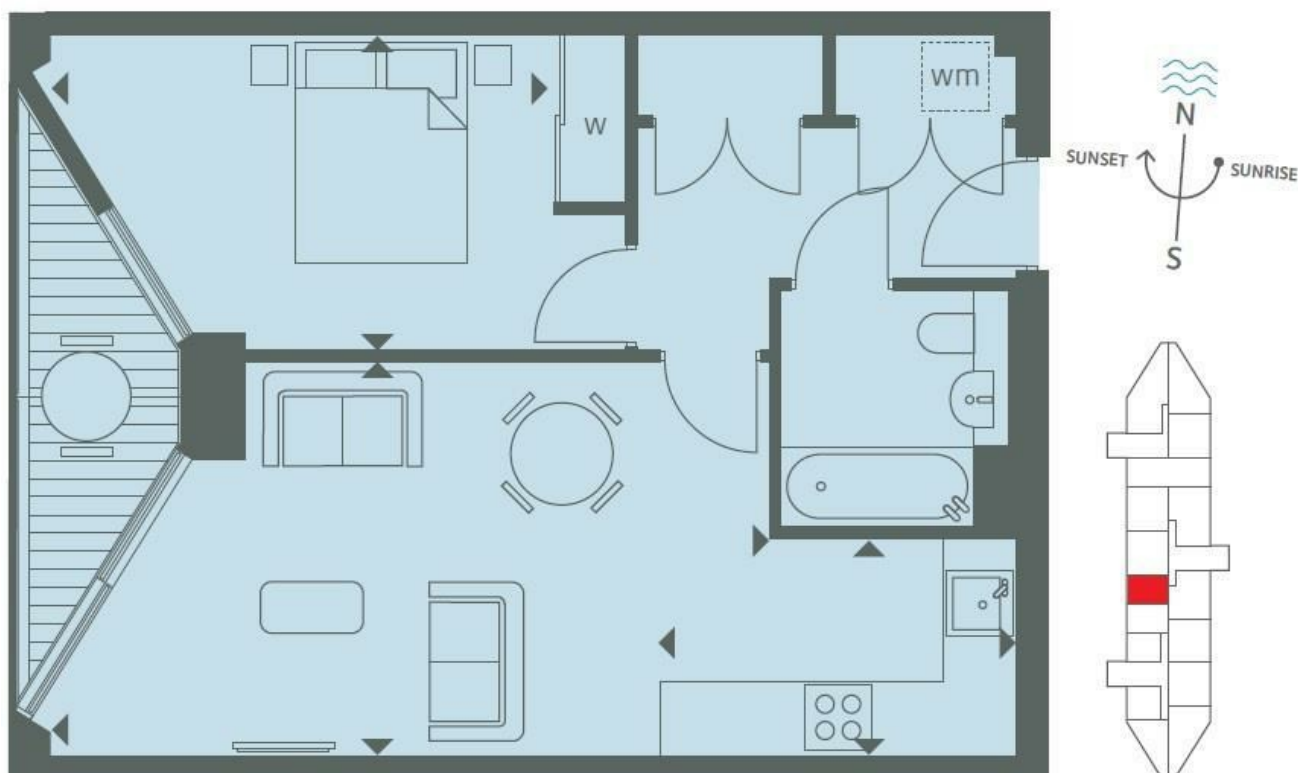

APARTMENT NUMBER	158
LEVEL	10
INTERNAL AREA M ² / SQ FT	49.71 / 535
EXTERNAL AREA M ² / SQ FT	4.84 / 52.1
Living / Dining	6.33m x 3.46m / 20'8" x 11'4"
Kitchen	3.14m x 1.91m / 10'3" x 6'3"
Bedroom 1	4.42m x 2.76m / 14'5" x 9'1"
Balcony	5.46m x 1.50m / 17'9" x 4'9"

