

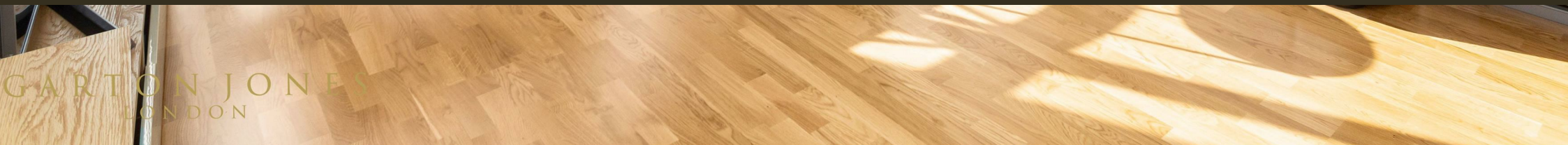

45 Wellington Street, London
SE18

GARTONJONES.COM



GARTON JONES
LONDON

45 Wellington Street, London
, SE18

GARTON JONES.COM

9 Albert
Embankment
London
SE1 7SP

Lettings:
+44 (0) 20 7735 1888
nineelms@gartonjones.com
www.gartonjones.com

£500 Per Week

Situated within a modern development just moments from all the local shops and restaurants is this contemporary 1 double bedroom apartment of 582sq.ft (54sq.m), Golding Lodge is a popular residential development a short walk from Woolwich station. This well-presented property offers stylish living space with an integrated kitchen, a good-sized open plan reception room opening onto a generous balcony, double bedroom with fitted wardrobes, wood flooring, good storage, and a luxury bathroom suite. This property with its prime location benefits from easy access into the city with Woolwich Station offering the Elizabeth Line providing quick transport across London.

Please note furniture may differ to that shown in the current photos.

- Electricity Supply — Mains | Water Supply — Mains | Sewerage — Mains | Heating — Central Heating
- Broadband & Mobile Signal : Check Coverage via Ofcom
- Parking: No Parking Included
- Lift Access
- Building Safety: EWS1 Available on Request
- Council Tax Band C (London Borough of Greenwich)
- 5 Week Security Deposit
- Holding deposit equivalent to 1 week of rent
- Rent to be payable monthly in advance
- EPC Rating B (85)

- 1 Bedroom
- 582sq.ft (54sq.m)
- Bathroom
- Open Plan Reception Room
- Modern Kitchen
- East Facing Aspect
- Balcony
- Lift
- Central Location Close to Shops, Bars & Restaurants
- 0.3 Miles from Woolwich Arsenal Station



Golding Lodge

Approximate Gross Internal Area = 582 sq ft / 54.1 sq m

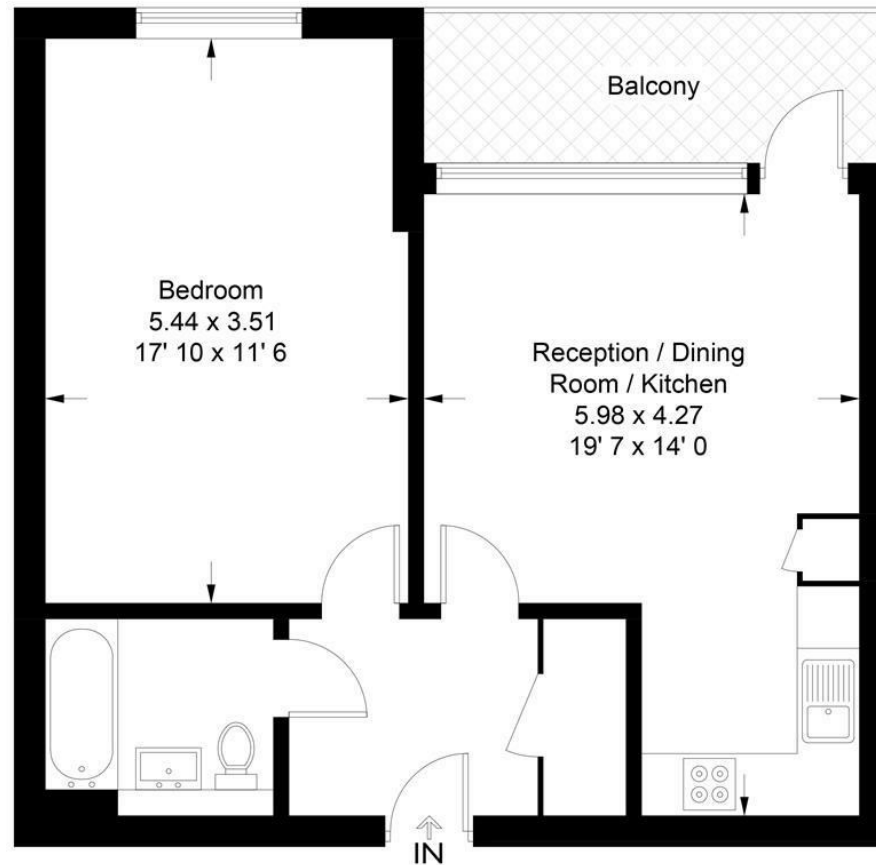

Not to scale, for guidance only and must not be relied upon as a statement of fact
All measurements and areas are approximate only and have been prepared in
accordance with the current edition of the RICS Code of Measuring Practice

