

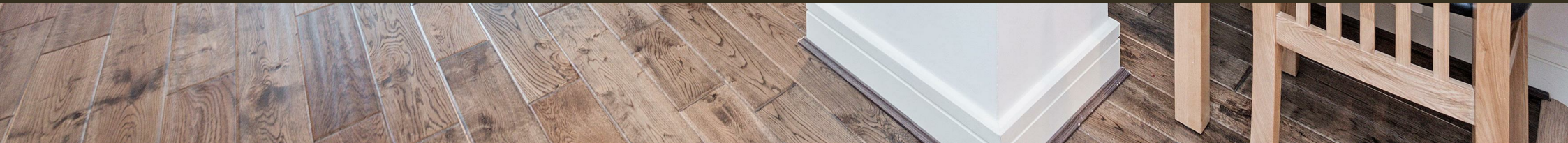

9 Albert Embankment, London  
SE1

GARTONJONES.COM



# 9 Albert Embankment, London , SE1

## £495 Per Week

A well-presented 1-bedroom offering 504sq.ft (46.8sq.m) available to rent on the 1st floor (with lift) of 9 Albert Embankment, a modern riverside development by Berkeley Homes located between Vauxhall & Lambeth Bridges. The living space of this furnished property consists of 1 double bedroom with a spacious walk-in wardrobe, an open plan reception room with a modern recently renovated integrated kitchen, and bathroom. Residents of 9 Albert Embankment benefit from a dedicated 24-hour concierge service, lift access and an on-site convenience store. Transport links are excellent with the rail and tube services of Vauxhall only moments away and a frequent bus service to the West End and City on the doorstep.

Please note furniture may differ to that shown in the current photos.

- Electricity Supply — Mains | Water Supply — Mains | Sewerage — Mains | Heating — Electric Radiators
- Broadband & Mobile Signal : Check Coverage via Ofcom
- Parking: No Parking Included
- Lift Access
- Building Safety: EWS1 Available on Request
- Council Tax Band E (London Borough of Lambeth)
- 5 Week Security Deposit
- Holding deposit equivalent to 1 week of rent
- Rent to be payable monthly in advance
- EPC Rating B (81)

- 1 Bedroom
- 504sq.ft (46.8sq.m)
- Bathroom
- Open Plan Reception
- Modern Integrated Kitchen
- Walk-in Wardrobe
- 24 Hour Concierge
- Lift
- On-Site Convenience Store
- 0.5 Miles to Vauxhall Station

## GARTON JONES.COM

9 Albert  
Embankment  
London  
SE1 7SP

Lettings:  
+44 (0) 20 7735 1888  
nineelms@gartonjones.com  
www.gartonjones.com



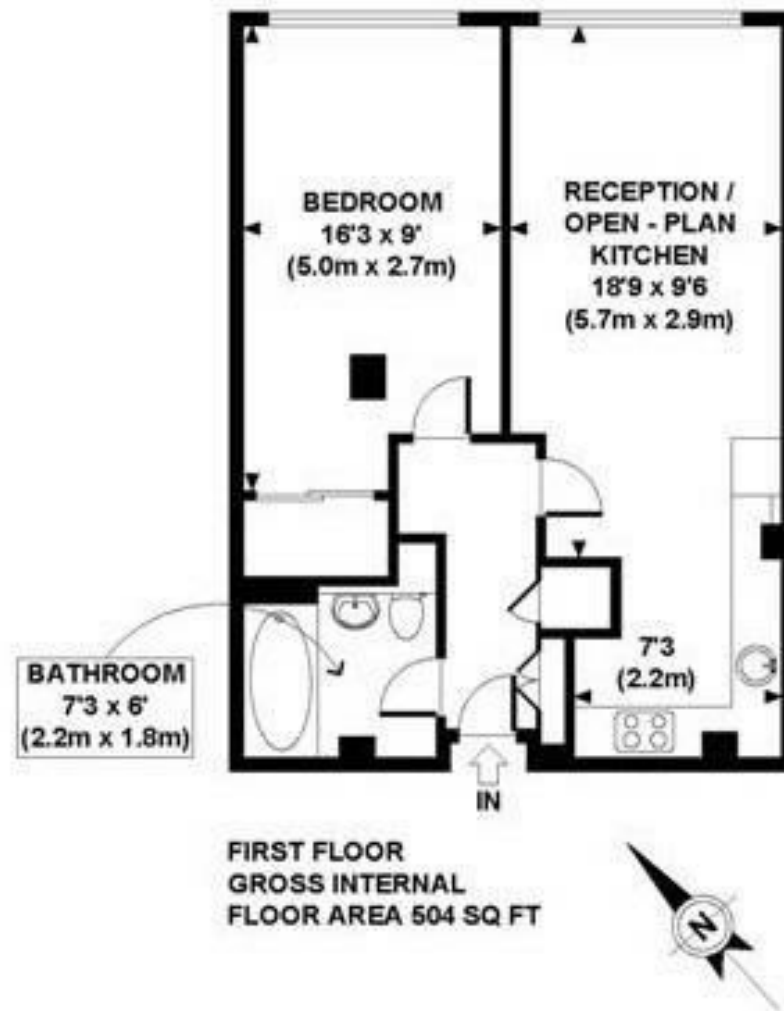

FIRST FLOOR  
GROSS INTERNAL  
FLOOR AREA 504 SQ FT

APPROX. GROSS INTERNAL FLOOR AREA 504 SQ FT / 47 SQ M



