



3 Riverlight Quay, London
SW11

GARTON JONES.COM



3 Riverlight Quay, London , SW11

GARTON JONES.COM

9 Albert
Embankment
London
SE1 7SP

Sales +44 (0) 20 7735 1888
nineelms@gartonjones.com
www.gartonjones.com

£1,500 Per Week

A truly stunning 3-bedroom apartment offering 1099 sq. ft (102.07 sq. m) available to rent in Riverlight Quay, a popular residential development by St James, Berkeley Homes, located on the banks of the River Thames and in the heart of Nine Elms. Offering direct, unrivalled views of the River Thames, the apartment is thoughtfully designed and benefits from 3-bedrooms, 2 luxury bathrooms (1 en-suite), a dual aspect open plan reception room with full height floor to ceiling windows, 2 balconies, a smart integrated kitchen, storage, and a utility cupboard.

Residents of Riverlight Quay have the use of a 24-hour concierge, a residents health spa with a well-equipped "river view" gymnasium, a heated swimming pool with steam room, sauna, and a Jacuzzi, as well as a cinema screening room and virtual golf facility. The on-site amenities include the Black Cab Coffee Co, Nine Elms Tavern, and Sainsbury's. There is also a Waitrose supermarket at Embassy Gardens, opposite, and you will also be within easy reach of other local shops and restaurants forming the Nine Elms regeneration with both Nine Elms & Battersea Power Station Tube Stations on your doorstep.

Please note furniture may differ to that shown in the current photos.

- Electricity Supply — Mains | Water Supply — Mains | Sewerage — Mains | Heating — Comfort Cooling
- Broadband & Mobile Signal : Check Coverage via Ofcom
- Parking: Secure Right to Park Included
- Lift Access
- Building Safety: EWS1 Available on Request
- Council Tax Band G (London Borough of Wandsworth)
- 5 Week Security Deposit
- Holding deposit equivalent to 1 week of rent
- Rent to be payable monthly in advance
- EPC Rating B (86)

- 3 Bedrooms
- 1099 sq. ft (102.07 sq. m)
- 2 Bathrooms (1 En-Suite)
- Open Plan Reception
- Modern Integrated Kitchen
- Balcony
- Views of the River Thames
- Residents Gym
- Swimming Pool & Spa Facilities
- 0.3 Miles to Battersea Power Station Tube



EPC certificate available on request.

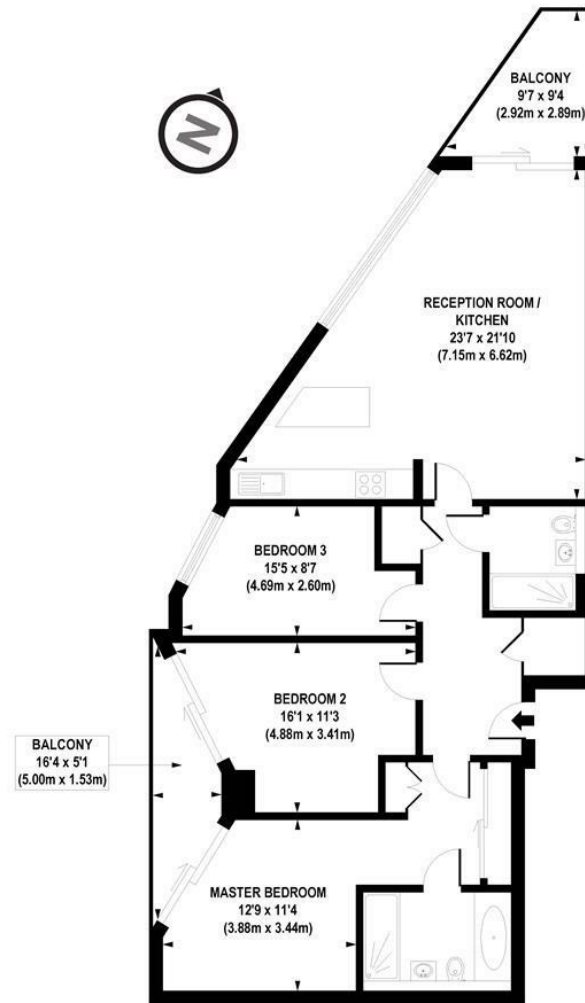

APPROX. GROSS INTERNAL FLOOR AREA 1099 sq. ft / 102.07 sq. m

Floorplan is for illustrative purposes only and is not to scale.
Every attempt has been made to ensure the accuracy of the floorplan shown, however all measurements, fixtures, fittings and data shown are an approximate interpretation for illustrative purposes only.
Liability for errors, omissions or mis-statement through negligence or otherwise is hereby excluded.

CP CREATIVE
PROPERTY MARKETING

