



1 Riverlight Quay, London
SW11

GARTONJONES.COM

1 Riverlight Quay, London , SW11

£900 Per Week

A direct river facing apartment, comprising 2-bedrooms and 2 bathrooms (1 en-suite) available to rent on the 1st floor of the highly sought after Riverlight Quay development. This spacious property of approx. 842sq.ft (78.20sq.m) has open plan living to the highest standards. There is full height floor to ceiling windows accessing 2 private balconies and offering fantastic views of the River Thames towards Battersea and beyond. The apartment has a smart open plan custom designed fitted kitchen with Siemens appliances. Additionally, there are 2 luxury bathrooms (1 en-suite), wood flooring and comfort cooling. Every floor in Riverlight One is intimate with no more than seven apartments sharing each level. Residents of Riverlight Quay have the use of a 24-hour concierge, a residents health spa with a well-equipped "river view" gymnasium, a heated swimming pool with steam room, sauna, and a Jacuzzi, as well as a cinema screening room and virtual golf facility. The on-site amenities include the Black Cab Coffee Co, Nine Elms Tavern, and Sainsbury's. There is also a Waitrose supermarket at Embassy Gardens, opposite, and you will also be within easy reach of other local shops and restaurants forming the Nine Elms regeneration with both Nine Elms & Battersea Power Station Tube Stations on your doorstep.

Please note furniture may differ to that shown in the current photos.

- Electricity Supply — Mains | Water Supply — Mains | Sewerage — Mains | Heating — Comfort Cooling
- Broadband & Mobile Signal : Check Coverage via Ofcom
- Parking: No parking included
- Lift Access
- Building Safety: EWS1 available on request
- Council Tax Band G (London Borough of Wandsworth)
- 12 Month Minimum Term
- 5 Week Security Deposit
- Holding deposit equivalent to 1 week of rent
- Rent to be payable monthly in advance
- EPC Rating B (85)

- 2 Bedrooms
- 842sq.ft (78.2sq.m)
- Direct Views Of The River Thames
- 2 Balconies
- Open Plan Reception
- 24 Hour Concierge
- Residents Gym
- Swimming Pool, Steam Room & Spa Facilities
- Cinema Screening Room & Virtual Golf
- 0.3 Miles to Battersea Power Station Tube

GARTON JONES.COM

9 Albert
Embankment
London
SE1 7SP

Lettings:
+44 (0) 20 7735 1888
nineelms@gartonjones.com
www.gartonjones.com



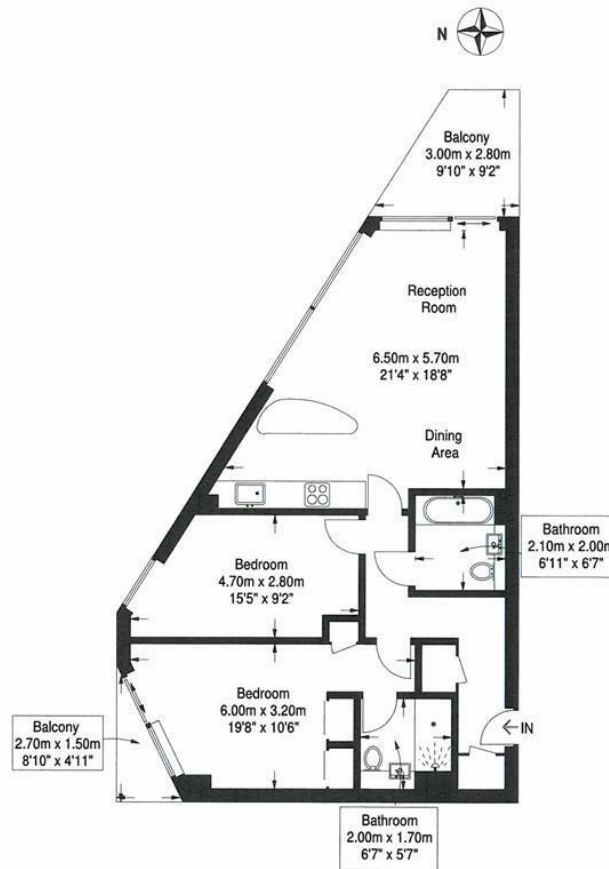

First Floor

Approximate Gross Internal Area
78.2 sq m / 842 sq ft
External Area = 9.2 sqm / 99 sq ft

This plan is for layout guidance only. Not drawn to scale unless stated. Windows and door openings are approximate. Whilst every care is taken in the preparation of this plan, please check all dimensions, shapes and compass bearings before making any decisions reliant upon them.

