



3 Riverlight Quay, London
SW11

GARTON JONES.COM



3 Riverlight Quay, London
, SW11

GARTON JONES.COM

9 Albert
Embankment
London
SE1 7SP

Sales +44 (0) 20 7735 1888
nineelms@gartonjones.com
www.gartonjones.com

£585 Per Week

A Manhattan-style studio apartment to rent of 405sq.ft (37.65sq.m) available in Riverlight Quay, a popular modern riverside development by St James located on the banks of the River Thames close to Battersea Power Station and the US Embassy. This contemporary apartment has an open plan reception room with a smart integrated kitchen, wood flooring with underfloor heating, comfort cooling, luxury bathroom, and spacious balcony overlooking beautiful communal gardens. Residents of Riverlight Quay benefit from exclusive facilities to include a fantastic Heated Swimming Pool, Jacuzzi, Sauna and Steam Room as well as a well-equipped mezzanine "river view" Gymnasium. There is also a reception lounge and library, 24-hour concierge and a private cinema screening room and virtual golf room. The on-site amenities include the Black Cab Coffee Co, Nine Elms Tavern and Waitrose supermarket and there are plenty of nearby new restaurants and bars adding to the increasing vibrancy of Nine Elms. Nine Elms Tube Station and Battersea Power Station Northern Line tube stops are both a short walk away from Riverlight Quay.

Please note furniture may differ to that shown in the current photos.

- Electricity Supply — Mains | Water Supply — Mains | Sewerage — Mains | Heating — Comfort Cooling
- Broadband & Mobile Signal : Check Coverage via Ofcom
- Parking: No Parking Included
- Lift Access
- Building Safety: EWS1 Available on Request
- Council Tax Band E (London Borough of Wandsworth)
- 5 Week Security Deposit
- Holding deposit equivalent to 1 week of rent
- Rent to be payable monthly in advance
- EPC Rating B (84)

- Manhattan Suite Apartment
- 405sq.ft (37.65sq.m)
- Open Plan Reception
- Modern Integrated Kitchen
- 24 Hour Reception
- Balcony with Partial River Views
- Residents Gym
- Swimming Pool, Sauna, Steam Room & Spa
- Cinema Screening Room & Virtual Golf
- 0.2 Miles from Battersea Power Station Tube Station



EPC certificate available on request.

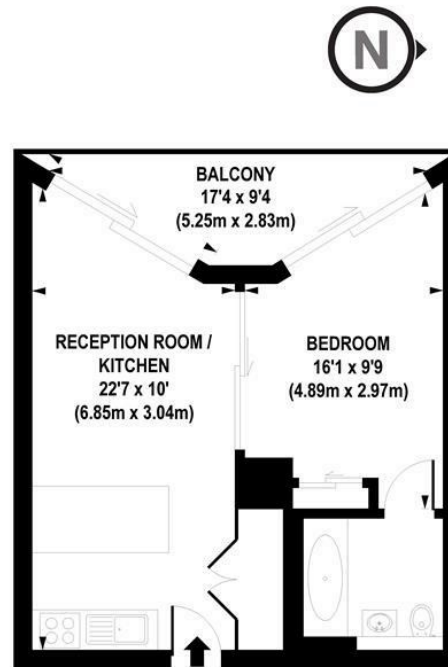

APPROX. GROSS INTERNAL FLOOR AREA 405 sq. ft / 37.65 sq. m

Floorplan is for illustrative purposes only and is not to scale.
Every attempt has been made to ensure the accuracy of the floorplan shown, however all measurements,
fixtures, fittings and data shown are an approximate interpretation for illustrative purposes only.
Liability for errors, omissions or mis-statement through negligence or otherwise is hereby excluded.

CP CREATIVE
PROPERTY MARKETING

