

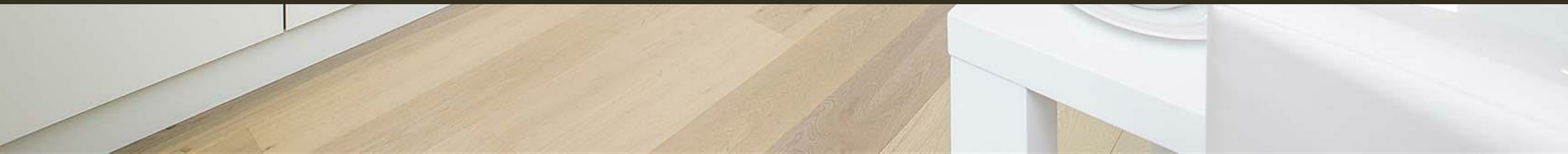

81 Black Prince Road, London
SE1

GARTON JONES.COM



81 Black Prince Road, London
, SE1

GARTON JONES.COM

9 Albert
Embankment
London
SE1 7SP

Sales +44 (0) 20 7735 1888
nineelms@gartonjones.com
www.gartonjones.com

£550 Per Week

A stunning 1-bedroom apartment of approximately 435sq.ft (40,2.7sq.m) available to rent in Parliament House, a popular residential development by Telford Homes set back from the River Thames. On offer is this 18th floor (with lift) property with South facing views. The apartment is completed to a high standard and comprises an open plan reception room, modern integrated kitchen, double bedroom, luxury bathroom and good storage. Parliament House provides residents with a daytime concierge service and a smart gymnasium, and you will be well located to local amenities including shops and restaurants. Transport links are very good with regular bus service on your doorstep as well as rail and tube connections of both Vauxhall and Westminster being within walking distance.

Please note furniture may differ to that shown in the current photos.

- Electricity Supply — Mains | Water Supply — Mains| Sewerage — Mains | Heating — Underfloor Heating
- Broadband & Mobile Signal : Check Coverage via Ofcom
- Parking: No Parking Included
- Lift Access
- Building Safety: Parliament House does not currently hold a satisfactory EWS1 rating and remedial works are required, however, there are interim measures in place
- Council Tax Band E (London Borough of Lambeth)
- 5 Week Security Deposit
- Holding deposit equivalent to 1 week of rent
- Rent to be payable monthly in advance
- EPC Rating B (81)

- 1 Bedroom
- 435sq.ft (40.4sq.m)
- Bathroom
- South Facing
- Open Plan Reception & Kitchen
- 18th Floor
- Fantastic Views
- Residents Gym
- Porter
- 0.6 Miles to Vauxhall Station



EPC certificate available on request.

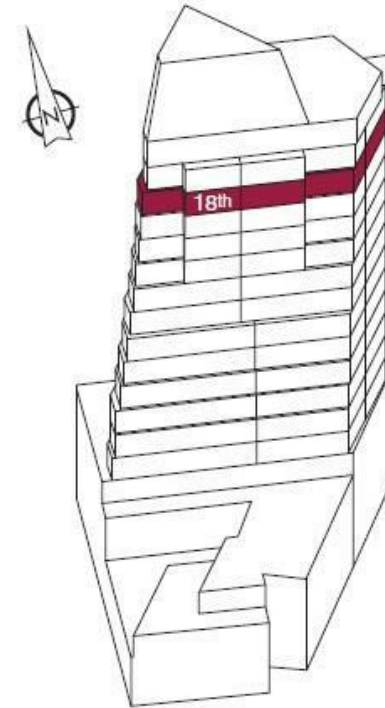
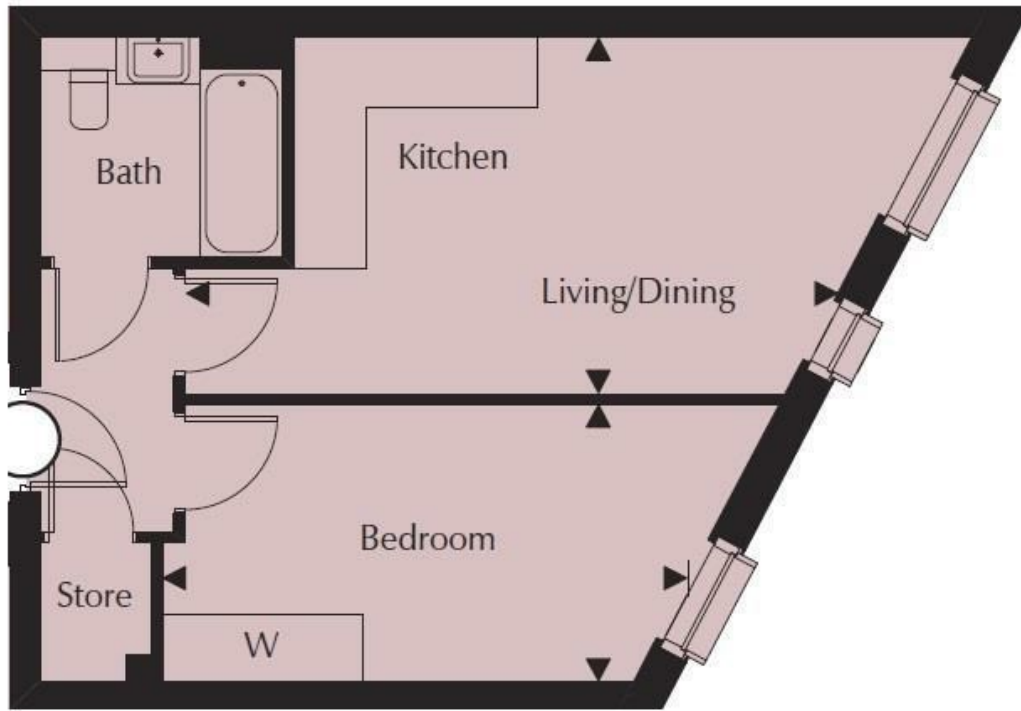

APARTMENT

Kitchen/Living/ Dining	5.88m x 3.24m	19'3" x 10'7"
Bedroom	4.75m x 2.49m	15'7" x 8'2"
Total Area	40.4 sq m	435 sq ft



