

BRICKWORKS

PROPERTY BROCHURE

⋮

Lawrence Road
South Tottenham, 1 Bed. Flat
£400,000

BRICKWORKS
Lawrence Road
South Tottenham, 1 Bed. Flat
£400,000



This one-bedroom purpose-built apartment in Tottenham delivers luxury living with an industrial edge.

BRICKWORKS

Lawrence Road

South Tottenham, 1 Bed. Flat

£400,000



- Type: Contemporary, purpose-built apartment
- Beds: One double bedroom
- Baths: One bathroom
- Living: High-spec open-plan living
- Outside space: Private terrace accessible via bedroom & living space
- Love: The industrial design inside & out
- Green Space: Close to Downhills Park & Lordship Rec
- Transport: Seven Sisters (0.4 miles) & South Tottenham (0.7 miles)
- Size: 37.43 sq m / 402 sq ft
- Status: The owner is actively looking

BRICKWORKS

Lawrence Road
South Tottenham, 1 Bed. Flat
£400,000



BRICKWORKS Floorplans

Approximate Floor Area:
37.43 sq m / 402 sq ft



FIRST FLOOR

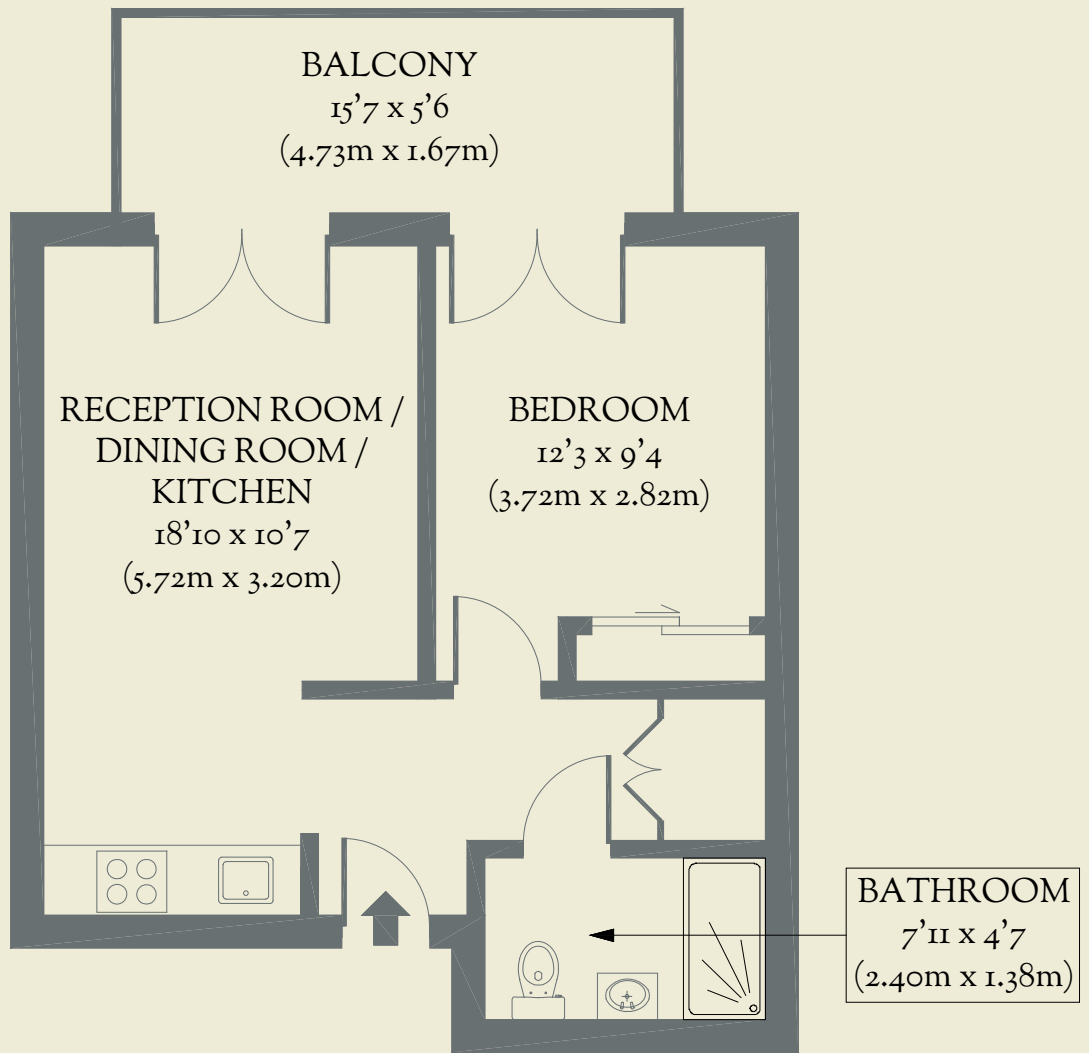

Lawrence Road
South Tottenham, 1 Bed. Flat
£400,000