

BRICKWORKS

PROPERTY BROCHURE

:

Nicholson Street
Southwark, 2 Bed. House
£950,000

BRICKWORKS
Nicholson Street
Southwark, 2 Bed. House
£950,000



Bursting with charm, this joyful two-bedroom home in SE1 balances the comforts of contemporary living with 1970s design. It's a warm, luminous sanctuary tucked steps away from the Southbank.

BRICKWORKS

Nicholson Street

Southwark, 2 Bed. House

£950,000



- Type: late 1970's terraced house (freehold)
- Beds: two double bedrooms
- Baths: one shower room plus WC
- Living: reception room leading to the garden & separate eat-in kitchen/diner
- Garden: private south-facing garden with patio
- Love: the floating 1970s staircase
- Location: near Borough Market, Southbank Centre, BFI, National Theatre, Tate Modern & The Cut
- Transport: Southwark (0.1 miles), Waterloo (0.4 miles); Borough (0.7 miles) & London Bridge (0.7 miles) away on foot
- Size: 841 sq ft / 78.11 sq m
- Status: the owners need to find

BRICKWORKS

Nicholson Street Southwark, 2 Bed. House £950,000



BRICKWORKS

Floorplans

APPROXIMATE FLOOR AREA:

63.99 sq m / 689 sq ft

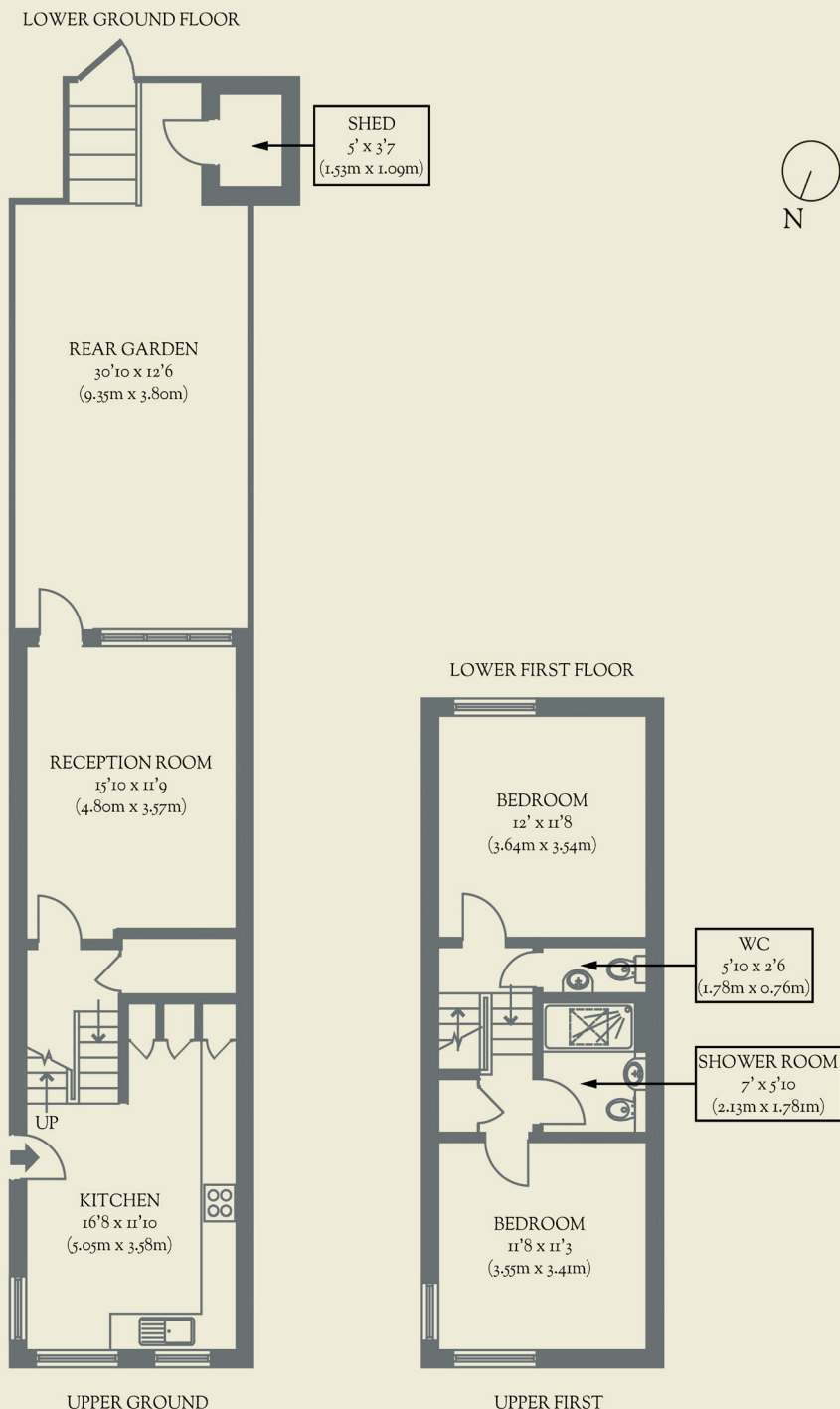

Nicholson Street
Southwark, 2 Bed. House
£950,000