Pritchards Road, E2
Guide price £475,000



Combining deft design and a top-notch location, this thoughtfully renovated one-bedroom flat in Bethnal Green means you have the East End as your playground.

- Type: Flat in a private, 1930s block (third floor)
- Beds: One bedroom
- Baths: Bathroom plus separate WC
- Living: Eat-in kitchen & living space
- Tenure: Leasehold (143 years remaining)
- Love: The bespoke carpentry in the bathroom, including space to house the washing machine, keeps everything neat as a pin & noise to a minimum
- Parks: Haggerston Park, Victoria Park & London Fields are all reachable within 15 minutes on foot
- Transport: Cambridge Heath (0.3 miles) & Bethnal Green (0.9 miles)
- Size: 49.94 sq m / 538 sq ft
- Chain: The owners need to find & are actively looking

BRICKWORKS

Approximate Floor Area:
49.94 sq m / 538 sq ft



THIRD FLOOR

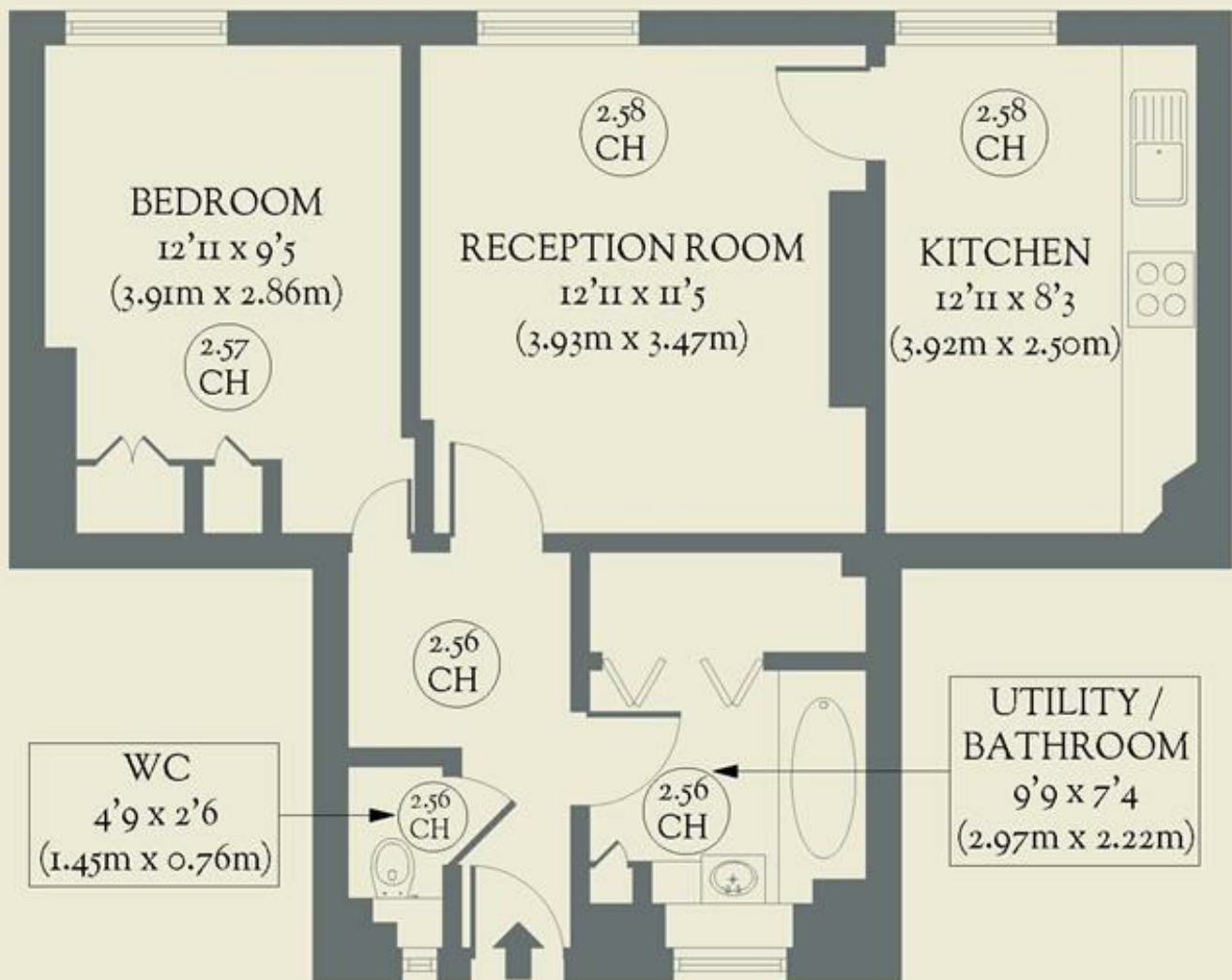

Pritchards Road
Bethnal Green