Oakum Square, E11
Guide price £375,000



Overlooking Langthorne Park in Leytonstone, this one-bedroom top-floor flat has an inviting balcony from which you can enjoy the perks of living parkside.

- Type: Modern apartment with private balcony (top floor)
- Beds: One bedroom
- Baths: One bathroom
- Living: Open-plan kitchen & living space
- Tenure: Leasehold (246 years remaining)
- Love: The location overlooking Langthorne Park
- Parks: Langthorne Park couldn't be any closer, while the Queen Elizabeth Olympic Park & Wanstead Flats are also nearby
- Transport: Leytonstone High Road (0.7 miles), Leyton (0.7 miles) & Maryland (0.9 miles)
- Size: 52.85 sq m / 569 sq ft
- Chain: The flat is being sold chain-free

BRICKWORKS

Approximate Floor Area:
52.85 sq m / 569 sq ft

THIRD FLOOR

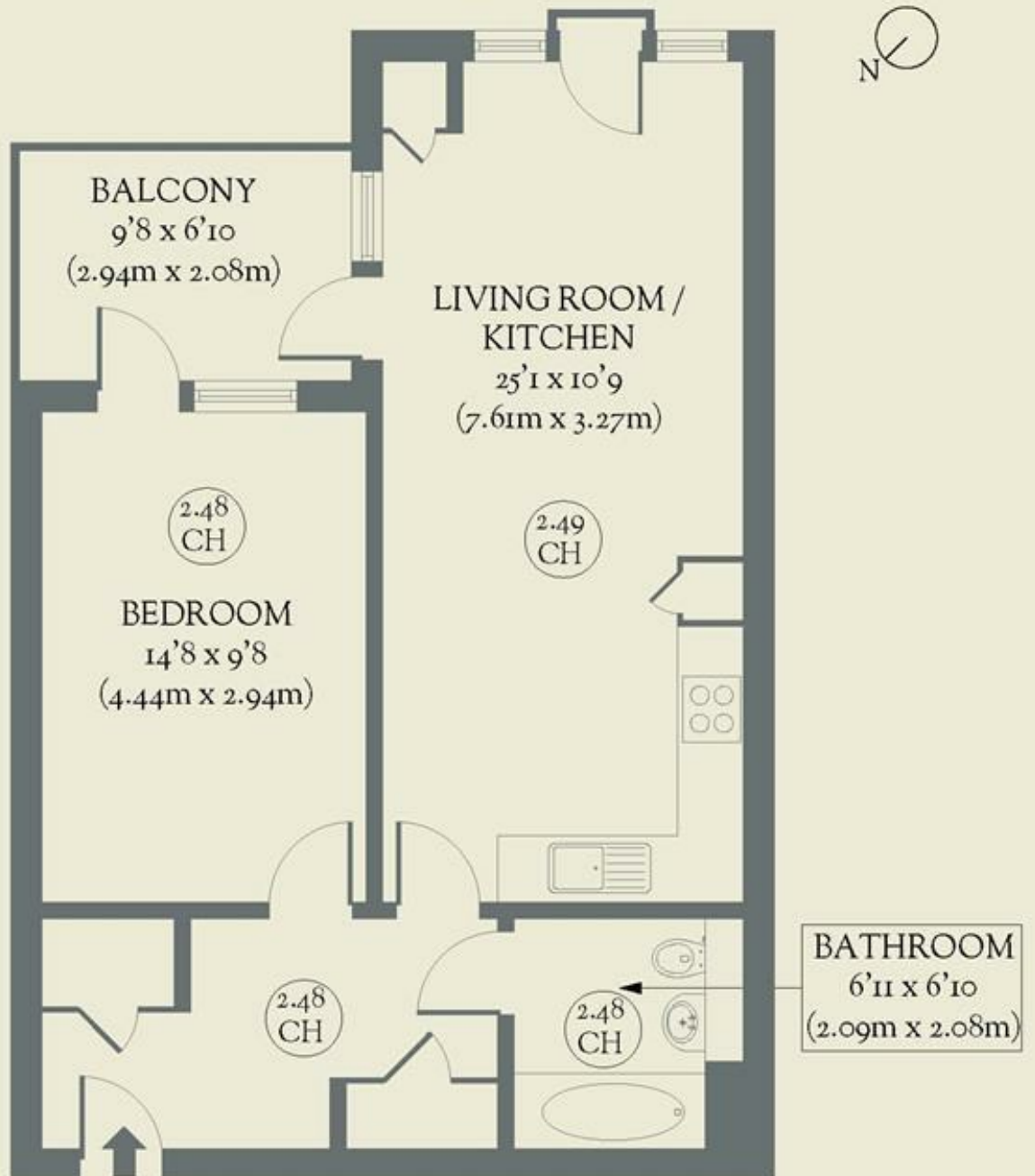

Oakum Square
Leytonstone