Salcombe Road, N16
Guide price £425,000



Found at the point Dalston and Stoke Newington meet, this one-bedroom, ground-floor flat in a Victorian mansion block excels at calm and immaculately presented spaces.

- Type: Ground floor flat in a Victorian mansion block
- Beds: One bedroom
- Baths: One bathroom
- Living: Separate kitchen & living space
- Tenure: Share of freehold (900 years remaining on the lease)
- Love: The quiet location, equidistant & only moments from Dalston & Stoke Newington
- Parks: Hackney Downs, Newington Green & Clissold parks are all nearby
- Transport: Dalston Kingsland (0.3 miles), Dalston Junction (0.4 miles) & Hackney Downs (0.8 miles)
- Size: 46.83 sq m / 504 sq ft
- Chain: The current owners have already found their new home. They need to link the sale and purchase.

BRICKWORKS

Approximate Floor Area:
46.83 sq m / 504 sq ft



GROUND FLOOR

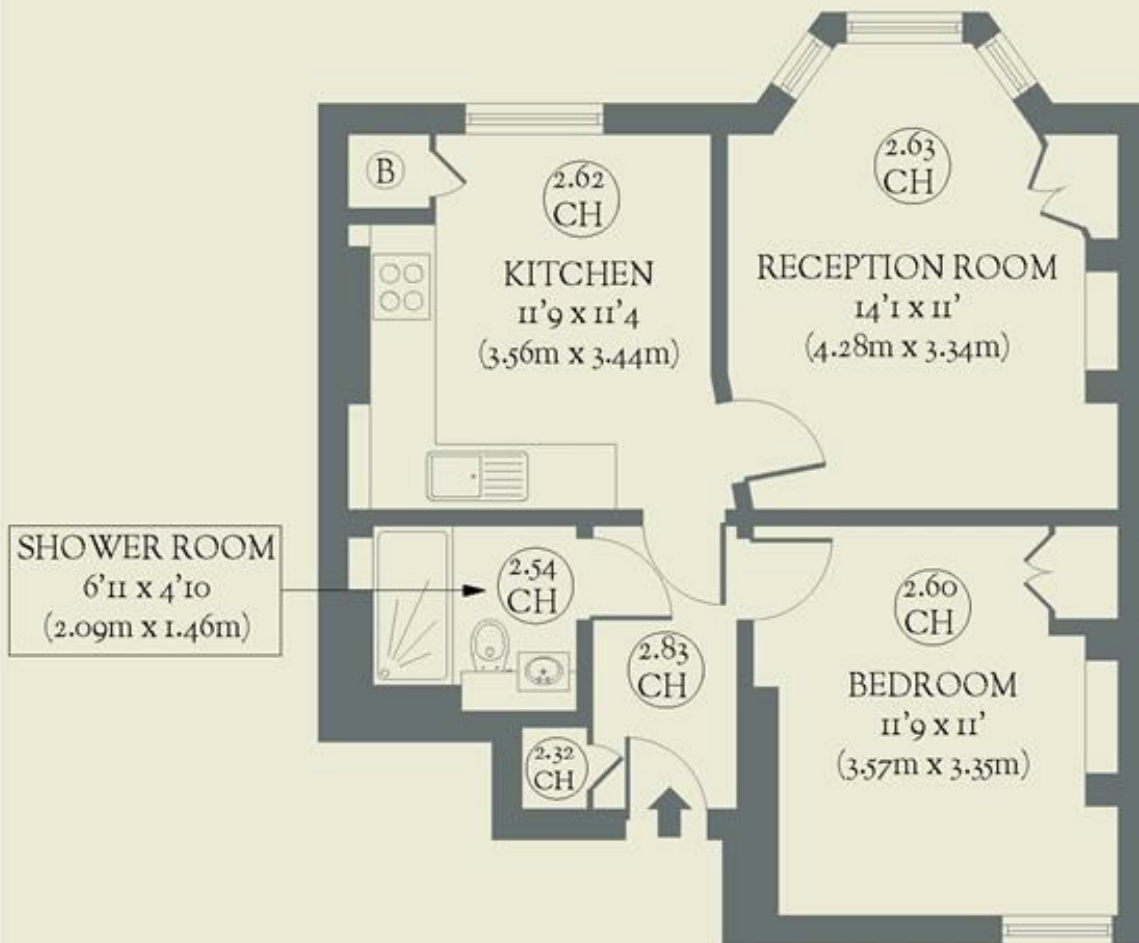

Salcombe Road
Stoke Newington