

---

**Belgrade Road, N16**  
Guide price £600,000

---



**Standing proud on the top floor of a warehouse-esque new build is a two-bedroom flat that exudes industrial cool, with a balcony overlooking the street below.**

- Type: A third-floor apartment in an industrial new build
- Beds: Two double bedrooms
- Baths: One bathroom & two WCs
- Living: Open-plan living space
- Tenure: Share of freehold
- Love: The location betwixt & between Stoke Newington & Dalston
- Parks: Hackney Downs, Albany Park & Clissold Park are nearby
- Transport: Dalston Kingsland Overground station (0.5 miles); Dalston Junction Overground station (0.6 miles); Rectory Road Overground station (0.7 miles)
- Size: 61.36 sq m / 660 sq ft
- Chain: The flat is being sold chain-free

# BRICKWORKS

Approximate Floor Area:  
61.36 sq m / 660 sq ft

## THIRD FLOOR

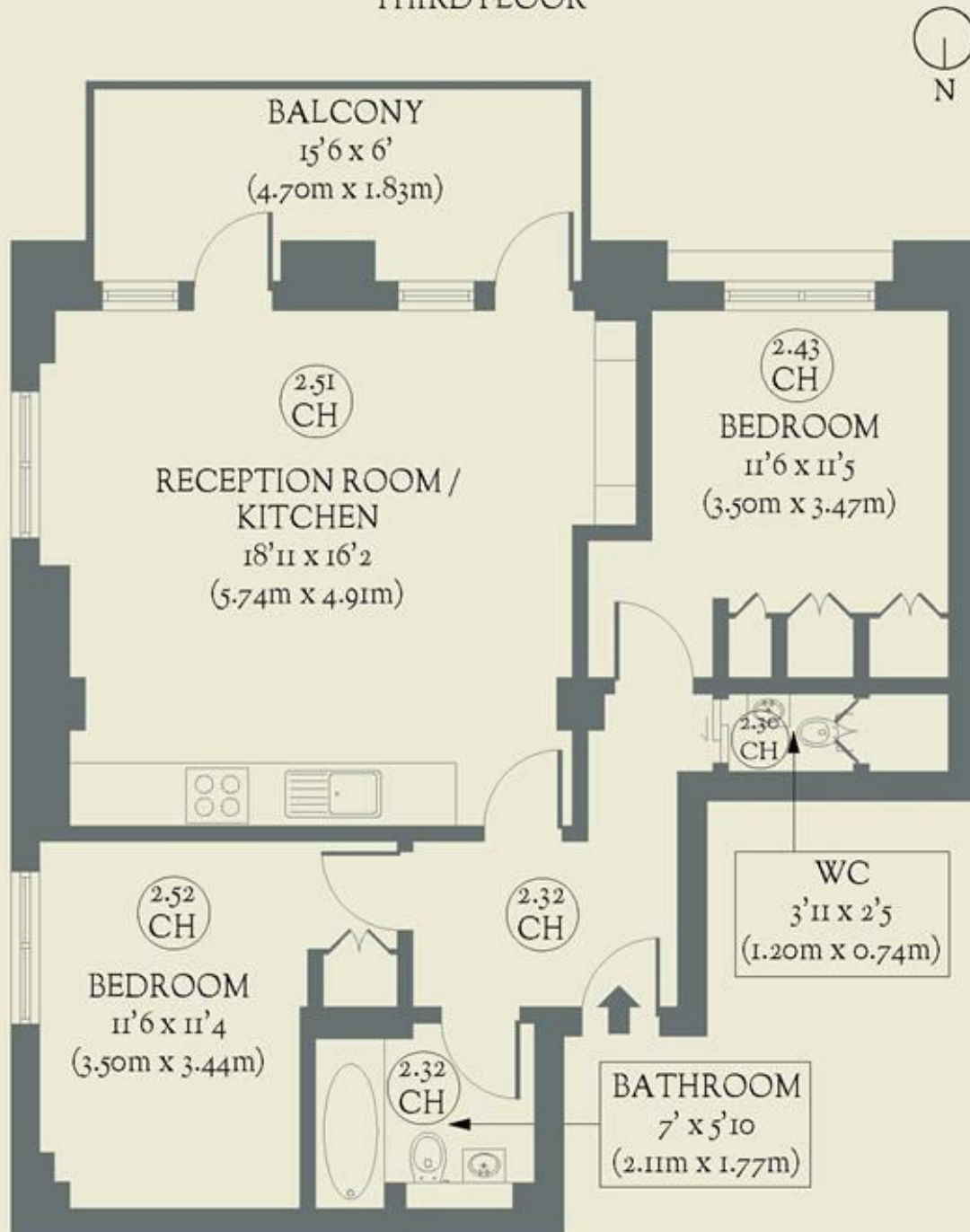

Belgrade Road  
Stoke Newington