Stroud Green Road, N4
Guide price £510,000



Overlooking the vibrant activity of Finsbury Park, this two-bedroom apartment pairs elegant interiors with bespoke functionality for an effortlessly relaxing space.

- Type: Split-level flat (top floor)
- Beds: Two bedrooms
- Baths: One bathroom
- Living: Open-plan kitchen & living space
- Tenure: Leasehold (102 years remaining)
- Love: The pretty in pink bedroom
- Parks: Finsbury Park & Parkland Walk are within easy reach
- Transport: Finsbury Park Underground (0.2 miles)
- Size: 64.90 sq m / 690 sq ft
- Chain: The owners are actively looking for their next project

BRICKWORKS

Approximate Floor Area:
64.10 sq m / 690 sq ft

SECOND FLOOR

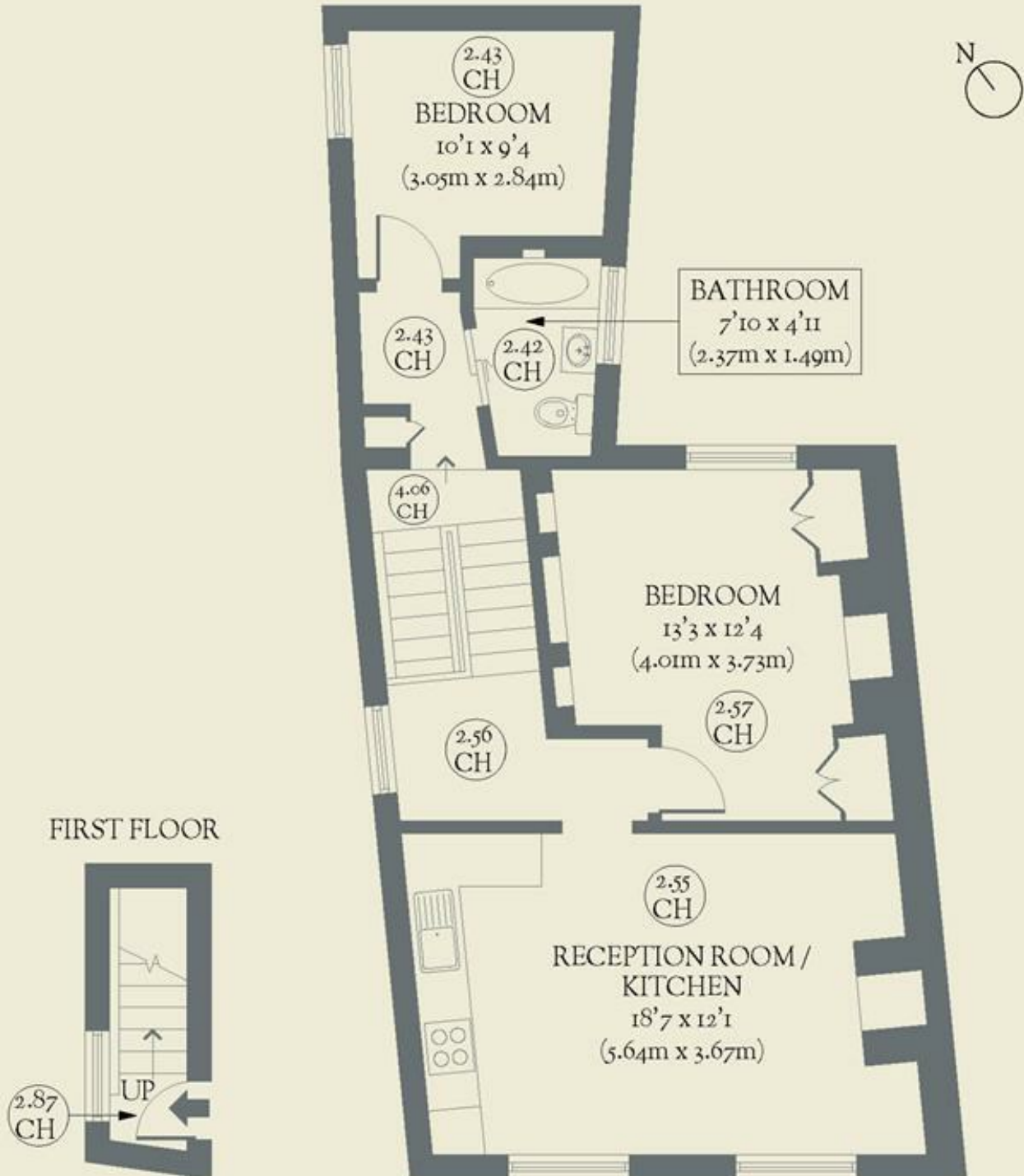

FIRST FLOOR

Stroud Green Road
Stroud Green