Dynham Road, NW6
Guide price £725,000



Maximalist and grand, this impeccable two-bedroom split-level flat in West Hampstead is made to relax in comfort and style.

- Type: Victorian first-floor flat
- Beds: Two bedrooms (both doubles)
- Baths: One bathroom
- Living: Living room & separate kitchen
- Love: The beautiful period features & exquisite decoration
- Parks: Kilburn Grange Park & Queen's Park are both close by
- Transport: West Hampstead (0.3 miles), Brondesbury (0.4 miles), Kilburn (0.6 miles), (Kilburn Park 0.8 miles)
- Size: 68.74 sq m / 740 sq ft
- On-street parking: Camden resident's permit
- Chain: Owners need to find & are actively looking

BRICKWORKS

Approximate Floor Area:
68.74 sq m / 740 sq ft

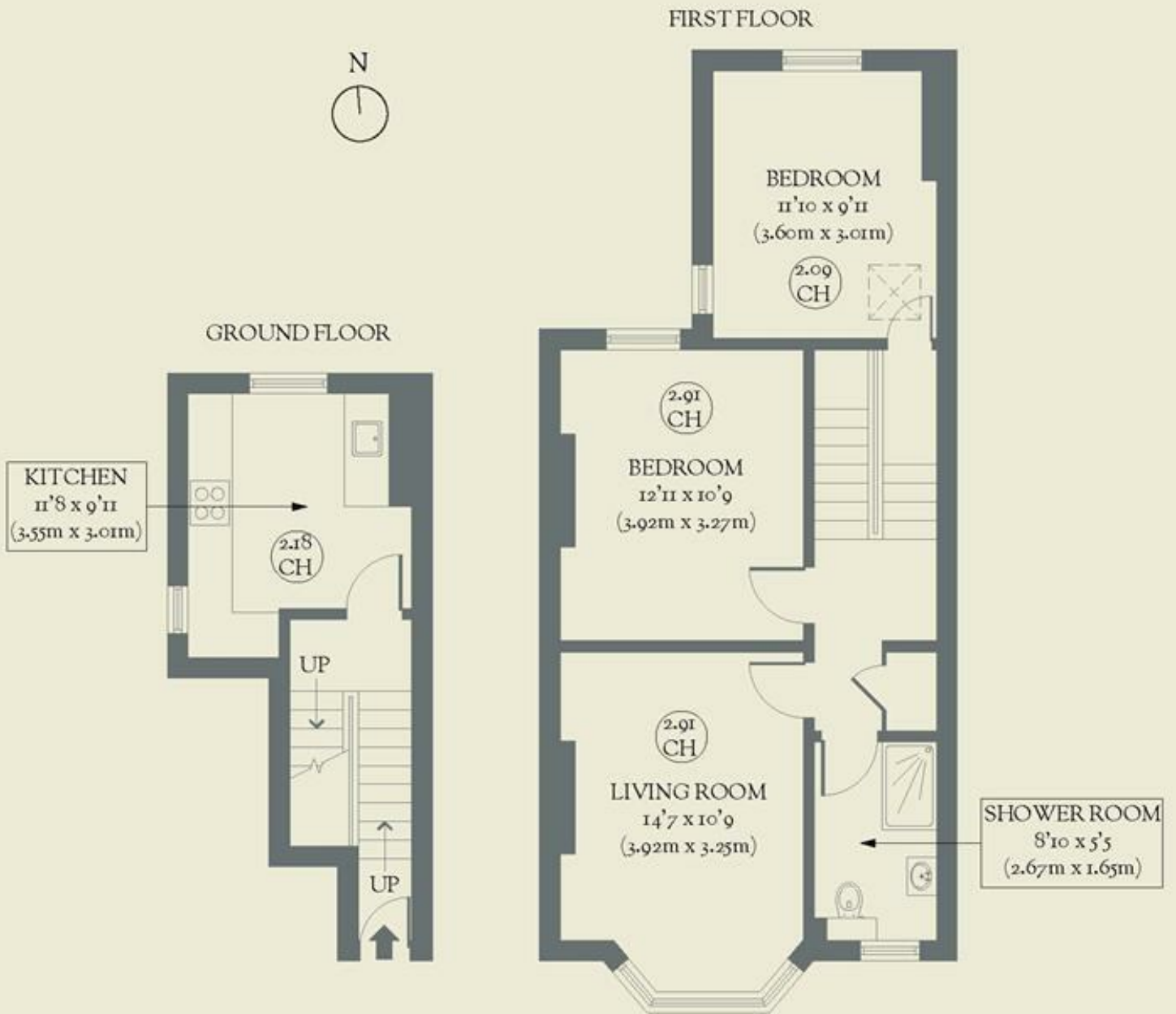

Dynham Road
West Hampstead