

BRICKWORKS

PROPERTY BROCHURE

⋮

Belgrade Road  
*Stoke Newington, 2 Bed. Flat*  
£675,000

BRICKWORKS  
Belgrade Road  
Stoke Newington, 2 Bed. Flat  
£675,000



Betwixt and between Dalston and Stoke Newington, this two-bedroom ground-floor apartment embraces the industrial and is carefully designed for urban living.

# BRICKWORKS

## Belgrade Road

### Stoke Newington, 2 Bed. Flat

#### £675,000



- **Type:** Ground-floor flat in a contemporary apartment block
- **Beds:** Two double bedrooms
- **Baths:** One bathroom
- **Living:** Open-plan living space
- **Tenure:** Share of freehold
- **Love:** The industrial characteristics, including the unique shape of the second bedroom
- **Parks:** Hackney Downs and Clissold Park are nearby
- **Transport:** Dalston Kingsland Overground station (0.5 miles); Dalston Junction Overground station (0.6 miles); Rectory Road Overground station (0.7 miles)
- **Size:** 76.54 sq m / 824 sq ft
- **Chain:** The owners are selling chain-free



# BRICKWORKS

Belgrade Road  
Stoke Newington, 2 Bed. Flat  
£675,000



# BRICKWORKS Floorplans

Approximate Floor Area:  
76.54 sq m / 824 sq ft

GROUND FLOOR

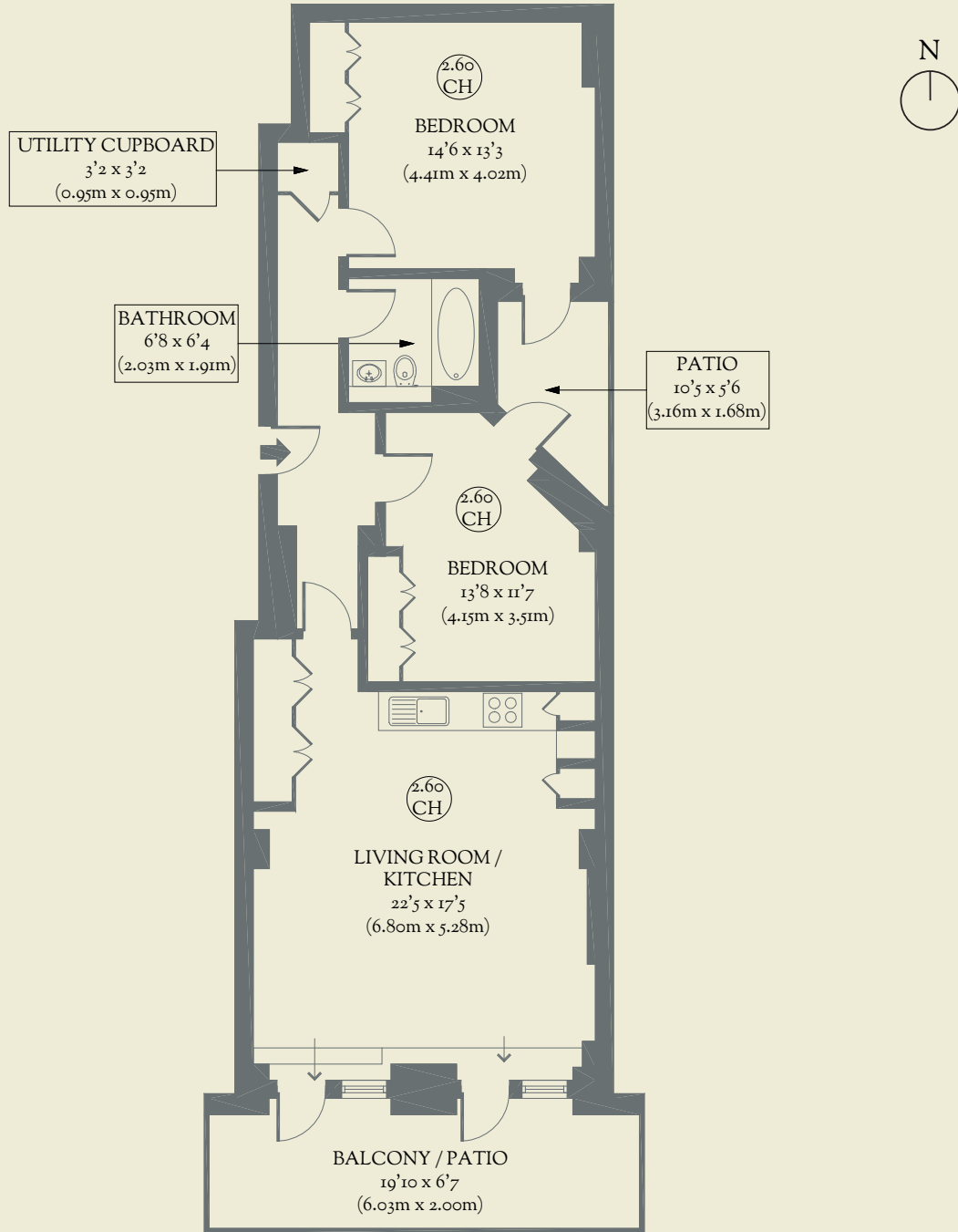

Belgrade Road  
Stoke Newington, 2 Bed. Flat  
£675,000