

BRICKWORKS

PROPERTY BROCHURE

⋮

Heysham Road
Manor House, 3 Bed. Maisonette
£650,000

BRICKWORKS
Heysham Road
Manor House, 3 Bed. Maisonette
£650,000



Set over two light-filled floors, this spacious three-bedroom flat near Seven Sisters offers calm and considered interiors and a private south-facing terrace and garden to enjoy.

BRICKWORKS

Heysham Road

Manor House, 3 Bed. Maisonette

£650,000



- Type: Edwardian first-floor maisonette with private garden
- Beds: Three double bedrooms
- Baths: Two bathrooms
- Living: Open-plan living room, dining area & kitchen
- Love: Creamy neutral palette & sunny garden terrace
- Parks: Woodberry Wetlands, Finsbury Park, Walthamstow/ Tottenham Marshes & Clissold Park are all close by
- Transport: Closest stations are Stamford Hill (0.4 miles), Seven Sisters (0.6 miles), Manor House (0.7 miles) & South Tottenham (0.8 miles)
- Size: 106.40 sq. m / 1145 sq. ft
- Chain: Being sold chain-free

BRICKWORKS

Heysham Road

Manor House, 3 Bed. Maisonette

£650,000



BRICKWORKS Floorplans

Approximate Floor Area:
106.40 sq m / 1145 sq ft (Including Restricted Height Area)
94.54 sq m / 1018 sq ft (Excluding Restricted Height Area)

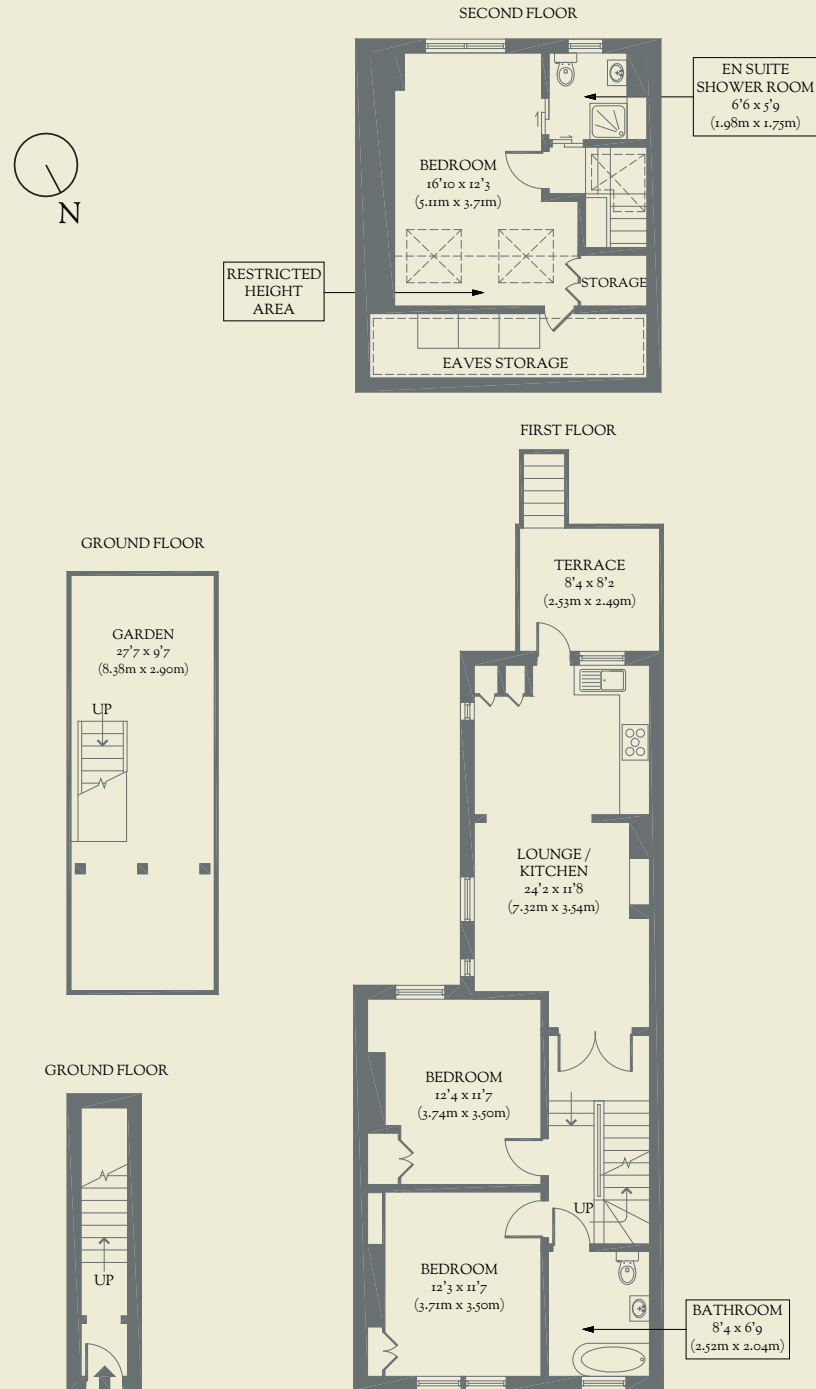

Heysham Road
Manor House, 3 Bed. Maisonette
£650,000