

This survey has been produced at the survey scale detailed below with its accuracy commensurate with the indicated scale and should only be used for its original intended purpose. Any scaling should only be undertaken using a stable media print produced using the original data. The plotted scale may differ (for presentation purposes) from the survey scale.
 It is for the use only of the party to whom it has been addressed and no responsibility is accepted to any third party for the whole or part of its contents. This survey has been prepared from the best data available and the surveyor does not accept any liability for any errors or omissions. All ground features that were visible at the time of the survey have been located, however there may have been items obscured. Pipe sizes and flow direction have been visually assessed from the surface and should be considered as approximate only.
 All data remains in the ownership of Formby Surveys Ltd and any discrepancies between this survey and any other information should be reported to Formby Surveys Ltd.

Measured Building Legend
(where applicable)



Abbreviations
(where applicable)

A	Alarm	HE	Heater
AB	Air Brick	HR	Hose Reel
ACU	Air Conditioning Unit	HY	Hydrant
ACV	Air Conditioning Vent	IB	Isolation Board
AN	Access Hatch	IC	Inspection Chamber
AP	Access Panel	IG	Information Sign
AS	Aerial Socket	ISW	Isolation Switch
AV	Air Valve	IT	Intercom
BC	Building Canopy	JTN	Junction Box
BH	Beam Height	LV	Low Voltage Elec.
BHL	Beam Head Level	MCU	Media Control Unit
BSS	Beam Split Level	ME	Meat Manhole
BM	Bench Mark	MH	Manhole
BNDY	Boundary	MK	Marker
BO	Bolton	NB	Notice Board
BT	British Telecom Manhole	NF(S)*	Additional Survey Station
BW	Brick Wall	NP	Road Name Plate
CCTV	Closed Circuit Television	OB	Out Building
C-H	Cl to Head Height	OS	Ordinance Survey
CH	Ceiling Height	P	Post
CL	Ceiling Level	PO	Post Office Manhole
COL	Column	PP	Power Point
CR	Cycle Rack	PS	Radiator
CRE	Crest Height	RD	Road Sign
CTV	Cable Television Manhole	RE	Rodding Eye
CUL	Culvert	RS	Road Sign
DF	Drinking Fountain	RTW	Retaining Wall
DP	Drain Pipe	RWP	Rainwater Pipe
DPC	Damp Proof Course	SDP	Stand Pipe
D	Drain	SK	Skewway
DH	Door Height	SKY	Skylight
DL	Door Level	SOFL	Soft Level
EB	Electricity Box	SWMH	Storm Water Manhole
EL	Electricity Manhole	ST	Stop Tap
EM	Electricity Meter	SV	Stop Valve
EP	Electricity Pole	SVP	Soil Vent Pipe
ER	Earthing Rod	SW	Surface Water
FA	Fire Alarm	TBM	Temporary Benchmark
FB	Flower Bed	TH	Threshold Level
F-C	Floor to Ceiling Height	TDW	Top of Wall
F-H	Floor to Head Height	TP	Telephone Point
FCL	False Ceiling Level	TPT	Trail Pit
FFL	Finished Floor Level	TS	Thermostat
FL	Floor Level	UTR	Unable To Raise
FMH	Foul Water Manhole	VP	Vent Pipe
FP*	Foul Water	WCL	Window Cill Level
FW	Foul Water	WHL	Window Head Level
FX	Fire Extinguisher	WL	Wall Level
GAS	Gas Valve	WM	Water Meter
GL	Ground Level	WP	Waste Pipe
GM	Gas Meter	WT	Water Tap
GU	Gully	WV	Wall Vent
H	Height		

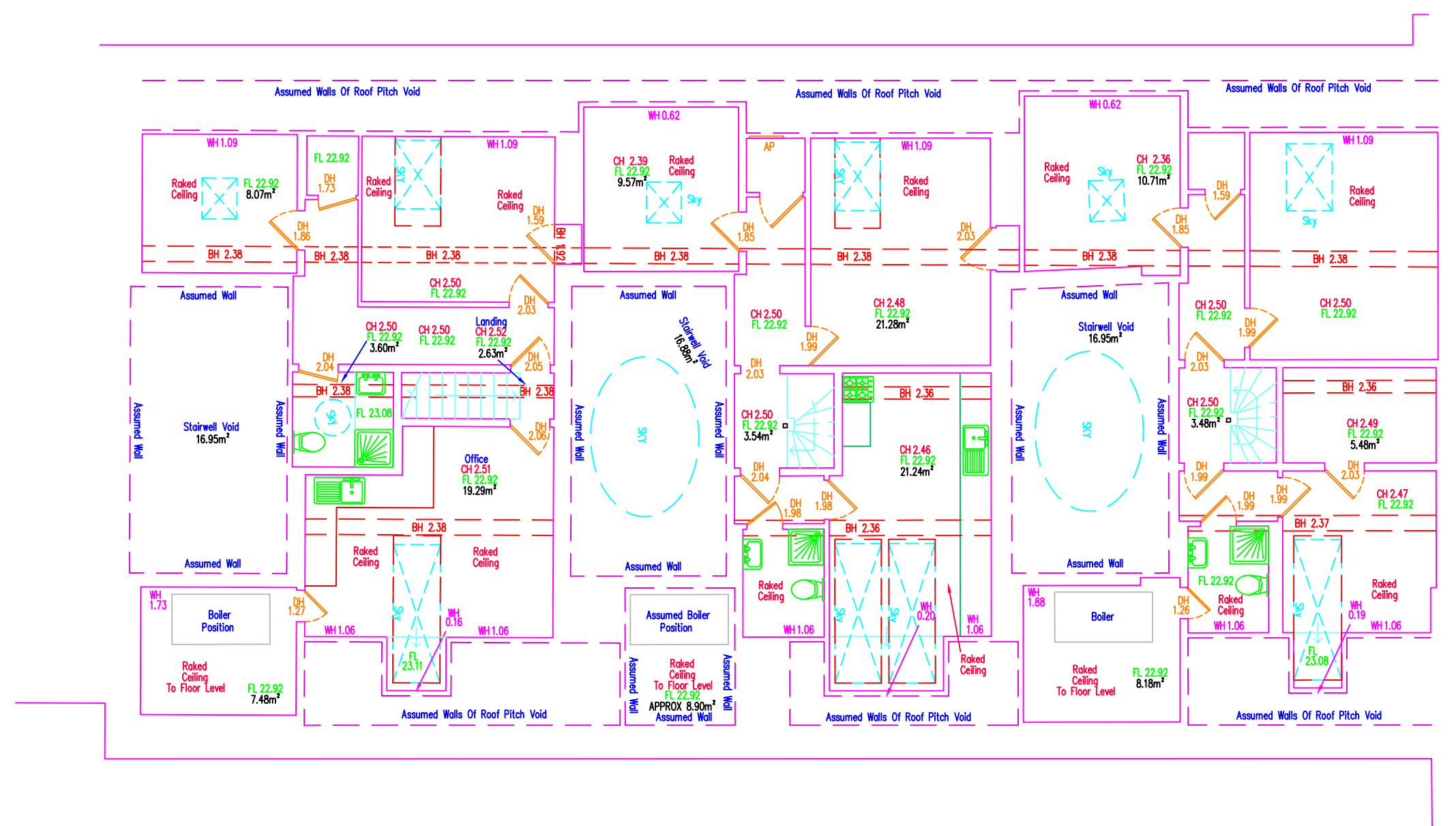

Grid & Datum

Survey Grid: Local Grid Nat. Grid (easting) Nat. Grid (northing) Existing Grid
 Survey Datum: Local Datum Nat. Grid (easting) Nat. Grid (northing) O.S.B.M.
 The survey grid and level datum relate to an arbitrary local grid orientated to north via compass bearing.

General Notes

- All arrows on stairs, steps & ramps etc indicate an UP direction unless otherwise stated.
- Door sizes are measured as the "moving part" of the door.

Rev	Date	Description	CAD

Client
Gainmill

measure manage deliver[®]
Formby Surveys
 Professional Measurement Surveyors

Formby Surveys Ltd T +44 (0)151 329 3040
 The Hayes Building F +44 (0)151 329 3140
 16-18 Johnson Street E info@formbysurveys.com
 Liverpool W www.formbysurveys.com
 L3 2BQ

Third Floor Plan
Gainmill House,
Birkenhead, CH41 5AT

Plotted Scale: A2@1:100
 NB: Survey Scale: 100

Surveyor: AR/NT/DL	CAD: DW	Checker: MLS	Rev:
Date of Issue: March 2020	FSL Ref No: 10801_3:100:1:1		

