

SNELLERS

ESTATE AGENTS



Loring Road, TW7

£775,000

This stunning four-bedroom Victorian residence is situated on one of Isleworth's most desirable streets. Offering over 1,500 sq ft of beautiful living space, the home has been thoughtfully extended and renovated. A rear extension enhances the ground floor, while the entire property has been upgraded to a high standard carefully retaining its original period charm and character throughout.

Located on Loring Road, this home enjoys a prime position just a short walk from Isleworth station, providing direct services to London Waterloo. The area is well served by excellent local schools, parks, and amenities, making it an ideal setting for families.

- Four Bedroom • 1,500 Sq. Ft • 2 Bathrooms •
- Modern Rear Extension • End of Terrace • Prime Location •

SNELLERS

ESTATE AGENTS

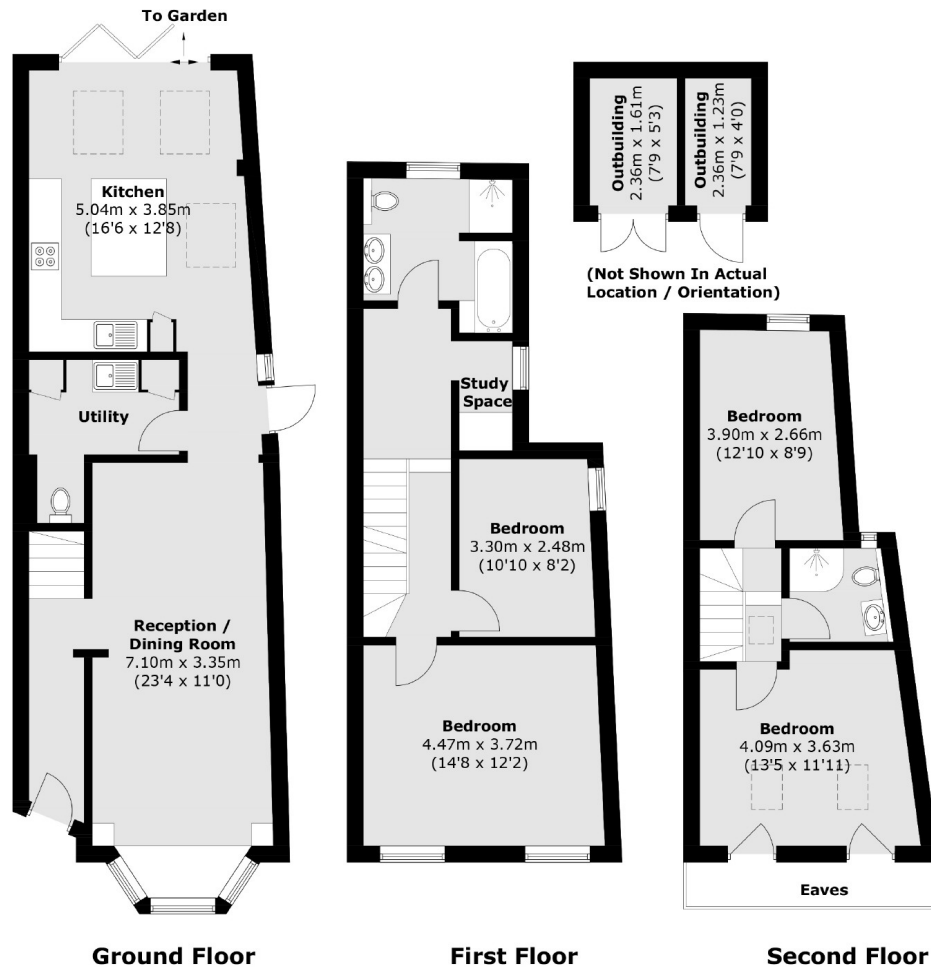

Total area (approx.): 137.3 sq. m (1,477.9 sq. ft)
Outbuilding area (approx.): 7.0 sq. m (75.3 sq. ft)

Snellers St. Margarets Sales
36 Crown Road
St Margarets
TW1 3EH
020 8892 8008
stmargaretssales@snellers.co.uk

Energy Rating: We aim to make our particulars both accurate and reliable. However they are not guaranteed; nor do they form part of an offer or contract. If you require clarification on any points then please contact us, especially if you're traveling some distance to view. Please note that appliances and heating systems have not been tested and therefore no warranties can be given as to their good working order