

SNELLERS

ESTATE AGENTS



London Road, TW7

£350,000

Perfect for first-time buyers or Buy-to-Let investors, this incredibly spacious one-bedroom apartment boasts a modern finish throughout and offers significantly more square footage than your typical one-bed. An opportunity not to be missed at a reduced cost!

The property benefits from two storage cupboards, an in-built wardrobe and bathroom cabinet, as well as built-in blinds across six windows. The double-glazed windows are fully soundproofed, providing excellent insulation for year-round comfort.

The owners have also purchased a secure allocated parking space, conveniently located close to the back entrance for ease of access. The apartment is being offered with no onward chain.

Positioned within walking distance of the picturesque Syon Park, the historic London home of the Duke of Northumberland, the River Thames, and the renowned London Apprentice pub, the property also enjoys easy access to Richmond, making it a highly desirable location.

- Incredibly Spacious • High Specification • Allocated Parking Space •
- First Floor Flat • 1 Owner Since New • No Onward Chain •

SNELLERS

ESTATE AGENTS

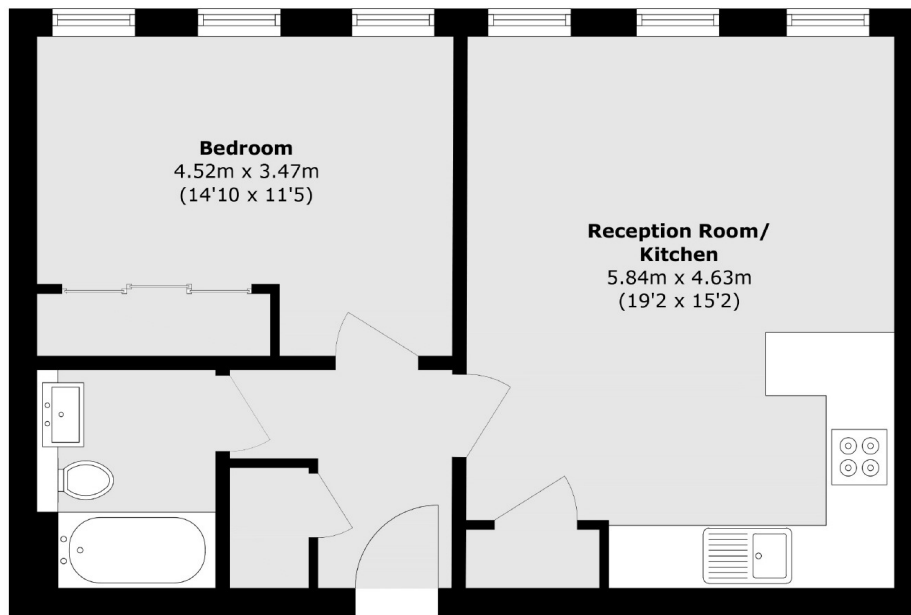

Total area (approx.): 55.7 sq. m (599.5 sq. ft)

Snellers St. Margarets Sales
36 Crown Road
St Margarets
TW1 3EH
020 8892 8008
stmargaretssales@snellers.co.uk

Energy Rating: We aim to make our particulars both accurate and reliable. However they are not guaranteed; nor do they form part of an offer or contract. If you require clarification on any points then please contact us, especially if you're traveling some distance to view. Please note that appliances and heating systems have not been tested and therefore no warranties can be given as to their good working order