



Arlington Road, TW1

£565,000

A beautifully presented and cleverly designed, second floor three bedroom two bathroom apartment including no chain and a share of the freehold enviably located on one of the finest residential tree-lined roads in East Twickenham.

Sefton Lodge is located on Arlington Road in the catchment of the most desirable schools in the area and moments away from Richmond and St Margarets offering an array of amenities and transport links nearby.

- Second Floor • Three Bedrooms • Two Bathrooms •
- Excellent Condition • Share of Freehold • No Chain •

SNELLERS

ESTATE AGENTS

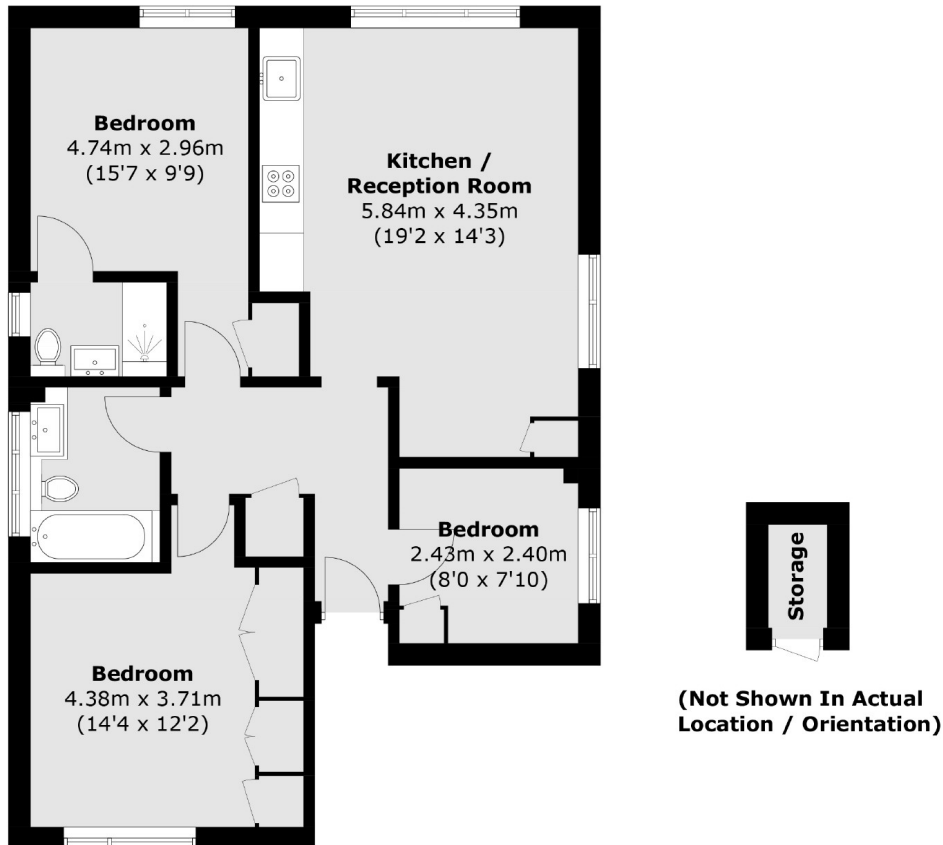

Total area (approx.): 70.9 sq. m (763.2 sq. ft)

External Storage: 1.2 sq. m (12.9 sq. ft)

Snellers St. Margarets Sales
36 Crown Road
St Margarets
TW1 3EH
020 8892 8008
stmargaretssales@snellers.co.uk

Energy Rating: We aim to make our particulars both accurate and reliable. However they are not guaranteed; nor do they form part of an offer or contract. If you require clarification on any points then please contact us, especially if you're traveling some distance to view. Please note that appliances and heating systems have not been tested and therefore no warranties can be given as to their good working order