

SNELLERS

ESTATE AGENTS



Cambridge Park, TW1

£1,750 PCM

This two bedroom first floor flat, forming part of this impressive Victorian property with high ceilings throughout, has a spacious reception room, a separate modern kitchen, bathroom suite and two good sized double bedrooms. Further benefits include a small balcony off the master bedroom and access to rear communal gardens.

Moments from Marble Hill Park and Orleans Park School, Cambridge Park is equidistance from both Richmond town centre and St Margarets Village for numerous shops, cafes and transport links.

- Victorian Conversion • First Floor Flat • Period Features •
- Two Double Bedrooms • Communal Garden • Great Location •

SNELLERS

ESTATE AGENTS

First Floor

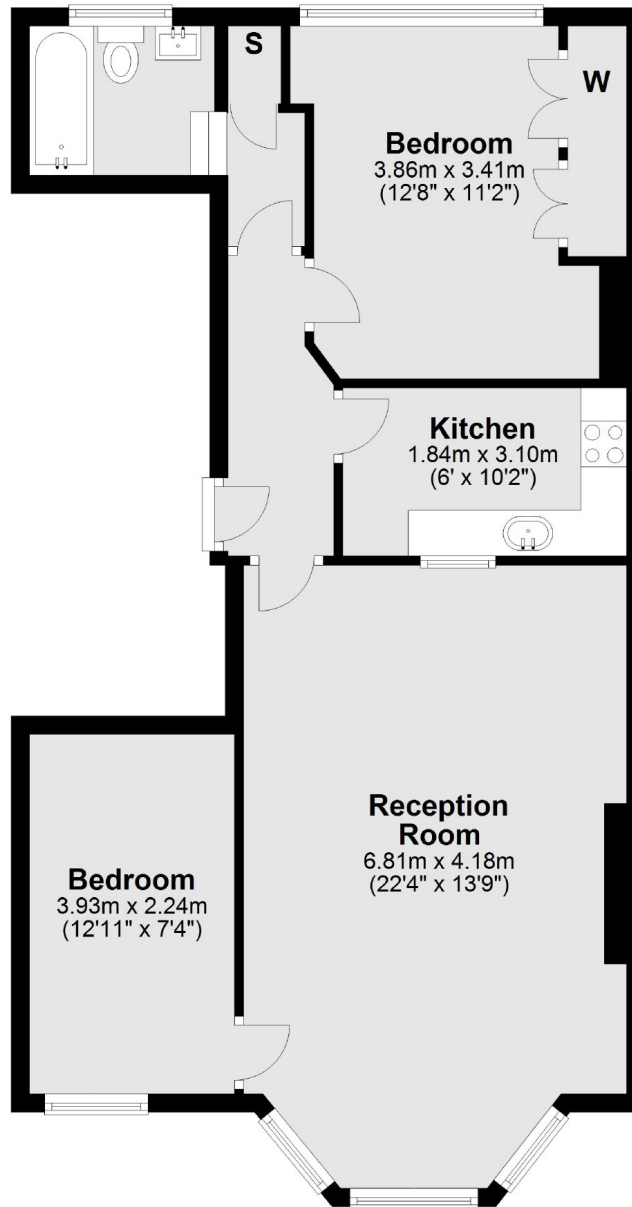

Total area: approx. 65.0 sq. metres (699.7 sq. feet)

Snellers St. Margarets Lettings
36 Crown Road
St Margarets
TW1 3EH
020 8892 0700
stmargaretslettings@snellers.co.uk

Energy Rating: We aim to make our particulars both accurate and reliable. However they are not guaranteed; nor do they form part of an offer or contract. If you require clarification on any points then please contact us, especially if you're traveling some distance to view. Please note that appliances and heating systems have not been tested and therefore no warranties can be given as to their good working order