

# SNELLERS

ESTATE AGENTS



## Primrose Place, TW7

£625,000

Offered to the market with no onward chain is this well presented and proportioned three bedroom three bathroom townhouse including off street parking and an integral garage located within this popular modern development.

Primrose Place is located off London road, moments away from local amenities and Isleworth mainline train station. It is also within easy access to St Margarets, Richmond and Twickenham.

- Townhouse • Three Bedrooms • Three Bathrooms •
- No Chain • Private Garden • Garage & Off-Street Parking •

# SNELLERS

ESTATE AGENTS

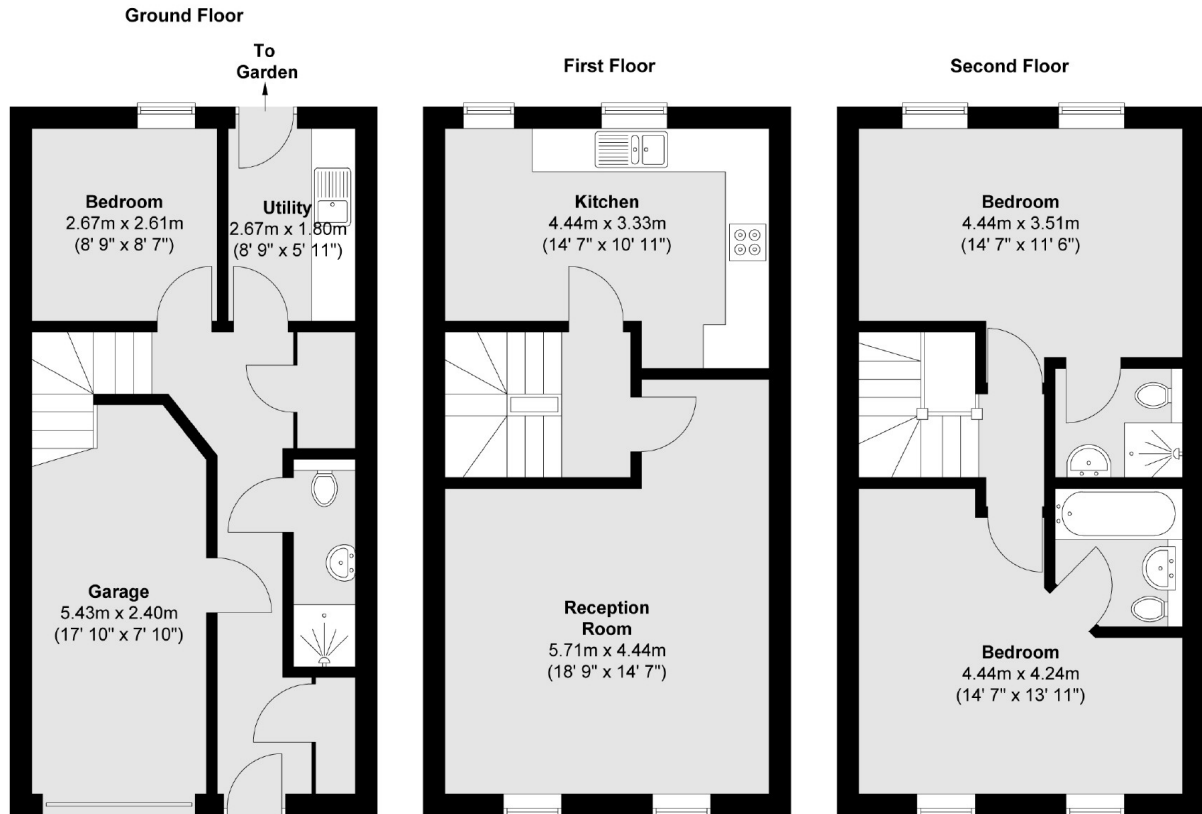

Total area (approx.) : 122.5 sq. m (1318 sq. ft)

Snellers St. Margarets Sales  
36 Crown Road  
St Margarets  
TW1 3EH  
020 8892 8008  
stmargaretssales@snellers.co.uk

Energy Rating: We aim to make our particulars both accurate and reliable. However they are not guaranteed; nor do they form part of an offer or contract. If you require clarification on any points then please contact us, especially if you're traveling some distance to view. Please note that appliances and heating systems have not been tested and therefore no warranties can be given as to their good working order