

# SNELLERS

ESTATE AGENTS



## Steele Road, TW7

£675,000

A fantastic opportunity to purchase this well presented, three bedroom Victorian family home with scope to extend (STPP) located on this highly popular residential road in Old Isleworth.

Steele Road on the Old Isleworth / St Margarets borders is within minutes of the River Thames and its beautiful tow path walks into Richmond. Its close proximity to St Margarets village offers a wealth of local amenities and outstanding schools.

- Victorian Family Home • Three Bedrooms • Good Condition •
- Potential to Extend (STPP) • South-East Facing Garden • Excellent Location •

# SNELLERS

ESTATE AGENTS

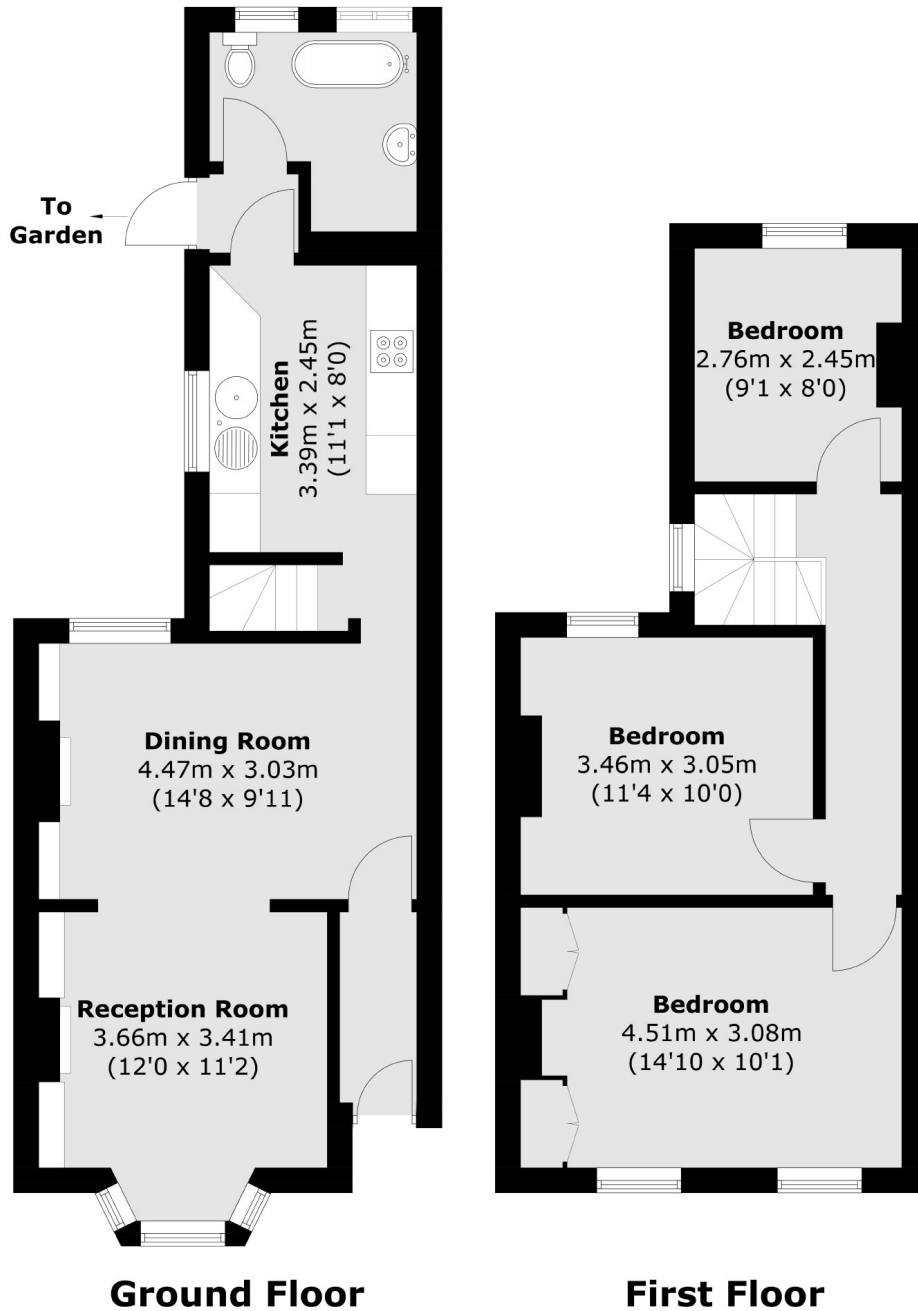

Total area (approx.): 85.4 sq. m (919.2 sq. ft)

Snellers St. Margarets Sales  
36 Crown Road  
St Margarets  
TW1 3EH  
020 8892 8008  
[stmargaretssales@snellers.co.uk](mailto:stmargaretssales@snellers.co.uk)

Energy Rating: D We aim to make our particulars both accurate and reliable. However they are not guaranteed; nor do they form part of an offer or contract. If you require clarification on any points then please contact us, especially if you're traveling some distance to view. Please note that appliances and heating systems have not been tested and therefore no warranties can be given as to their good working order