

SNELLERS

ESTATE AGENTS



Norfolk Close, TW1

£575,000

Enviably nestled away in a quiet cul-de-sac, this property presents a fantastic opportunity to acquire an unrivalled private garden and a ground floor maisonette in the heart of St Margarets. The accommodation offers an entrance hallway, family bathroom, kitchen, two bedrooms and a large reception room onto the garden.

Norfolk Close is a quiet cul-de-sac, located moments away from St Margarets High street, amenities, mainline train station and is close proximity to Richmond and Twickenham.

- Ground Floor Maisonette • Two Bedrooms • Recently Refurbished •
- Substantial Private Garden • Long Lease • No Chain •

SNELLERS

ESTATE AGENTS

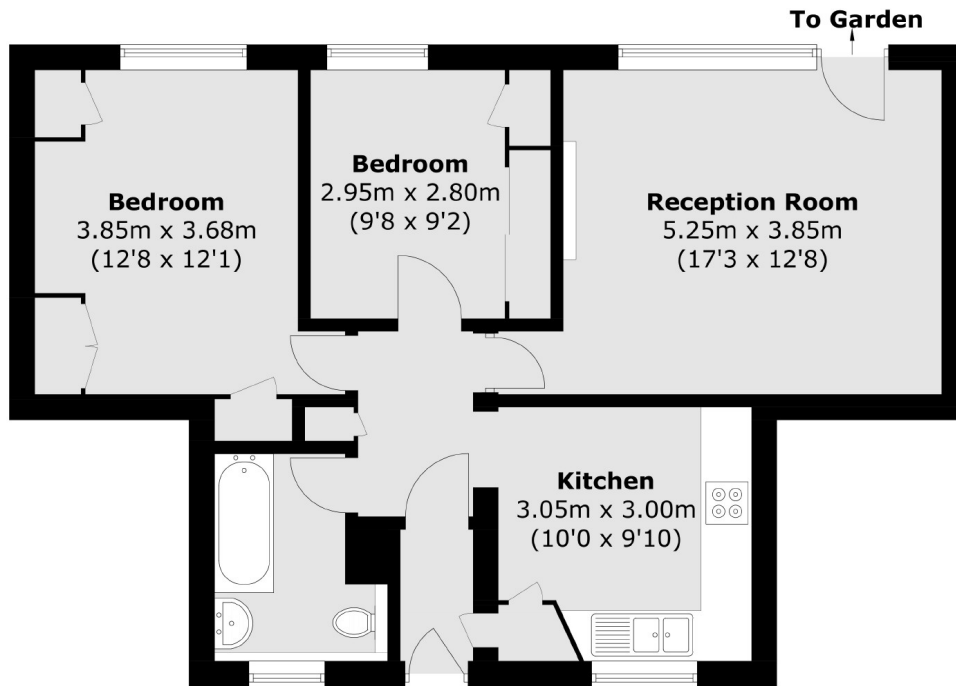

Total area (approx.): 61.7 sq. m (664.1 sq. ft)

Snellers St. Margarets Sales
36 Crown Road
St Margarets
TW1 3EH
020 8892 8008
stmargaretssales@snellers.co.uk

Energy Rating: C We aim to make our particulars both accurate and reliable. However they are not guaranteed; nor do they form part of an offer or contract. If you require clarification on any points then please contact us, especially if you're traveling some distance to view. Please note that appliances and heating systems have not been tested and therefore no warranties can be given as to their good working order