

## Worton Road, TW7

£395,000

Offered to the market with no onward chain is this charming and characterful two bedroom end of terrace Victorian family home set on this popular residential road in Isleworth.

Worton Road is a popular residential location, moments away from transport links, local amenities and within easy reach of excellent schools nearby.

- End of Terrace • Victorian • Two Bedrooms •
- Private Courtyard • Ideal for First Time Buyers or Investors • No Chain •

# SNELLERS

ESTATE AGENTS

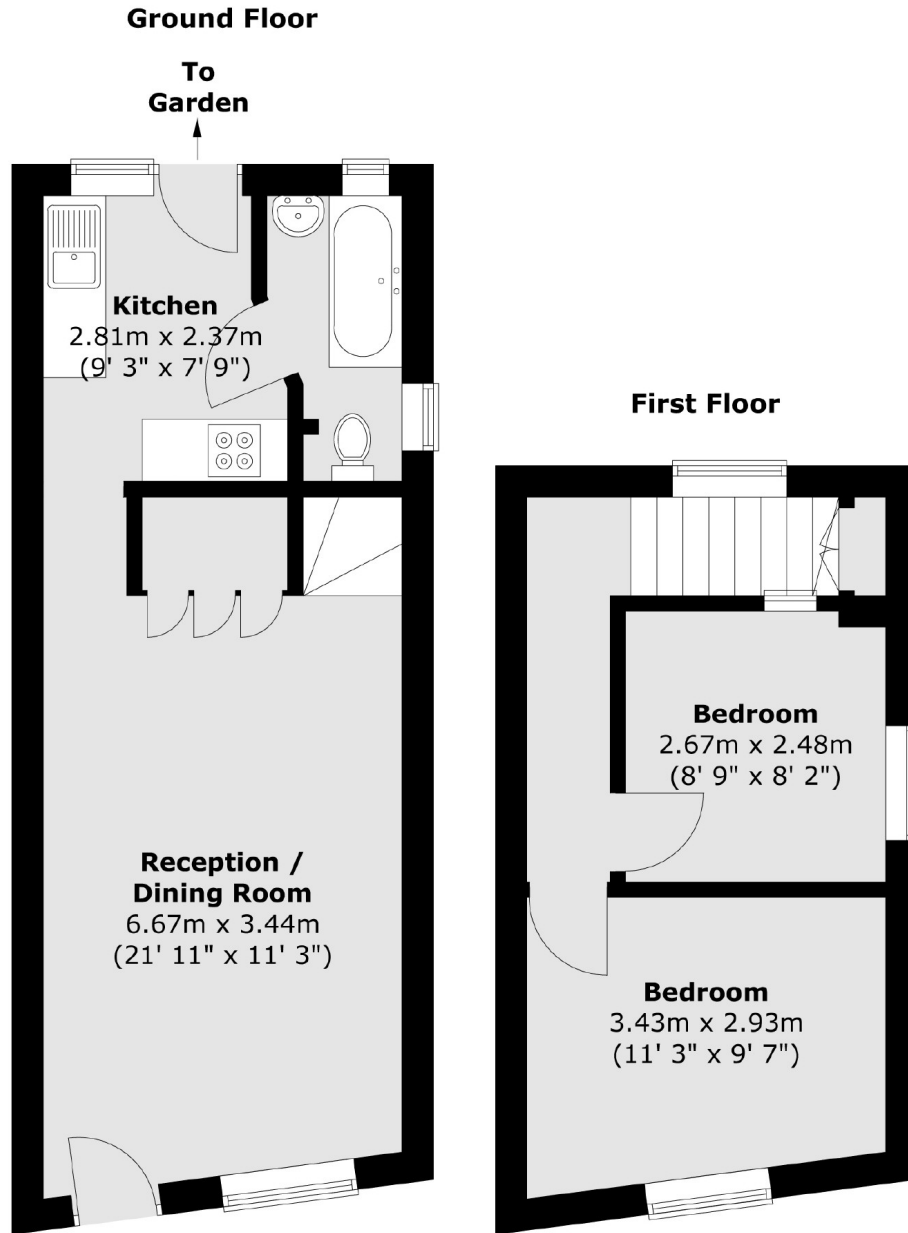

Total area (approx.) : 55.4 sq. m (596 sq. ft)

Snellers St. Margarets Sales  
36 Crown Road  
St Margarets  
TW1 3EH  
020 8892 8008  
stmargaretssales@snellers.co.uk

Energy Rating: We aim to make our particulars both accurate and reliable. However they are not guaranteed; nor do they form part of an offer or contract. If you require clarification on any points then please contact us, especially if you're traveling some distance to view. Please note that appliances and heating systems have not been tested and therefore no warranties can be given as to their good working order