

# SNELLERS

ESTATE AGENTS



## Cambridge Park, TW1

£435,000

Set within this highly sought after private gated development is this one double bedroom third floor apartment including allocated parking, a study and no onward chain situated within this Art Deco mansion block.

Further benefits include the share of freehold, a private tennis court and approximately seven acres of landscaped communal gardens leading down to the River Thames.

Meadowside is a private gated development set by the River Thames within quarter of mile of Richmond town centre and mainline station with fast links into London Waterloo.

- One Double Bedroom • Allocated Parking • Additional Room/ Study •
- Share of Freehold • Riverside Gated Development • No Chain •

# SNELLERS

ESTATE AGENTS

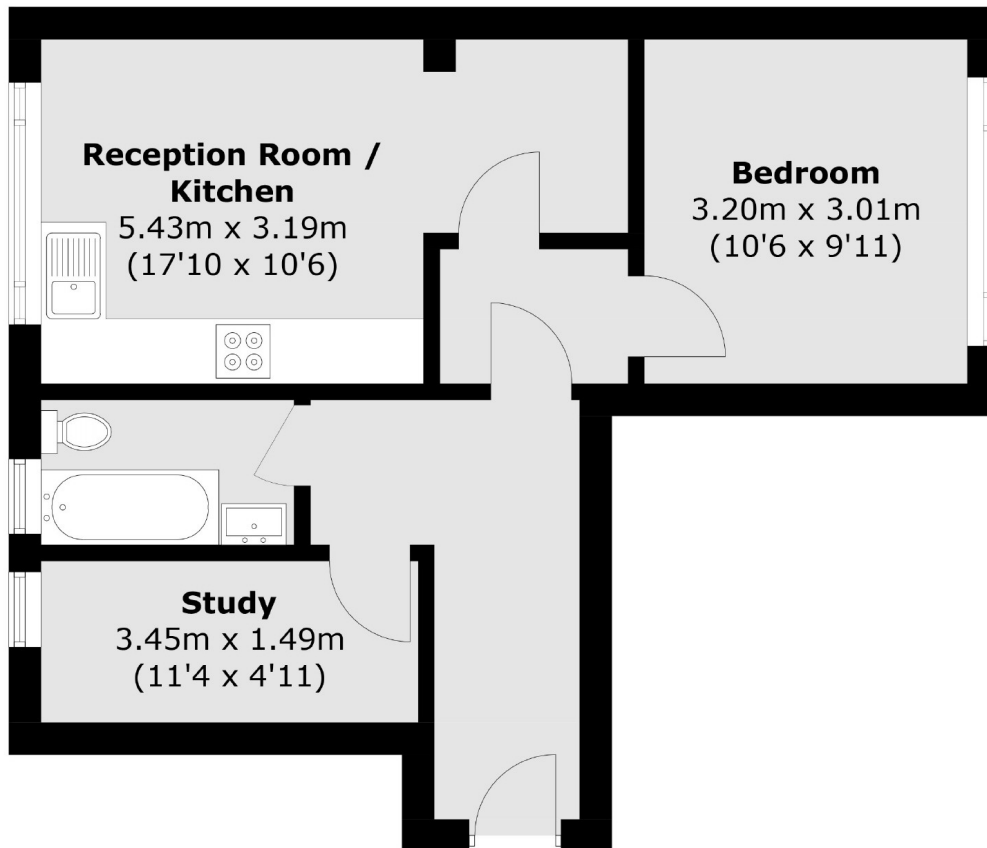

Total area (approx.): 44.6 sq. m (480.1 sq. ft)

Snellers St. Margarets Sales  
36 Crown Road  
St Margarets  
TW1 3EH  
020 8892 8008  
[stmargaretssales@snellers.co.uk](mailto:stmargaretssales@snellers.co.uk)

Energy Rating: We aim to make our particulars both accurate and reliable. However they are not guaranteed; nor do they form part of an offer or contract. If you require clarification on any points then please contact us, especially if you're traveling some distance to view. Please note that appliances and heating systems have not been tested and therefore no warranties can be given as to their good working order