

SNELLERS

ESTATE AGENTS



Beaumont Place, TW7

£275,000

Set within this private development and offered to the market with no onward chain is this well presented, two bedroom apartment suitably located between Twickenham and St Margarets.

Beaumont Place is conveniently located between Twickenham and St Margarets train station, moments away from local amenities and good local schools.

- Private Development • Two Bedrooms • Good Condition •
- Communal Gardens • Allocated Parking • No Chain •

SNELLERS

ESTATE AGENTS

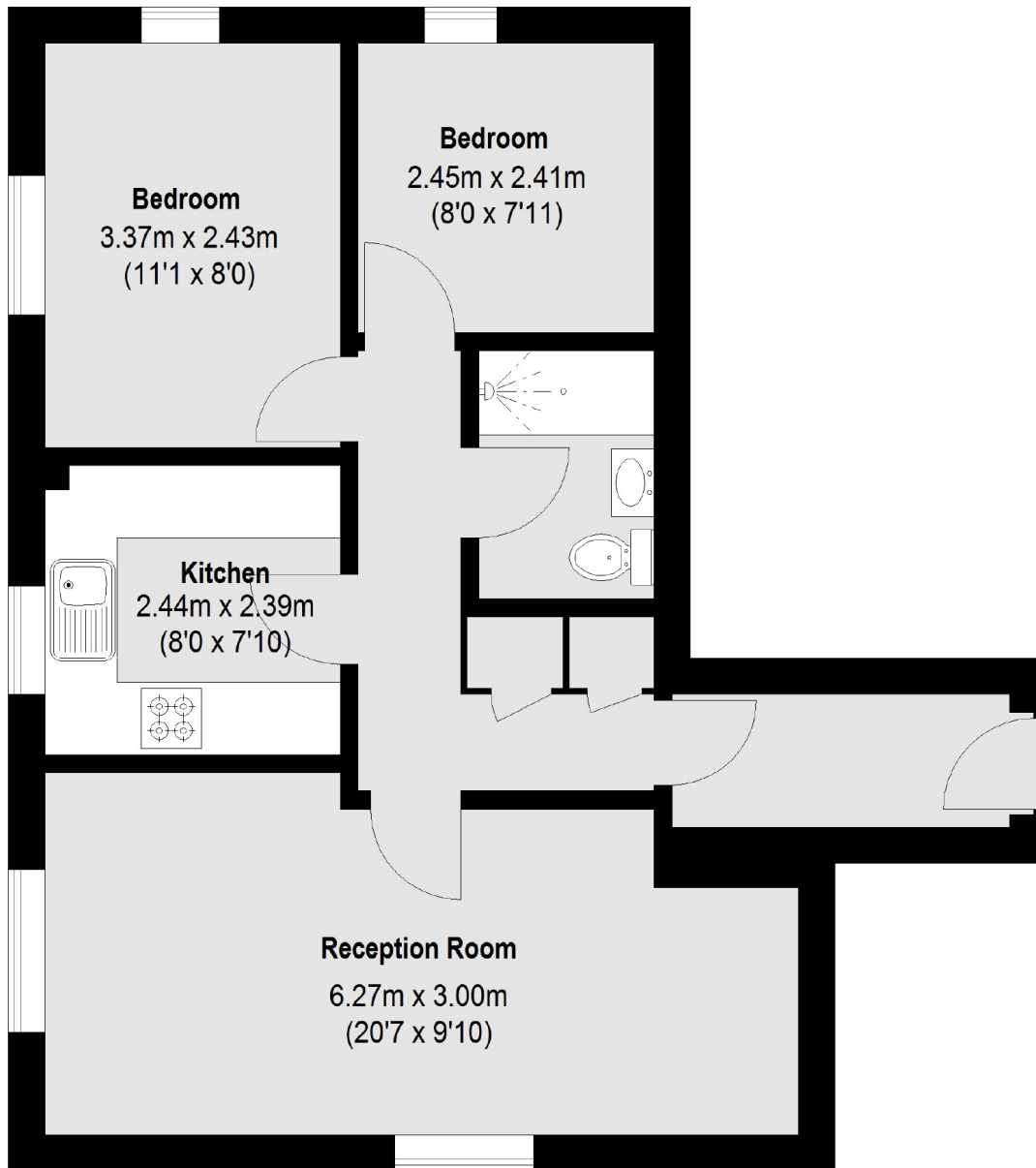

Total area (approx.): 52.2 sq. m (562 Sq. ft)

Snellers St. Margarets Sales
36 Crown Road
St Margarets
TW1 3EH
020 8892 8008
stmargaretssales@snellers.co.uk

Energy Rating: We aim to make our particulars both accurate and reliable. However they are not guaranteed; nor do they form part of an offer or contract. If you require clarification on any points then please contact us, especially if you're traveling some distance to view. Please note that appliances and heating systems have not been tested and therefore no warranties can be given as to their good working order