

# SNELLERS

ESTATE AGENTS



## White Lodge Close, TW7

£275,000

Offered to the market with no onward chain is this well presented, one double bedroom second floor apartment with allocated parking set within this modern exclusive development in Isleworth.

White Lodge Close is a modern development built in 2003 set moments away from the local amenities of Old Isleworth, the River Thames and is within easy reach of Syon Park and Isleworth train stations as well as being within the vicinity of top local schools and West Middlesex Hospital.

- Second Floor • One Double Bedroom • Long Lease •
- Allocated Parking • Excellent Location • No Chain •

## Second Floor

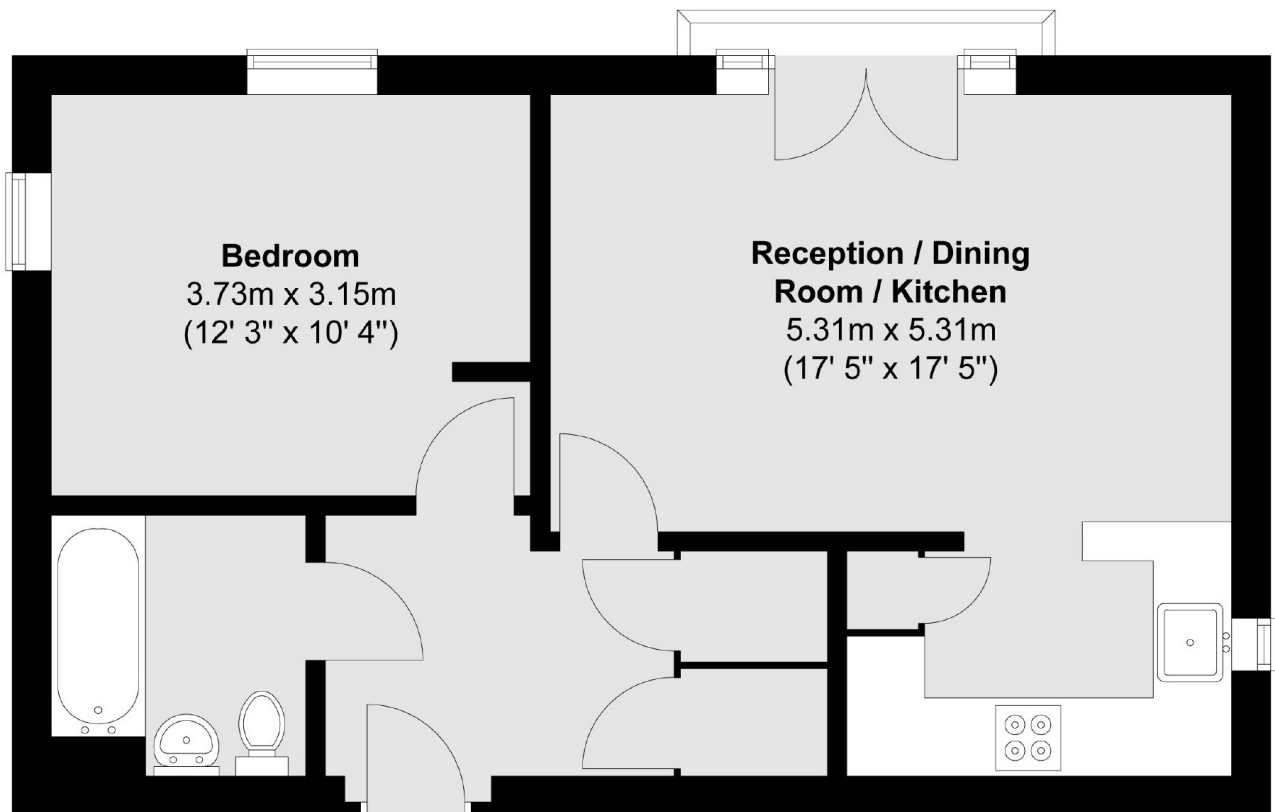

Total area (approx.) : 49.3 sq. m (531 sq. ft)  
Total balcony area (approx.) : 0.7 sq. m (7 sq. ft)

Snellers St. Margarets Sales  
36 Crown Road  
St Margarets  
TW1 3EH  
020 8892 8008  
[stmargaretssales@snellers.co.uk](mailto:stmargaretssales@snellers.co.uk)

Energy Rating: We aim to make our particulars both accurate and reliable. However they are not guaranteed; nor do they form part of an offer or contract. If you require clarification on any points then please contact us, especially if you're traveling some distance to view. Please note that appliances and heating systems have not been tested and therefore no warranties can be given as to their good working order