

Frankswood Avenue

West Drayton • Middlesex • UB7 8QS

Offers In Excess Of: £395,000



coopers
est 1986

Frankswood Avenue

West Drayton • Middlesex • UB7 8QS

Nestled away in a quiet Cul-De-Sac in Yiewsley, this three bedroom middle terrace home represents an excellent opportunity for those looking to take their next step on the property ladder whilst also still being a good investment opportunity. The accommodation on offer consists of hallway, cloakroom, a 15ft living room and an equally spacious 14ft kitchen/breakfast room. To the first floor are the three bedrooms, two of which are benefiting from fitted wardrobes whilst also upstairs is the family bathroom.

Three bedroom

Terraced

Quiet location

Modernisation required

Potential to extend (STPP)

15ft Living room

13ft Master bedroom

Garage

No chain

14ft Kitchen

These particulars are intended as a guide and must not be relied upon as statements of fact. Your attention is drawn to the Important Notice on the last page.





Property

Nestled away in a quiet Cul-De-Sac in Yiewsley, this three bedroom middle terrace home represents an excellent opportunity for those looking to take their next step on the property ladder whilst also still being a good investment opportunity. The accommodation on offer consists of hallway, cloakroom, a 15ft living room and an equally spacious 14ft kitchen/breakfast room. To the first floor are the three bedrooms, two of which are benefiting from fitted wardrobes whilst also upstairs is the family bathroom.

Outside

There is a garage fit for parking and a garden at the rear of the property with a patio area, as well as a rear entrance into the garden.

Location

Frankswood Avenue, is a popular residential road that is extremely well placed, providing good access to Hillingdon Hospital, Stockley Business Park & Heathrow Airport. West Drayton High Street with its variety of shops and Train Station (Crossrail) can also be found close by.





Schools:

Rabbsfarm Primary School 0.3 miles
Colham Manor Primary School 0.4 miles
St Matthew's CoFE Primary School 0.5 miles



Train:

West Drayton Station 0.6 miles
Iver Station 1.9 miles
Uxbridge Station 2.0 miles



Car:

M4, A40, M25, M40



Council Tax Band:

D

(Distances are straight line measurements from centre of postcode)



OUTBUILDING
135 sq.ft. (12.5 sq.m.) approx.



GROUND FLOOR
379 sq.ft. (35.2 sq.m.) approx.

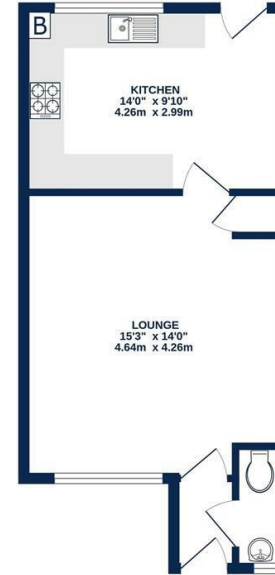

1ST FLOOR
343 sq.ft. (31.9 sq.m.) approx.

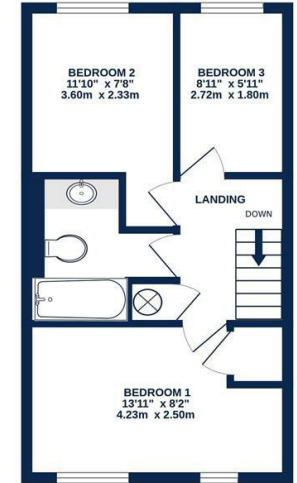

TOTAL FLOOR AREA : 857 sq.ft. (79.6 sq.m.) approx.

Whilst every attempt has been made to ensure the accuracy of the floorplan contained here, measurements of doors, windows, rooms and any other items are approximate and no responsibility is taken for any error, omission or mis-statement. This plan is for illustrative purposes only and should be used as such by any prospective purchaser. The services, systems and appliances shown have not been tested and no guarantee as to their operability or efficiency can be given.
Made with Metropix ©2024

01895 459 950

1 Tavistock Road, West Drayton,
Middlesex, UB7 7QT

westdrayton@coopersresidential.co.uk

CoopersResidential.co.uk

coopers
est 1986

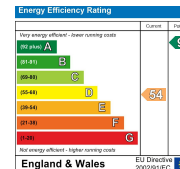

Important Notice: These particulars, whilst believed to be accurate are set out as a general outline only for guidance and do not constitute any part of an offer or contract. Intending purchasers should not rely on them as statements or representation of fact, but must satisfy themselves by inspection or otherwise has the authority to make or give any representation or warranty in respect of the property.