

Harefield Road

Uxbridge • Middlesex • UB8 1PL

Guide Price: £230,000



coopers
est 1986

Harefield Road

Uxbridge • Middlesex • UB8 1PL

A spacious top floor apartment set within this elegant period building and located a couple of minutes walk from Uxbridge Town Centre. This apartment comprises of a spacious lounge, fully fitted kitchen with appliances, modern bathroom, large double bedroom and good storage throughout. Benefits include double glazing, an allocated parking space and further parking can be obtained via Hillingdon Council permit parking.

Top floor apartment

One bedroom

Walking distance to the town centre

Allocated off street parking

Characteristic home

Modern bathroom

Fitted kitchen

No onward chain

Transport links nearby

Desirable location in North Uxbridge

These particulars are intended as a guide and must not be relied upon as statements of fact. Your attention is drawn to the Important Notice on the last page.





Property

A well presented first floor one bedroom apartment situated a stones throw from Uxbridge Town Centre. This periodic converted Victorian house offers over 460sqft across a generously spacious living space making it a perfect first time purchase or ideal investment for those seeking high returns.

Location

The property offers easy access to the High Street providing a lifestyle of pure convenience. Uxbridge High Street benefits from The Chimes and Pavilions shopping malls, a number of popular restaurants such as Wagamama and Nando's, vibrant bars and Uxbridge Tube Station with its Metropolitan and Piccadilly lines into Central London. Uxbridge offers excellent transport links with easy access to the M40, M25 and M4 motorways and is also close to Heathrow airport, Hillingdon Hospital, Brunel University and Stockley Park. The area is served by a number well-regarded schools infant, primary and secondary schools and walking distance to Hillingdon Leisure Centre.

Outside

To the front there is allocated parking providing off street parking.



Schools:

Hermitage Primary School 0.3 miles
St Mary's Catholic Primary School 0.5 miles
Uxbridge College 0.5 miles



Train:

Uxbridge Station 0.5 miles
Hillingdon Station 2.2 miles
Ickenham Station 2.4 miles



Car:

M4, A40, M25, M40



Council Tax Band:

C

(Distances are straight line measurements from centre of postcode)

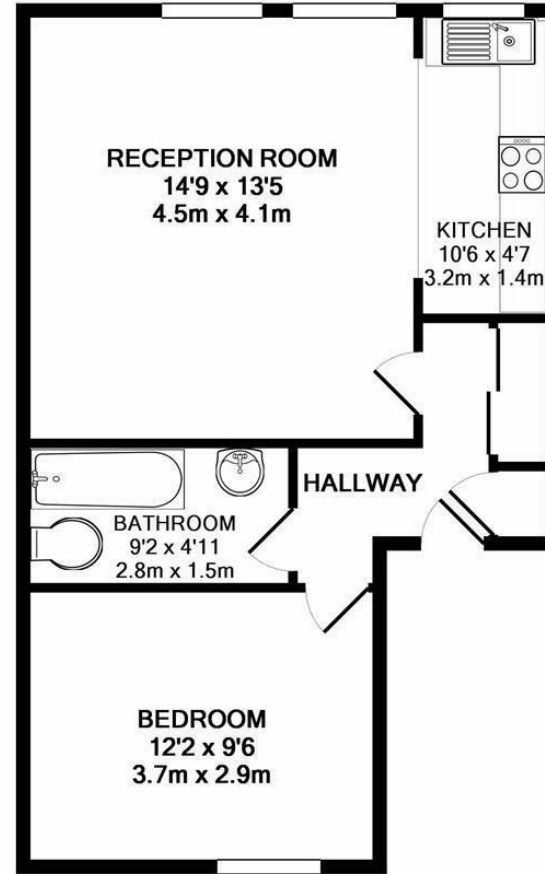
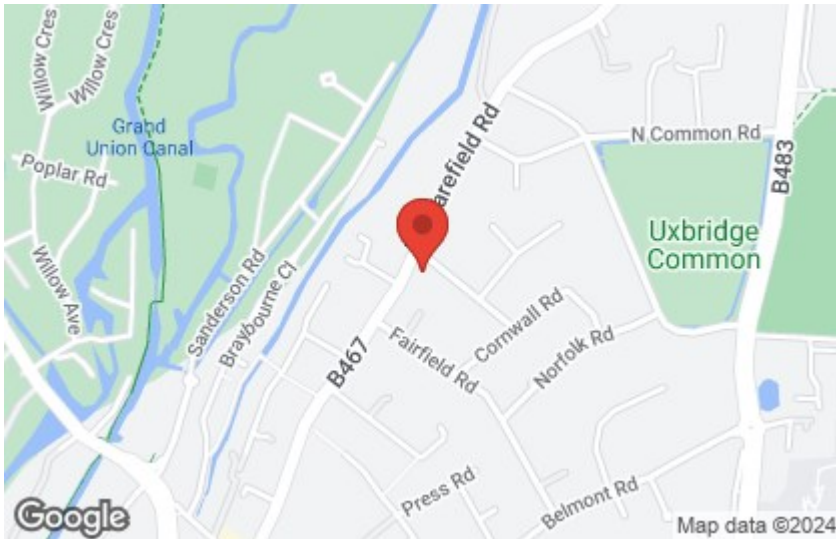

TOTAL APPROX. FLOOR AREA 462 SQ.FT. (42.9 SQ.M.)

Whilst every attempt has been made to ensure the accuracy of the floor plan contained here, measurements of doors, windows, rooms and any other items are approximate and no responsibility is taken for any error, omission, or mis-statement. This plan is for illustrative purposes only and should be used as such by any prospective purchaser. The services, systems and appliances shown have not been tested and no guarantee as to their operability or efficiency can be given

Made with Metropix ©2017

01895 257 566

1 Vine Street, Uxbridge,
Middlesex, UB8 1QE

us@coopersresidential.co.uk

CoopersResidential.co.uk

coopers
est 1986

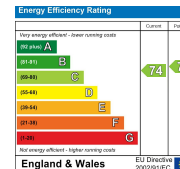

Important Notice: These particulars, whilst believed to be accurate are set out as a general outline only for guidance and do not constitute any part of an offer or contract. Intending purchasers should not rely on them as statements or representation of fact, but must satisfy themselves by inspection or otherwise has the authority to make or give any representation or warranty in respect of the property.