



FOR SALE

6 Southcombe Way, Tintinhull, BA22 8QF

£250,000



ORCHARDS
ESTATES

Score	Energy rating	Current	Potential
92+	A		
81-91	B		
69-80	C	69 C	83 B
55-68	D		
39-54	E		
21-38	F		
1-20	G		

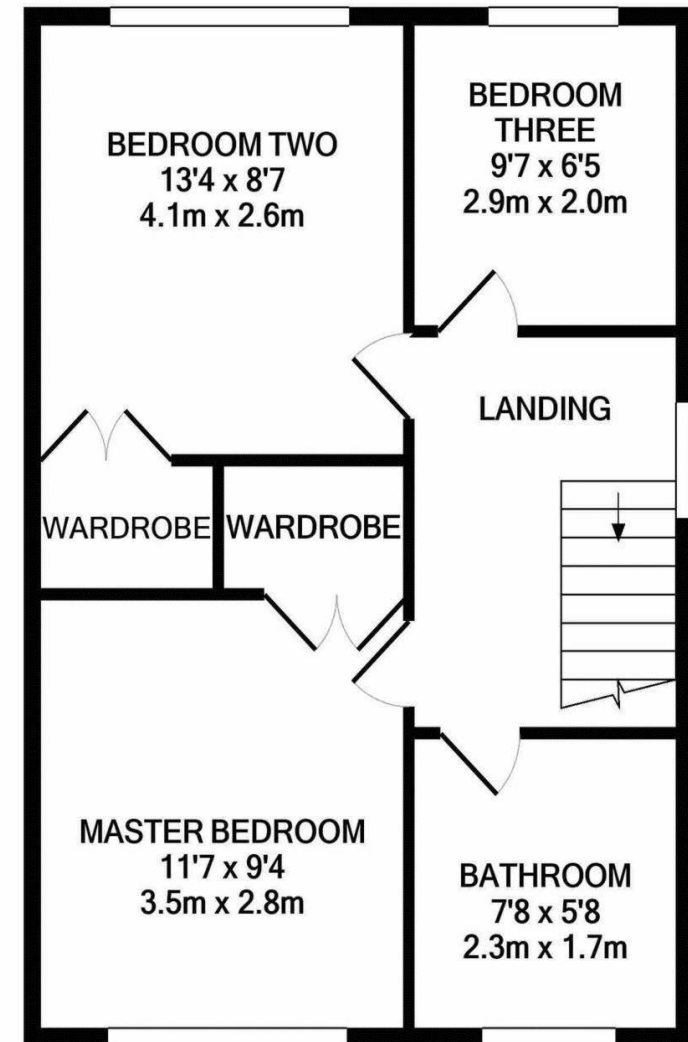
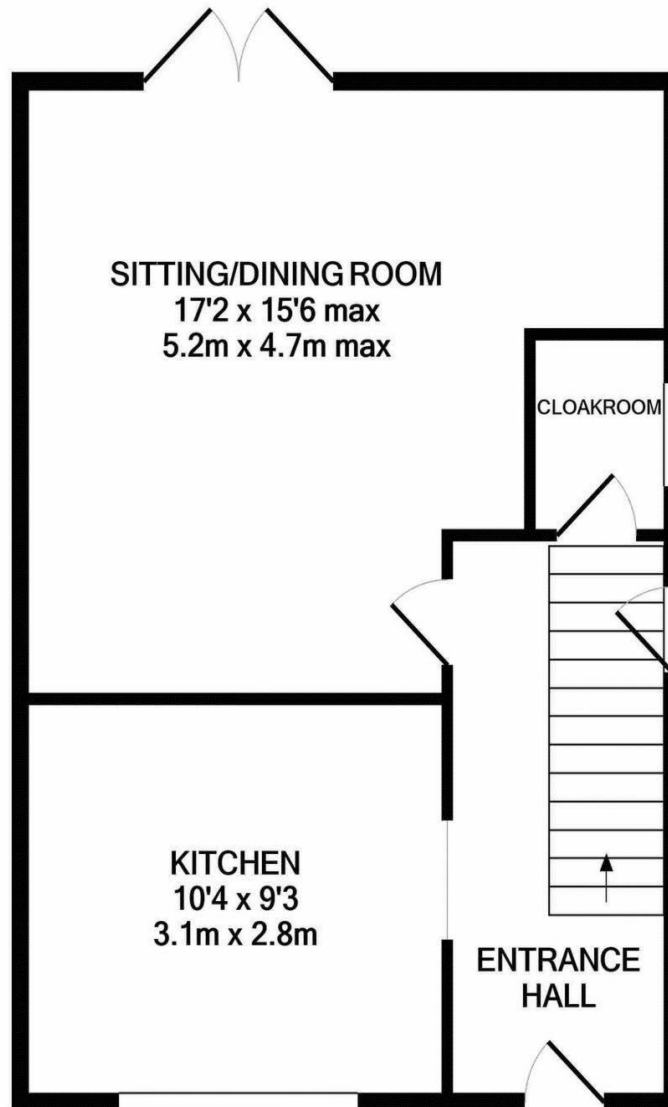

01460 477977 or 01935 277977



www.orchardsestates.com



ORCHARDS
ESTATES

Orchards Estates, 17 North Street Workshops, Stoke Sub Hamdon, TA14 6QR

Consumer Protection from Unfair Regulations 2008: The Agents has not tested any apparatus, equipment, fixtures and fittings, or services, so cannot verify that they are in working order or fit for the purpose. The buyer is advised to obtain verification from his or her Professional Buyer. References to the Tenure of the property are based on information supplied by the Vendor. The agents have not had sight of the title documents. The buyer is advised to obtain verification from their Solicitor. You are advised to check the availability of any property before travelling any distance to view.