



BRITISH
PROPERTY
AWARDS

2020 - 2021
★ ★ ★ ★ ★

GOLD WINNER

LETTING AGENT
IN LEIGH-ON-SEA



BRITISH
PROPERTY
AWARDS

2018 - 2019
★ ★ ★ ★ ★

GOLD WINNER

LETTING AGENT
IN LEIGH ON SEA



BRITISH
PROPERTY
AWARDS

2017
★ ★ ★ ★ ★

GOLD WINNER

ESTATE AGENT
IN LEIGH-ON-SEA



London Road, Leigh on Sea

DETACHED BUNGALOW: Castle Estate Agents are proud to offer FOR RENT this 1 BEDROOM detached BUNGALOW set in this IDEAL location and within easy walking distance to LEIGH STATION, SEA FRONT, BROADWAY, SHOPS, BARS, RESTAURANTS and BUS ROUTES, This property has many benefits including a PARKING SPACE.

- 1 Double bedroom
- New flooring
- Parking space
- Walk to the Broadway
- Double glazed
- Detached bugalow
- Newly painted
- Walk to Leigh Station
- Walk to sea front
- On local bus routes

£1250 PCM

Front aspect

Double glazed front door with frosted glass insets to:

Hallway

Doors to all rooms, power points, radiator, carpeted.

Lounge area 16' 6" by 9' 2" (5m 3cm by 2m 79cm), ()

Double glazed window to front aspect, power points, tv point, radiator, laminated wood flooring, door to:

Bedroom 16' 7" by 8' 1" (5m 5cm by 2m 46cm), ()

Double glazed window to the front aspect, new carpeted, loft access, power points, radiator.

Kitchen 7' by 6' 5" (2m 13cm by 1m 96cm), ()

White eye level and base level units, roll top work surfaces, electric cooker, enamel sink and single drainer with mixer taps, stripped lighting, double glazed window to the front aspect, carpeted, tiled splash backs, power points, washing machine and space fridge freezer.

Shower room

Extractor fan, fully tiled, new flooring, 2 piece white suite comprising of a hand wash basin, shower cubicle with wall mounted electric shower, radiator, new flooring.

Seperate wc

Low level flush toilet, hand wash basing, double glazed frosted window to rear aspect, wall mounted boiler, radiator.



Whilst we endeavour to make our sales particulars as accurate and reliable as possible, if there is any point which is of particular importance to you, please contact the office and we will be pleased to check the information. The mention of any appliances and/or services in these details does not imply that these are in full and efficient working order or have been inspected by ourselves. Please be advised that some of the particulars may be awaiting vendor approval. Please contact us should you have any queries and we will try our utmost to assist.

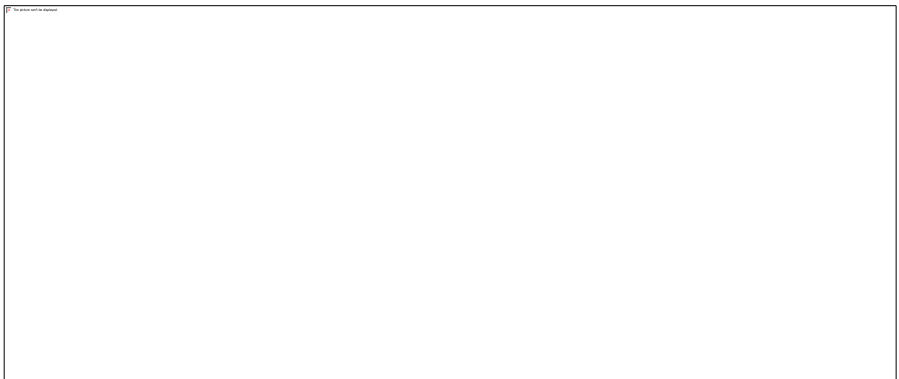

Whilst we endeavour to make our sales particulars as accurate and reliable as possible, if there is any point which is of particular importance to you, please contact the office and we will be pleased to check the information. The mention of any appliances and/or services in these details does not imply that these are in full and efficient working order or have been inspected by ourselves. Please be advised that some of the particulars may be awaiting vendor approval. Please contact us should you have any queries and we will try our utmost to assist.

GROUND FLOOR

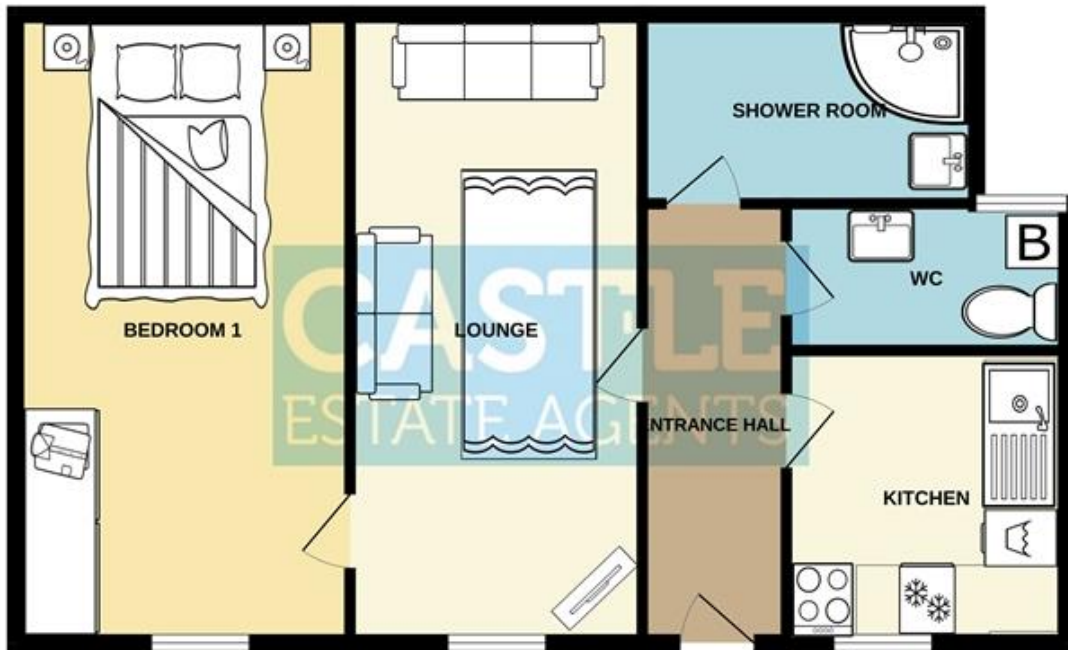

Whilst every attempt has been made to ensure the accuracy of the floorplan contained here, measurements of doors, windows, rooms and any other items are approximate and no responsibility is taken for any error, omission or mis-statement. This plan is for illustrative purposes only and should be used as such by any prospective purchaser. The services, systems and appliances shown have not been tested and no guarantee as to their operability or efficiency can be given.
Made with Meripix ©2024

Whilst we endeavour to make our sales particulars as accurate and reliable as possible, if there is any point which is of particular importance to you, please contact the office and we will be pleased to check the information. The mention of any appliances and/or services in these details does not imply that these are in full and efficient working order or have been inspected by ourselves. Please be advised that some of the particulars may be awaiting vendor approval. Please contact us should you have any queries and we will try our utmost to assist.