

67 Bartholomews Square, Horfield, Bristol, BS7 0QB

Sold @ Auction £530,000



- FOR SALE BY ONLINE AUCTION
- WEDNESDAY 16TH OCTOBER 2024
- VIDEO TOUR NOW ONLINE
- VIEWINGS - REFER TO DETAILS
- DOWNLOAD FREE LEGAL PACK
- SOLD @ OCTOBER ONLINE AUCTION
- FREEHOLD SEMI DETACHED HOUSE
- LICENSED HMO | £54,936 pa
- 6 BEDS | 4 BATH | GARAGE | GARDEN
- EXTENDED 8 WEEK COMPLETION

Hollis Morgan - OCTOBER LIVE ONLINE AUCTION – A Freehold MODERN SEMI DETACHED 6 BED | 4 BATH HOUSE | PARKING (1508 Sq Ft) arranged as LICENSED HMO | Fully let producing £54,936 pa

67 Bartholomews Square, Horfield, Bristol, BS7 0QB

Accommodation

FOR SALE BY LIVE ONLINE AUCTION

*** SOLD @ OCTOBER ONLINE AUCTION ***

GUIDE £525,000 +++
SOLD PRIOR @ £530,000

ADDRESS | 67 Bartholomews Square, Horfield, Bristol BS7 0QB

Lot Number 24

The Live Online Auction is on Wednesday 16th October 2024 @ 17:30
Registration Deadline is on Monday 14th October 2024 @ 16:00

The Auction will be streamed LIVE ONLINE via the Hollis Morgan website & you can chose to bid by telephone, proxy or via your computer.
Registration is a simple online process – please visit the Hollis Morgan auction website and click “REGISTER TO BID”

THE PROPERTY

A Freehold modern semi detached town house with accommodation (1508 Sq Ft) arranged over 3 floors with open plan living space / communal area, 6 bedrooms and 4 bathrooms (2 en suite) plus generous rear garden, integral garage and allocated off street parking x 2
Sold subject to existing tenancies.

Tenure - Freehold

Council Tax - D

EPC - C

Utilities, Rights & Restrictions - Please refer to the Legal Pack

Flood Risk - Please refer to the Legal Pack

THE OPPORTUNITY

HMO INVESTMENT | £54,936 pa

The property is a fully licensed 6 bedroom HMO let for the 2024 / 2025 academic year to UWE students on an AST contract terminating August 12th 2025.

£4,578 pcm | £54,936 pa

Tenants pay all bills.

Please refer to online legal pack for copies of AST contracts.

GARAGE | ROOM 7

There may be scope to create an additional 7th bedroom by converting the integral garage.
Subject to consents.

LOCATION

Situated in the popular Bartholomews Square, the property is within close walking distance to Horfield Common, Horfield Leisure Centre and Gloucester Road with its wealth of amenities. It is also ideally situated for UWE or Southmead Hospital with major employers such as Airbus and the MOD close by.

Floor plan

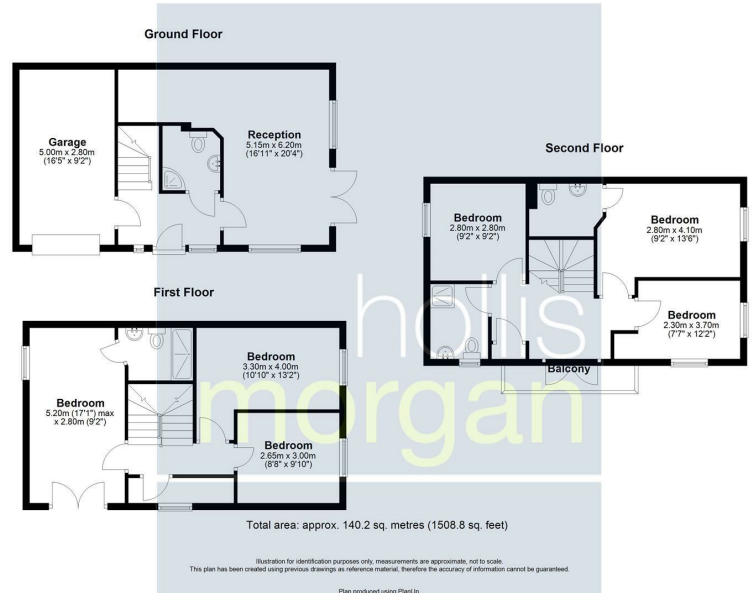

EPC Chart

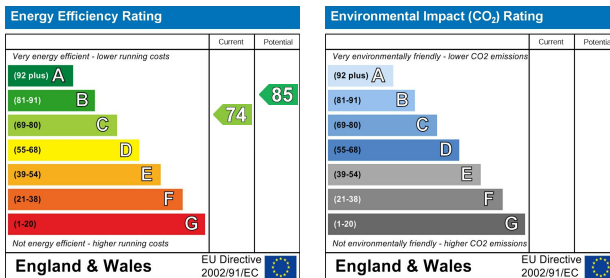

9 Waterloo Street

Clifton

Bristol

BS8 4BT

Tel: 0117 973 6565

Email: post@hollismorgan.co.uk

www.hollismorgan.co.uk

Hollis Morgan Property Limited, registered in England, registered 7275716.

Registered address, 5 Upper Belgrave Road, Clifton, Bristol BS8 2XQ

Auction Property Details Disclaimer

Hollis Morgan endeavour to make our sales details clear, accurate and reliable in line with the Consumer Protection from Unfair Trading Regulations 2008 but they should not be relied on as statements or representations of fact.

Please refer to our website for further details.