

Somerset House, 20 Lower Kewstoke Road, Worle, Weston-

Auction Guide Price +++ £335,000



- FOR SALE BY ONLINE AUCTION
- WEDNESDAY 15TH MAY 2024
- VIDEO TOUR NOW ONLINE
- VIEWINGS - REFER TO DETAILS
- LEGAL PACK COMPLETE
- MAY LIVE ONLINE AUCTION
- FREEHOLD DETACHED FAMILY HOME
- UPDATING | CHARM & CHARACTER
- POSSIBLE BUILDING PLOT | FLATS
- EXTENDED 8 WEEK COMPLETION

Hollis Morgan - MAY LIVE ONLINE AUCTION - An elevated Freehold DETACHED PERIOD PROPERTY (2463 Sq Ft) in need of UPDATING with scope for a stunning FAMILY HOME.

Somerset House, 20 Lower Kewstoke Road, Worle, Weston-Super-Mare, BS22 9JF

Accommodation

FOR SALE BY LIVE ONLINE AUCTION

ADDRESS | Somerset House, 20 Lower Kewstoke Road, Worle, North Somerset BS22 9JF

Lot Number 14

The Live Online Auction is on Wednesday 15th May 2024 @ 17:30
Registration Deadline is on Monday 13th May 2024 @ 16:00

The Auction will be streamed LIVE ONLINE via the Hollis Morgan website & you can choose to bid by telephone, proxy or via your computer. Registration is a simple online process – please visit the Hollis Morgan auction website and click “REGISTER TO BID”

THE PROPERTY

Somerset House occupies an elevated position moments from Worle High Street and just 3 miles from Weston Sea Front. This imposing detached 5 / 6 bedroom property is approximately 200 years old (not listed) and we understand during the 1800's it provided a landmark as a lighthouse, being on the crest of the hill, for Wayfarers travelling from Woodspring Priory to the old port of Kewstoke. The accommodation (2463 Sq Ft) has charm and character, retaining many of the original features including inglenook fireplaces and exposed beams, is arranged over 3 floors with flexible and spacious accommodation. Outside are generous gardens to the side and rear and vehicular access (via the lane) to the large detached garage.

Tenure - Freehold

Council Tax - D

EPC - E

Utilities, Rights & Restrictions - Please refer to the Legal Pack

Flood Risk - Please refer to the Legal Pack

Floor plan

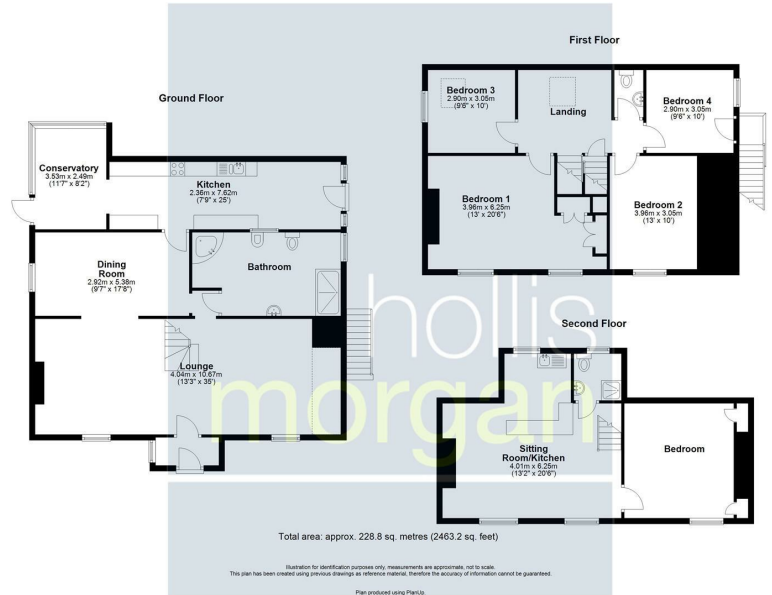

EPC Chart

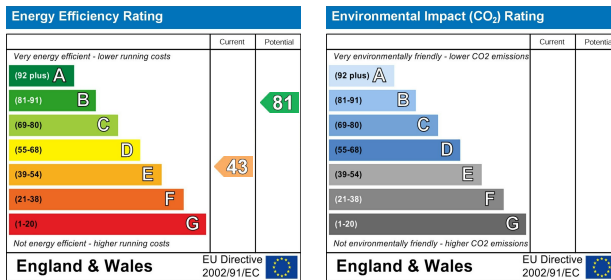

9 Waterloo Street

Clifton

Bristol

BS8 4BT

Tel: 0117 973 6565

Email: post@hollismorgan.co.uk

www.hollismorgan.co.uk

Hollis Morgan Property Limited, registered in England, registered 7275716.

Registered address, 5 Upper Belgrave Road, Clifton, Bristol BS8 2XQ

Auction Property Details Disclaimer

Hollis Morgan endeavour to make our sales details clear, accurate and reliable in line with the Consumer Protection from Unfair Trading Regulations 2008 but they should not be relied on as statements or representations of fact.

Please refer to our website for further details.