

3 River View, Snuff Mills | Stapleton, Bristol, BS16 1DL

Auction Guide Price +++ £250,000



- FOR SALE BY ONLINE AUCTION
- VIDEO TOUR NOW ONLINE
- LEGAL PACK COMPLETE
- WEDNESDAY 15TH MAY 2024
- VIEWINGS - REFER TO DETAILS
- MAY LIVE ONLINE AUCTION
- FREEHOLD PERIOD COTTAGE
- WITH POTENTIAL
- REDUCED | ORIGINALLY £375K
- EXTENDED 8 WEEK COMPLETION

Hollis Morgan – MAY LIVE ONLINE AUCTION – A Freehold 2 BED PERIOD COTTAGE (841 Sq Ft) with enclosed REAR GARDEN at a REDUCED PRICE for sale by auction.

3 River View, Snuff Mills | Stapleton, Bristol, BS16 1DL

Accommodation

FOR SALE BY LIVE ONLINE AUCTION

ADDRESS | 3 River View, Snuff Mills, Stapleton, Bristol BS16 1DL

Lot Number 2

The Live Online Auction is on Wednesday 15th May 2024 @ 17:30
Registration Deadline is on Monday 13th May 2024 @ 16:00

The Auction will be streamed LIVE ONLINE via the Hollis Morgan website & you can chose to bid by telephone, proxy or via your computer. Registration is a simple online process – please visit the Hollis Morgan auction website and click “REGISTER TO BID”

THE PROPERTY

A Freehold 2 bedroom period cottage located just moments from the River Frome and walks in Snuff Mills, Stoke Park and Eastgate Park. The accommodation (841 Sq Ft) is arranged over two floors with a downstairs WC and enclosed rear garden with shed.

Tenure - Freehold

Council Tax - B

EPC - D

Utilities, Rights & Restrictions - Please refer to the Legal Pack

Flood Risk - Please refer to the Legal Pack

THE OPPORTUNITY

COTTAGE

There is scope to convert the attic space to create further accommodation subject to consents.

REDUCED PRICE FOR AUCTION

The property was originally listed with local agents for £375,000 and most recently £325,000 is now offered with a reduced guide price for sale by auction.

LOCATION

The property is conveniently located close to Snuff Mills & Oldbury Court Estate, combining woodland and riverside paths with historic parkland and excellent children's play facilities. Just 3 miles from Bristol city centre and offers excellent transport links onto The Ring Road and motorway networks. The property is situated just a stones throw away from Snuff Mills and the river Frome, offering idyllic walks with good access to the Bristol City Centre, motorway net work, MOD, Airbus, Rolls Royce and Cribbs Causeway. Local shops and amenities can be found on Fishponds Road with a wide range of independent bars and cafes.

SOLICITORS

Lydia Korn
Wards Solicitors
lydia.korn@wards.uk.com

EXTENDED COMPLETION

Completion is set for 8 weeks or earlier subject to mutual consent.

Floor plan

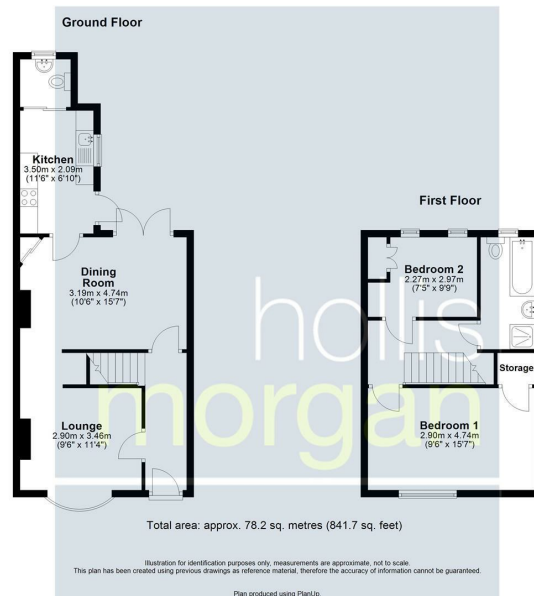

EPC Chart

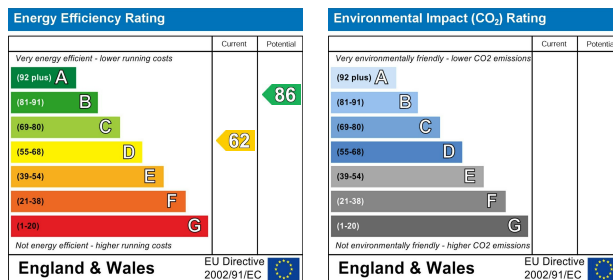

9 Waterloo Street

Clifton

Bristol

BS8 4BT

Tel: 0117 973 6565

Email: post@hollismorgan.co.uk

www.hollismorgan.co.uk

Hollis Morgan Property Limited, registered in England, registered 7275716.

Registered address, 5 Upper Belgrave Road, Clifton, Bristol BS8 2XQ

Auction Property Details Disclaimer

Hollis Morgan endeavour to make our sales details clear, accurate and reliable in line with the Consumer Protection from Unfair Trading Regulations 2008 but they should not be relied on as statements or representations of fact.

Please refer to our website for further details.