



RESIDENCE

22 Carrick Drive, Mount Vernon, G32 0RW

[www.residenceestateagents.co.uk](http://www.residenceestateagents.co.uk)



Viewing by appointment with Residence Uddingston

T: 01698 444222 | E: [uddingston@residencestateagents.co.uk](mailto:uddingston@residencestateagents.co.uk) | A: 61-63 Main Street, Uddingston, G71 7EP



RESIDENCE



## 4 Bedrooms | 2 Public Rooms | 2 Bathrooms



Exceptionally well finished and superbly sized lower conversion which is situated in arguably one of the best Streets in Mount Vernon.

"Rosebank" was built circa 1879 and was converted in the 1950s. The rooms retain lovely traditional features which are complimented by modern stylish decor with luxury floor coverings throughout, whilst the layout of the home provides great versatility and a wonderful balance of entertainment space and bedroom space. The large bright bay window lounge which extends to over twenty one feet, the wonderful recently upgraded kitchen has excellent base and wall mounted cupboard space. The separate sitting room to the front is ideal for those cosy nights and has dual aspects via double glazed windows to the front and side.

The accommodation in full comprises a large reception hallway, a formal bay window lounge, a sitting/dining room, a modern kitchen, a utility cupboard, four bedrooms, a principal en-suite shower room and a four piece family bathroom.

The rear garden is private with a lawn and decking space, which is ideal for entertaining. The front garden is laid to lawn with flowers and shrubs and a central pathway leading the grand entrance. Furthermore, the property benefits from off street parking via a driveway and a separate detached garage to the rear.

Mount Vernon is a popular residential pocket with excellent schools nearby in addition to parks, sports and shopping facilities and good transport links to the city centre. The village of Uddingston is only a short drive away and is highly regarded for its excellent main street where you can find the majority of everyday shopping needs.



1829.00 sq ft | EER = D



RESIDENCE





RESIDENCE





RESIDENCE







## Carrick Drive

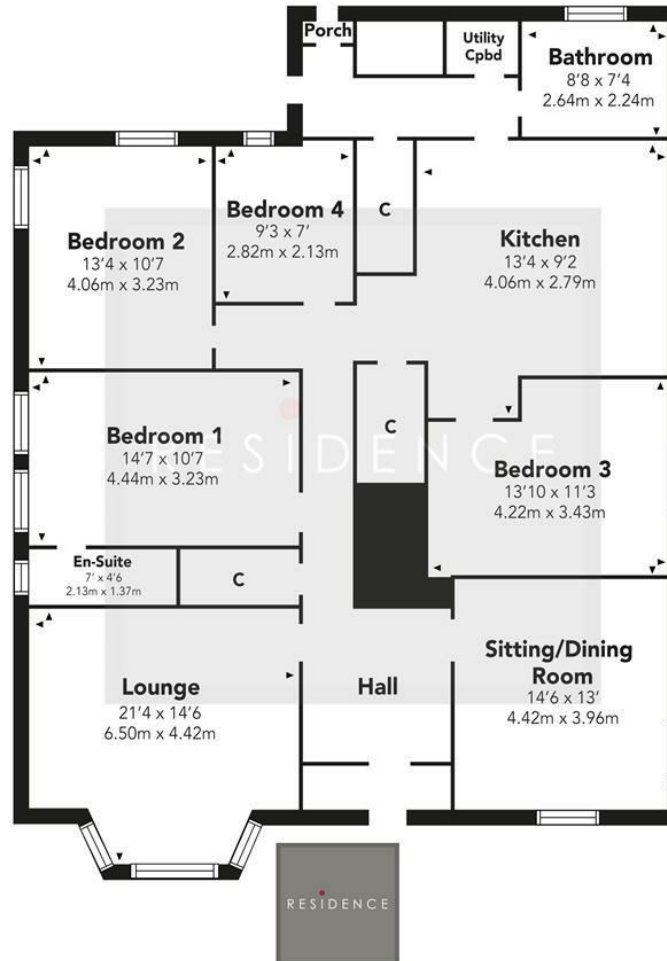

Floor Plan measurements are approximate and are for illustrative purposes only. While we do not doubt the floor plans accuracy, we make no guarantee, warranty or representation as to the accuracy and completeness of the floor plan. You or your advisors should conduct a careful, independent investigation of the property to determine to your satisfaction as to the suitability of the property for your space requirements.

Produced by Plush Plans Ltd

We believe these details to be accurate; however, they do not form any part of a contract. Fixtures and fittings are not included unless specified in the enclosed. Photographs are for general information and it must not be inferred that any item is included for sale with the property. All distances and measurements are approximate. Floorplans may not be to scale and are for illustration purposes only.