



Ringstone, Duxford Cambridge
£400,000 Freehold

**Sharman
Quinney**

Key Features



- Modern townhouse in quiet residential location
- Spacious light filled lounge
- Contemporary kitchen and dining area
- Four generous bedrooms including en-suite to the principal bedroom
- Private enclosed rear garden

The property opens with a welcoming entrance hall and convenient ground-floor WC. The spacious, light-filled lounge features doors leading to a stylish open-plan kitchen and dining area, perfect for modern living and entertaining.

Upstairs, the first floor offers two well-proportioned bedrooms, both with fitted wardrobes, and an en-suite to the principal bedroom.

The second floor provides two additional generous double bedrooms and a family bathroom, ideal for guests or growing families.

Outside, the rear garden is fully enclosed, low maintenance and laid to patio - ideal for outdoor dining with a garage situated beyond. The front garden is neatly maintained, featuring a lawn and



paved pathway.

Duxford is a highly desirable and historic village located just 10 miles south of Cambridge and 6 miles east of Royston. The village benefits from excellent transport connections, with easy access to the A505 and M11, as well as Whittlesford Parkway railway station, providing convenient rail links to both London and Cambridge.

Local amenities include a highly regarded primary school, a supermarket, a village shop, pubs, and community facilities, all contributing to a vibrant and welcoming community atmosphere. Duxford is also home to the world-famous Imperial War Museum Duxford, adding a rich cultural and historical dimension to village life.

Entrance hall

WC

Lounge - 4.70m x 3.57m (15'5 x 11'9)

Kitchen / diner - 4.67m x 3.46m (15'4 x 11'4)

First floor

Bedroom one - 4.05m x 2.88m (13'3 x 9'5)

En-suite

Bedroom four - 3.30m x 2.73m (10'10 x 8'11)

Second floor

Bedroom two - 4.68m x 3.32m (15'4 x 10'11)

Bedroom three - 4.68m x 2.87m (15'4 x 9'5)

Bathroom

Garage - 5.34m x 2.58m (17'6 x 8'6)



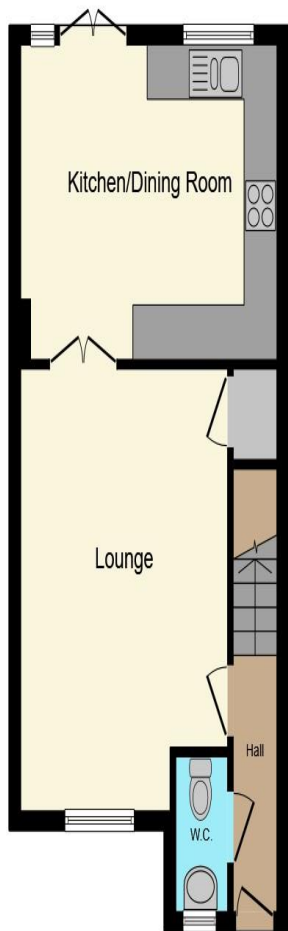

Ground Floor

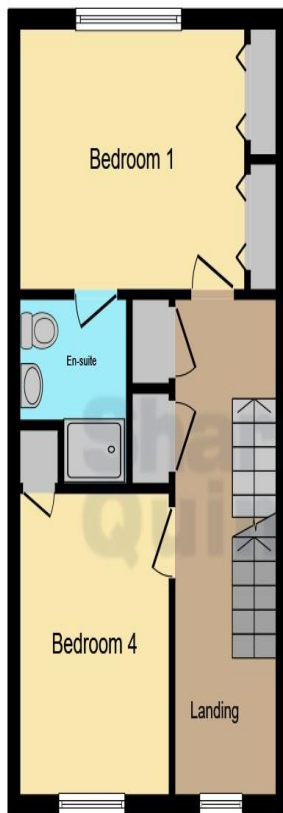

First Floor



Second Floor

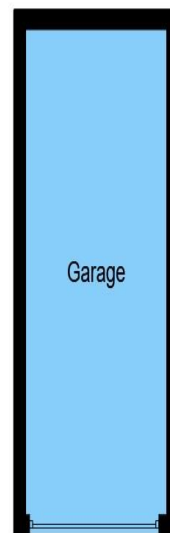

Garage

This floor plan is for illustrative purposes only. It is not drawn to scale. Any measurements, floor areas (including any total floor area), openings and orientation are approximate. No details are guaranteed, they cannot be relied upon for any purpose and they do not form part of any agreement. No liability is taken for any error, omission or misstatement. A party must rely upon its own inspection(s). Powered by www.focalagent.com

To view this property call Sharman Quinney on:
01223 844760

Selling your property?

Contact us to arrange a **FREE**
home valuation.

 01223 844760

 49 Woollards Lane, Great Shelford, CAMBRIDGE,
Cambridgeshire, CB22 5LZ

 greatshelford@sharmanquinney.co.uk

 www.sharmanquinney.co.uk



 SCAN ME



Sharman Quinney Holdings Limited is registered in England and Wales under company number 4174227, Registered Office is Cumbria House, 16-20 Hockliffe Street, Leighton Buzzard, Bedfordshire, LU7 1GN. VAT Registration Number is 500 2481 05.

1: These particulars do not constitute part or all of an offer or contract. 2: The measurements indicated are supplied for guidance only and as such must be considered incorrect. 3: Potential buyers are advised to recheck the measurements before committing to any expense. 4: Sharman Quinney has not tested any apparatus, equipment, fixtures, fittings or services and it is the buyers interests to check the working condition of any appliances. 5: Sharman Quinney has not sought to verify the legal title of the property and buyers must obtain verification from their legal representative. 6: Intending purchasers will be asked to produce identification documentation at a later stage and we would ask your co-operation in order that there will be no delay in agreeing the sale. Ref: GTS103024 - 0003

