



Park Road, Sawston Cambridge  
**£650,000** **Freehold**

**Sharman  
Quinney**



# Key Features

4 2 D E

- Vastly improved four bedroom family home
- Light and airy bay fronted living room
- Stylish open plan kitchen / diner with patio doors to garden
- Utility room plus downstairs WC
- Principal bedroom with en-suite



Situated in a quiet cul-de-sac in the ever-popular village of Sawston, this substantially improved and spacious four-bedroom family home offers modern living with exceptional versatility. With ample off-road parking and a generous plot, the property is ideal for growing families seeking both comfort and convenience.

The ground floor features a welcoming entrance hall leading into a light and airy bay-fronted living room - a perfect space for relaxing or entertaining. To the rear, a modern and stylish open-plan kitchen/diner creates the heart of the home, complete with patio doors that open onto the rear garden. A separate utility room and a convenient downstairs WC add practicality, while the double garage has been partly converted and is currently used as a home gym - offering excellent potential for a home office, playroom, or additional reception space.

Upstairs, a spacious U-shaped landing leads to four well-proportioned bedrooms. The principal bedroom benefits from its own en-suite shower room, while bedrooms two and three are generous doubles. The fourth bedroom, currently used as a study, is ideal for home working or as a nursery. A modern family bathroom completes the first floor.

Outside, the rear garden offers a tranquil escape - mainly laid to lawn and featuring two large decked seating areas, ideal for entertaining.





**Ground Floor**

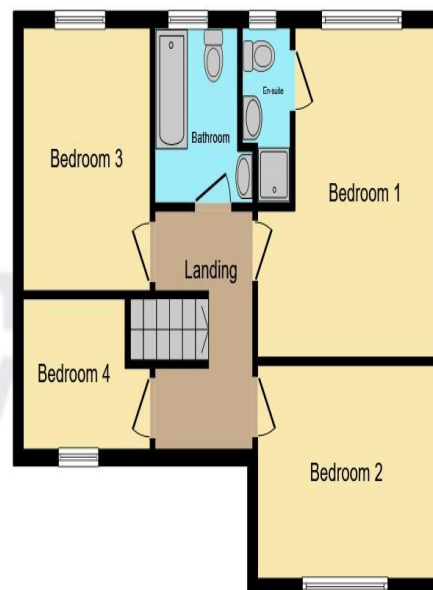

**First Floor**

Entrance hall

Living room - 6.40m x 3.30m (20'9 x 10'8)

Kitchen area - 2.83m x 2.70m (9'2 x 8'8)

Dining area - 2.83m x 2.10m (9'2 x 6'8)

Utility room - 1.45m x 2.48m (4'7 x 8'1)

First floor landing

Bedroom one - 4.26m x 3.08m (13'9 x 10'10)

En-suite

Bedroom two - 2.76m x 3.13m (9'0 x 10'2)

Bedroom three - 3.40m x 2.68m (11'5 x 8'7)

Bedroom four - 2.92m x 1.95m (9'5 x 6'3)

Garage - 6.20m x 5.11m (20' x 16'7)

This floor plan is for illustrative purposes only. It is not drawn to scale. Any measurements, floor areas (including any total floor area), openings and orientation are approximate. No details are guaranteed, they cannot be relied upon for any purpose and they do not form part of any agreement. No liability is taken for any error, omission or misstatement. A party must rely upon its own inspection(s). Powered by [www.focalagent.com](http://www.focalagent.com)

To view this property call Sharman Quinney on:  
**01223 844760**



# Selling your property?

Contact us to arrange a **FREE** home valuation.

 01223 844760

 49 Woollards Lane, Great Shelford, CAMBRIDGE,  
Cambridgeshire, CB22 5LZ

 greatshelford@sharmanquinney.co.uk

 [www.sharmanquinney.co.uk](http://www.sharmanquinney.co.uk)



 SCAN ME



Sharman Quinney Holdings Limited is registered in England and Wales under company number 4174227, Registered Office is Cumbria House, 16-20 Hockliffe Street, Leighton Buzzard, Bedfordshire, LU7 1GN. VAT Registration Number is 500 2481 05.

1: These particulars do not constitute part or all of an offer or contract. 2: The measurements indicated are supplied for guidance only and as such must be considered incorrect. 3: Potential buyers are advised to recheck the measurements before committing to any expense. 4: Sharman Quinney has not tested any apparatus, equipment, fixtures, fittings or services and it is the buyers interests to check the working condition of any appliances. 5: Sharman Quinney has not sought to verify the legal title of the property and buyers must obtain verification from their legal representative. 6: Intending purchasers will be asked to produce identification documentation at a later stage and we would ask your co-operation in order that there will be no delay in agreeing the sale. Ref: GTS102920 - 0003

