



High Street, Little Shelford CAMBRIDGE  
**£700,000 Freehold**

**Sharman  
Quinney**

# Key Features



- Grade II listed 17th Century thatched cottage
- Stunning kitchen / dining room with Inglenook fireplace and exposed beams
- Cosy sitting room with original features and second Inglenook fireplace
- Versatile ground floor double bedroom
- Useful study with access to rear garden
- Two first floor bedrooms with unique family bathroom and freestanding bath
- Generous rear garden with off road parking

The heart of the home is the eye-catching kitchen/dining room, showcasing stunning period details including an Inglenook fireplace and original exposed beams.



The cosy sitting room is equally charming, centred around another beautiful Inglenook fireplace, with beams adding warmth and character throughout. A useful study leads off the sitting room, with direct access to the rear garden - perfect for working from home or a quiet retreat. Also on the ground floor is a well-proportioned double bedroom, ideal for guests or multi-generational living.

Upstairs, you'll find two bedrooms - one accessed via the other - creating a flexible layout that could be ideal for families or a private suite. The generous bathroom is a real feature, boasting a unique design and a freestanding bath.

Set on a generous plot, the rear garden is mainly laid to lawn, offering a tranquil and private space to relax or entertain. To the front, a charming gravel pathway leads you through the garden to the welcoming entrance of the cottage. In addition, off road parking can be found to the rear of the property.



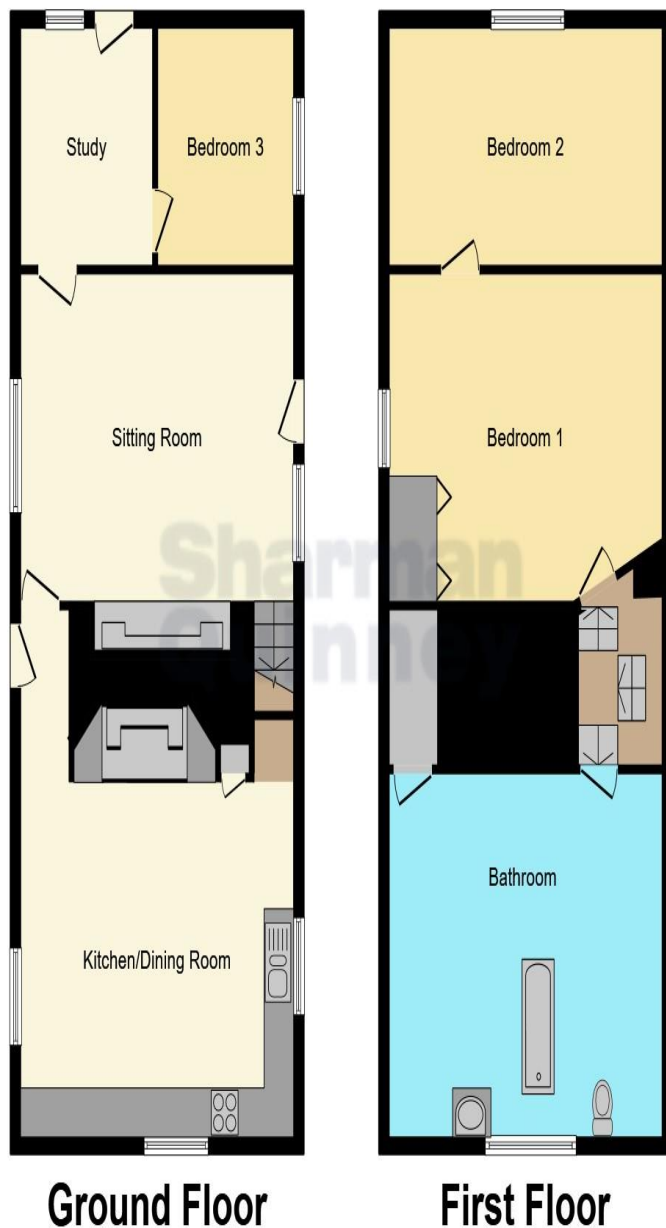

**Ground Floor**

**First Floor**

#### Entrance

Living room - 4.05m x 5.15m (13'3 x 16'11)

Kitchen / diner - 4.34m x 5.54, (14'3 x 18'2)

Study - 2.90m x 2.68m (9'6 x 8'9)

Bedroom three - 2.90m x 2.38m (9'6 x 7'10)

Bedroom one - 4.05m x 5.54m (13'3 x 18'2)

Bedroom two - 2.88m x 5.54m (9'6 x 18'2)

Bathroom - 4.47m x 5.54m (14'8 x 18'2)

This floor plan is for illustrative purposes only. It is not drawn to scale. Any measurements, floor areas (including any total floor area), openings and orientation are approximate. No details are guaranteed, they cannot be relied upon for any purpose and they do not form part of any agreement. No liability is taken for any error, omission or misstatement. A party must rely upon its own inspection(s). Powered by [www.focalagent.com](http://www.focalagent.com)

To view this property call Sharman Quinney on:  
**01223 844760**

# Selling your property?

Contact us to arrange a **FREE** home valuation.

 01223 844760

 49 Woollards Lane, Great Shelford, CAMBRIDGE,  
Cambridgeshire, CB22 5LZ

 greatshelford@sharmanquinney.co.uk

 [www.sharmanquinney.co.uk](http://www.sharmanquinney.co.uk)



 SCAN ME



Sharman Quinney Holdings Limited is registered in England and Wales under company number 4174227, Registered Office is Cumbria House, 16-20 Hockliffe Street, Leighton Buzzard, Bedfordshire, LU7 1GN. VAT Registration Number is 500 2481 05.

1: These particulars do not constitute part or all of an offer or contract. 2: The measurements indicated are supplied for guidance only and as such must be considered incorrect. 3: Potential buyers are advised to recheck the measurements before committing to any expense. 4: Sharman Quinney has not tested any apparatus, equipment, fixtures, fittings or services and it is the buyers interests to check the working condition of any appliances. 5: Sharman Quinney has not sought to verify the legal title of the property and buyers must obtain verification from their legal representative. 6: Intending purchasers will be asked to produce identification documentation at a later stage and we would ask your co-operation in order that there will be no delay in agreeing the sale. Ref: GTS102897 - 0002

