



Eastbury Avenue, Northwood HA6 3LN

Guide price £1,800 per month

Available Now: Part Furnished





Guide Price: £1,800 per month

Eastbury Avenue Northwood HA6 3LN

- Ground floor apartment in gate development
 - Spacious lounge with space for dining
 - Kitchen with appliances
 - Three good size double bedrooms
 - Master bedroom benefitting ensuite
 - Family bathroom
 - Ample storage
 - Private balconies and allocated parking
 - EPC Rating - C
-

Located in a superb position on Eastbury Avenue, this three double bedroom, two bathroom, ground floor apartment benefits beautifully maintained communal gardens, located a short walk from Northwood Station and the NATO Headquarters. This beautiful apartment is located on a gated development and comprises of entrance hallway with storage cupboards, spacious front facing lounge with separate space for dining, fitted kitchen with appliances, family bathroom and three good size double bedrooms with the master benefiting ensuite shower room. Externally there are beautifully maintained lush communal gardens which surround the block, allocated parking and private balconies. Clarendon Court is located a short walk to Northwood Town centre, for the commuter Baker Street, The City and Central London are all easily accessible due to the Metropolitan Line station. Another major factor in Northwood's popularity is the high standard of education available in the area from both state and highly regarded private schools such as Merchant Taylors for Boys and St Helens for Girls. Further Details Local Authority: Three Rivers District Council Council Tax: TBC





Clarendon Court, Eastbury Avenue, Northwood, HA6 3LN

Main house gross internal area = 1102 sq ft / 102.3 sq m

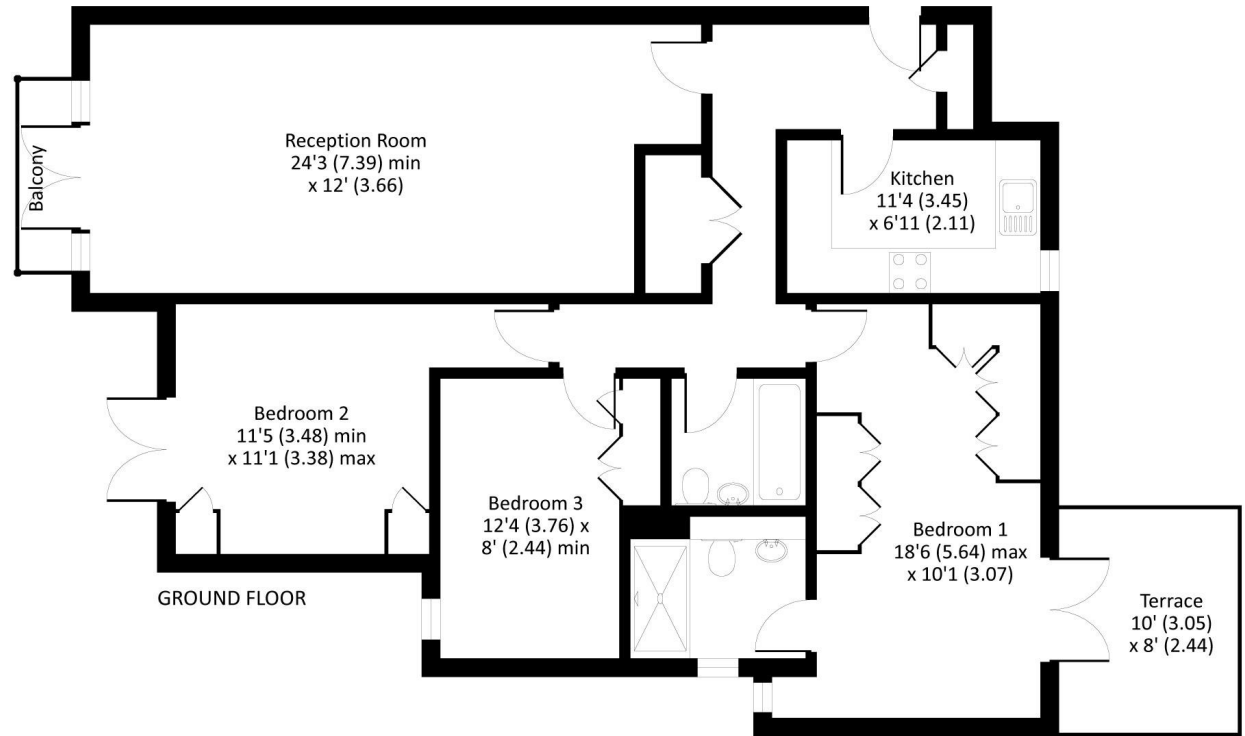

Whilst every attempt has been made to ensure the accuracy of the floor plan contained here, measurements of doors, windows and rooms are approximate and no responsibility is taken for any error, omission or misstatement. These plans are for representation purposes only as defined by RICS Code of Measuring Practice and should not be used as such by any prospective purchaser. Specifically no guarantee is given on the total square footage of the property if quoted on this plan. Any figure given is for initial guidance only and should not be relied on as a basis of valuation.
© 2018 nichecom.co.uk | Produced for Gibbs Gillespie | Drawing No 317251



Northwood Lettings

65C Green Lane
Northwood
London
HA6 3AD

T: 01923 824 444

northwoodlettings@gibbs-gillespie.co.uk

gibbs-gillespie.co.uk

Important Notice

We have prepared these property particulars as a general guide to a broad description of the property. They are not intended to constitute part of an offer or contract. We have not carried out a structural survey and the services, appliances and specific fittings have not been tested. All photographs, measurements, floorplans and distances referred to are given as a guide only and should not be relied upon for the purchase of carpets or any other fixtures and fittings. Lease details, service charges and ground rent (where applicable) and council tax are given as a guide only and should be checked and confirmed by your Solicitor prior to exchange of contracts. The copyright of all details, photographs and floorplans remain exclusive to Gibbs Gillespie.