

23 Moorside Dale, Ripon, HG4 2RY

£950PCM (Deposit: £1,096)

 3  1  1



Tax Band: C Furnished: Unfurnished

COMING SOON - MORE PHOTOS TO FOLLOW. An attractive linked semi-detached house located in a popular area on the south side of Ripon close to a nature reserve and convenient for a wide range of amenities. With modern features and neutral décor, the versatile accommodation includes a through sitting room with dining area, kitchen, three bedrooms and bathroom. Further benefits include gas central heating, double glazing, enclosed back garden, driveway and garage.

APPLICATION INFORMATION One weeks rent is payable to reserve a property which will then be deducted from the total rent and deposit requested. Properties will remain available until this is paid. On completing an application form on-line, you will need to provide identification (colour copy of passport, driver's licence and a utility bill). The completion and submission of an application form does not guarantee the offer of tenancy, this is subject to satisfactory references being obtained. A deposit equivalent to five weeks rent payable before the commencement of the Tenancy. The first month's rent and deposit must be paid before we will release the keys to the property. Applicants must show evidence of their contents insurance prior to the start of a tenancy. Payments can be made by bank transfer only. Personal cheques are not acceptable.

01765 608203

SOLO PROPERTY MANAGEMENT LTD
Visit our showroom at 13 Fishergate, Ripon, HG4 1EA

EMAIL
Info@solopm.com

www.solopropertymanagement.com



- COMING SOON
- Versatile Configuration
- Modern Kitchen
- Smart Bathroom
- Enclosed back Garden
- Linked Semi-Detached
- Sitting & Dining Room
- Three Bedrooms
- Drive & Garage
- Convenient Location

GROUND FLOOR
358 sq.ft. (33.3 sq.m.) approx.

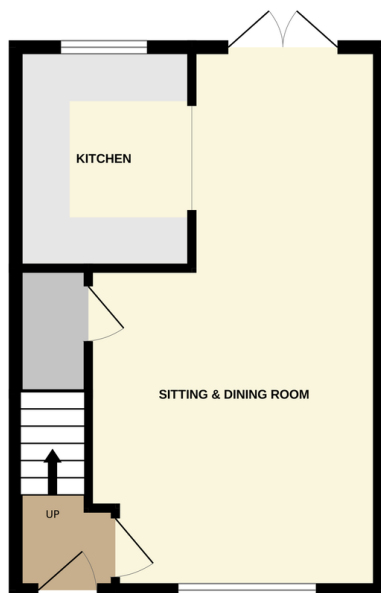

1ST FLOOR
358 sq.ft. (33.3 sq.m.) approx.

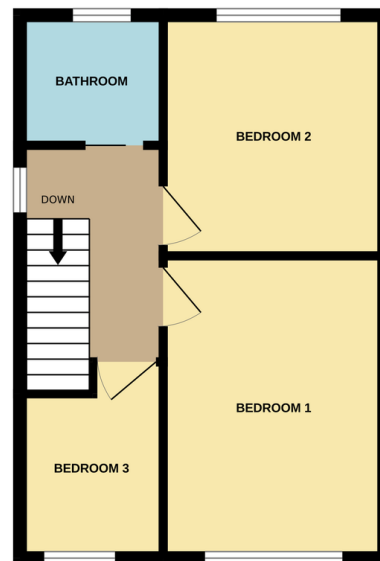

TOTAL FLOOR AREA: 716 sq.ft. (66.6 sq.m.) approx.

Whilst every attempt has been made to ensure the accuracy of the floorplan contained here, measurements of doors, windows, rooms and any other items are approximate and no responsibility is taken for any error, omission or mis-statement. This plan is for illustrative purposes only and should be used as such by any prospective purchaser. The services, systems and appliances shown have not been tested and no guarantee as to their operability or efficiency can be given.
Made with Metropix 6/2025

01765 608203

SOLO PROPERTY MANAGEMENT LTD
Visit our showroom at 13 Fishergate, Ripon, HG4 1EA

EMAIL
Info@solopm.com www.solopropertymanagement.com

