



16 ST. MICHAELS HILL,
BRISTOL, BS2 8DT

GOODMAN
& LILLEY







16 ST. MICHAELS HILL

BRISTOL BS2 8DT

GUIDE PRICE
£595,000

A superb period townhouse on St Michaels Hill in a great location, placed in easy reach of Bristol's bustling amenities, including shops, restaurants, the Bristol Royal Infirmary, university and cultural attractions. With five bedrooms, this property is perfect for investment or for those seeking a home just off of Bristol's centre.

Viewing is highly recommended to fully appreciate all that is on offer here. Call, Click or Come in to visit our experienced sales team.

Location

Ideally positioned for the Bristol University and Bristol Royal Infirmary and offering flexible accommodation, this attractive property will suit investors, student parents and owner occupiers who require a central location.

Entrance

From a front door directly into the living room.

Living Room

Spacious living area with front facing sash window and door to staircase with under stair storage.

Hallway

Stairs rising to the first floor doors back to the living room and on to the kitchen.

Kitchen / Breakfast Room

A modern fitted kitchen and worktops with rear facing UPVC double glazed window and door to rear garden. Space for table and door to a downstairs shower room.

Shower Room

Fitted modern suite comprising shower cubicle, wash basin and wc.

First Floor Landing

Stairs continuing to the floor above.

Bedroom One

Large double bedroom with two front facing sash windows.

Bedroom Two

L-shaped bedroom with rear facing sash window.

Bathroom

Modern bathroom with white suite.

Second Floor Landing

With skylight and doors to three further rooms.

Bedroom Three

Large double bedroom with a rear facing sash window.

Bedroom Four

Sash window to the front aspect.

Outside

Bedroom Five

Sash window to the front aspect.

Rear Courtyard Garden

Rear courtyard with access from the back and brick built outhouse.

Outhouse

There is a brick built outhouse in the rear courtyard with power and water.



- Located in the Center of Bristol
- Close to Bristol's Central Hospital / University / Business District
- Five Bedrooms
- Two Bathrooms
- Courtyard Garden
- Period Terrace House





GOODMAN
& LILLEY



Ground Floor

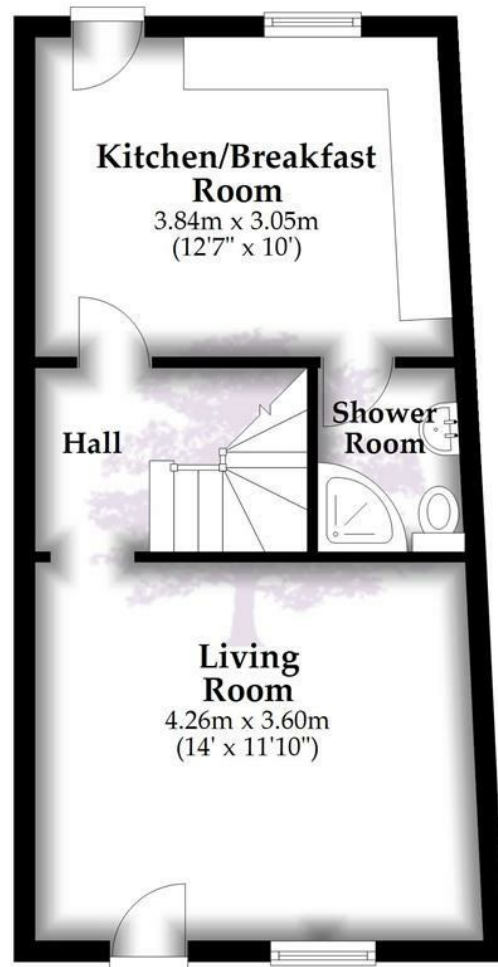

First Floor

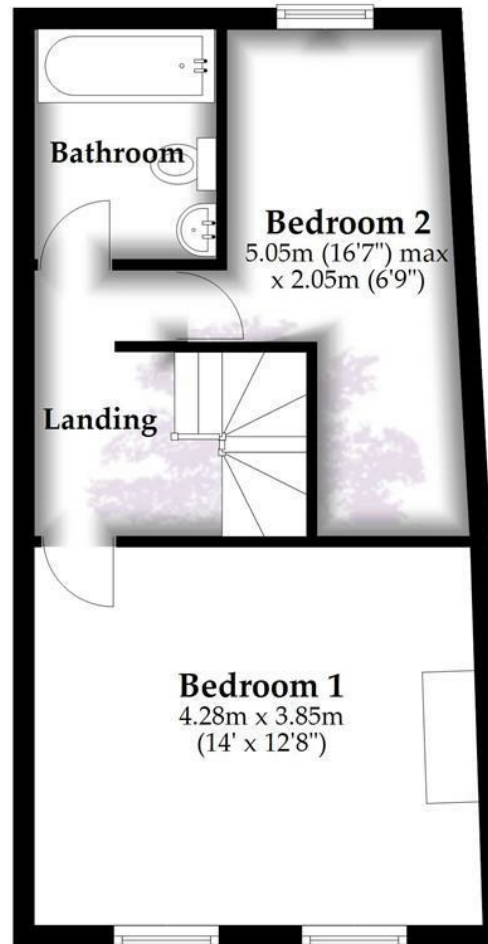

Second Floor

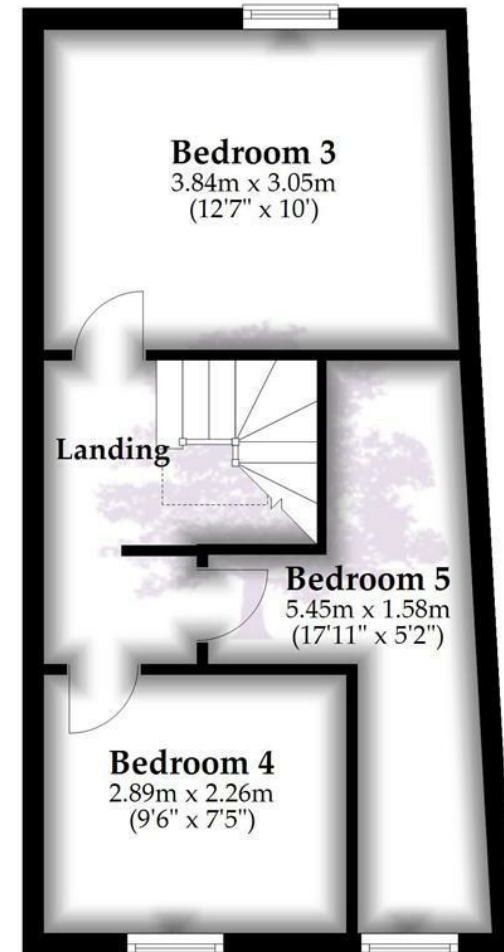

Total area: approx. 104.6 sq. metres (1125.7 sq. feet)

Whilst every attempt has been made to ensure accuracy of the floor plan all measurements are approximate and no responsibility is taken for any error, omission or measurement.

Plan produced using PlanUp.

HENLEAZE

156 Henleaze Road
Henleaze BS9 4NB
henleaze@goodmanlilley.co.uk

0117 213 0777

PORTISHEAD

36 High Street
Portishead BS20 6EN
sales@goodmanlilley.co.uk

01275 430 440

SHIREHAMPTON

9 High Street
Shirehampton BS11 0DT
shire@goodmanlilley.co.uk

0117 213 0333

LETTINGS

lettings@goodmanlilley.co.uk

01275 299 010

0117 213 0101

LAND & NEW HOMES

156 Henleaze Road
Henleaze BS9 4NB
LNH@goodmanlilley.co.uk

0117 213 0151



These particulars are for general guidance only. They do not form or constitute any part of an offer or contract. Goodman & Lilley has not carried out structural surveys of the property. The services, appliances or specific fittings mentioned in these details have not been tested. Every attempt is made to ensure accuracy, however all photographs, measurements, floor plans and distances are for illustrative purposes only. They must not be relied upon when purchasing carpets and or other fixtures & fittings. Lease details, service charges and ground rents are given as a guide only. They should be checked and confirmed by a licensed solicitor prior to exchange of contracts. The copyright of all details, photographs and floor plans remain exclusive to Goodman & Lilley.



rightmove

Zoopla